

Key: 1100

Town of Bourne - Fiscal Year 2024

12/18/2023 6:02 pm SEQ #: 1.108

LEGAL

LAND

DETACHED

BUILDING

| CURRENT OWNER | | | | PARCEL ID | | | | LOCATION | | | | |
|---|---|----------|------|--|-------------|-------------|------------------------------------|----------------|------|-----|------------|-----------|
| VICKERY EDWIN C & KATHLEEN M VICKERY 7 CHARTWELL DR BOURNE, MA 02532 | | | | 6.0-180-0 | | | | 7 CHARTWELL DR | | | | |
| TRANSFER HISTORY | | | | DOS | T | SALE PRICE | BK-PG (Cert) | | | | | |
| VICKERY EDWIN C & VICKERY EDWIN C VICKERY EDWIN C & | | | | 08/13/2020 12/03/2019 09/18/2017 | F F F | 1 1 1 | 33162-103 32512-142 30771-85 | | | | | |
| CD | T | AC/SF/UN | Nbhd | Inf1 | N Index | ADJ BASE | SAF | Topo | Lpi | VC | CREDIT AMT | ADJ VALUE |
| 100 | S | 18,449 3 | | 100 1.00 | 100 1.00 | 212,130 | 1.83 | A | 1.00 | R05 | 0.90 | 164,310 |

| TOTAL | 18,469 SF | ZONING | 2 | FRNT | 100 | ASSESSED | CURRENT | PREVIOUS |
|---------|-----------|--------|----------|---------|---------|--------------|----------------|----------------|
| Nbhd | BDALE | NOTE | | | | LAND | 164,300 | 161,600 |
| Inf1 | AVG | | BUILDING | 393,000 | 347,800 | | | |
| N_Index | AVG | | DETACHED | 16,800 | 15,300 | | | |
| | | | OTHER | 0 | 0 | | | |
| | | | | | | TOTAL | 574,100 | 524,700 |

| TY | QUAL | COND | DIM/NOTE | YB | UNITS | ADJ PRICE | RCNLD |
|-----|------|------|----------------------|----|-------|-----------|--------|
| IPG | A | 1.00 | 10 0.90 16 X 32 | | 512 | 29.72 | 13,700 |
| SHF | A | 1.00 | 10 0.90 8 X 8 | | | 0.00 | |
| SHF | A | 1.00 | 10 0.90 8 X 12 | | | 0.00 | |
| PDK | A | 1.00 | 50 0.50 7X20+5X36+5X | | 500 | 12.20 | 3,100 |



| BUILDING | CD | ADJ | DESC | MEASURE | 4/2/2018 | TL |
|----------|----|------|-------------------|---------|----------|----|
| MODEL | 1 | | RESIDENTIAL | LIST | 4/2/2018 | TL |
| STYLE | 5 | 1.00 | COLONIAL [100%] | REVIEW | 4/2/2018 | TL |
| QUALITY | + | 1.05 | AVERAGE + [100%] | | | |
| FRAME | 1 | 1.00 | WOOD FRAME [100%] | | | |

| YEAR BLT | 1994 | SIZE ADJ | 1.005 | ELEMENT | CD | DESCRIPTION | ADJ | S | BAT | T | DESCRIPTION | UNITS | YB | ADJ PRICE | RCN |
|------------|-------|------------|-------|-----------------|----|----------------|------|-----|-----|---------------|-----------------|-------|----------|-----------|---------|
| NET AREA | 2,062 | DETAIL ADJ | 1.000 | FOUNDATION | 4 | FLR/WALL(FULL) | 1.00 | + | BAS | L | BASE AREA | 1,152 | 1994 | 214.73 | 247,365 |
| \$NLA(RCN) | \$232 | OVERALL | 1.060 | EXT COVER | 1 | WOOD SHINGLE | 1.02 | B | BMU | N | BSMT UNFINISHED | 896 | | 40.79 | 36,547 |
| | | | | ROOF SHAPE | 1 | GABLE | 1.00 | B | BMF | N | BSMT FINISH | 896 | | 38.82 | 34,786 |
| | | | | ROOF COVER | 1 | ASPH/COMP SHIN | 1.00 | B | USF | L | UPPER STORY FIN | 896 | 1994 | 120.41 | 107,891 |
| | | | | FLOOR COVER | 1 | HARDWOOD | 1.02 | C | OPA | N | OPEN PORCH | 128 | | 76.74 | 9,823 |
| | | | | INT. FINISH | 2 | DRYWALL | 1.00 | D | OVH | L | OVERHANG | 14 | 1994 | 202.54 | 2,836 |
| | | | | HEATING/COOLING | 2 | HOT WATER | 1.02 | E | EPA | N | ENCLOSED PORCH | 204 | | 72.97 | 14,886 |
| | | | | FUEL SOURCE | 2 | GAS | 1.00 | + | WDK | N | WOOD DECK | 48 | | 70.91 | 3,404 |
| | | | | USE | 0 | | 1.00 | F21 | O | FPL 2S 1OP | 1 | | 9,853.40 | 9,853 | |
| | | | | | | | | FIX | O | XTRA FIXTURES | 5 | | 2,382.10 | 11,911 | |

| CLASS | CLASS% | DESCRIPTION | | BN ID | BN | CARD | | |
|------------|------------|---------------|-----------|--------|------------|--------|-----|-----|
| 1010 | 100 | SINGLE FAMILY | | | 1 | 1 of 1 | | |
| PMT NO | PMT DT | TY | DESC | AMOUNT | INSP | BY | 1st | % |
| EXB-21-103 | 02/20/2021 | 3 | ALT/RENO | 18,434 | | | | 100 |
| EXB-20-292 | 09/21/2020 | 14 | SOLAR | 24,000 | | | | 100 |
| 05741 | 10/24/2005 | 10 | WOODSTOVE | | 05/01/2006 | TL | | 100 |
| 04024 | 01/20/2004 | 9 | DECK | 23,000 | 06/30/2004 | JS | | 100 |
| 02676 | 10/08/2002 | 2 | ADDITIONS | 15,000 | 05/06/2003 | TL | | 100 |

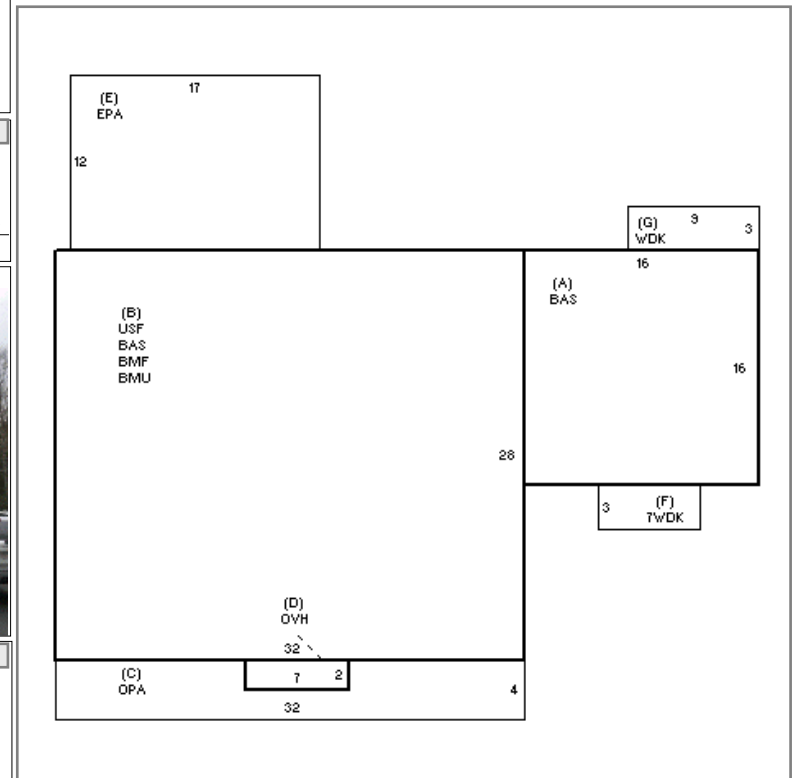

| BLDG COMMENTS |
|---------------|
| |

| TOTAL RCN | 479,302 |
|----------------|------------|
| CONDITION ELEM | CD |
| EXTERIOR | A |
| INTERIOR | A |
| KITCHEN | G |
| BATHS | A |
| HEAT | A |
| ELECT | A |
| EFF.YR/AGE | 2001 / 21 |
| COND | 18 18 % |
| FUNC | 0 |
| ECON | 0 |
| DEPR | 18 % GD 82 |
| RCNLD | \$393,000 |