

Key: 1865

Town of Bourne - Fiscal Year 2024

12/18/2023 6:02 pm SEQ #: 1.885

LEGALS

CURRENT OWNER						PARCEL ID			LOCATION			
GEORGE JOHN E TR BOURNE INVESTMENT REALTY TRUST c/o MPM PO BOX 790 BUZZARDS BAY, MA 02532						11.0-31-23			25-D5 CANAL ST			
TRANSFER HISTORY						DOS	T	SALE PRICE	BK-PG (Cert)			
GEORGE JOHN E TR						12/01/2011	G	615,000	25885-13			
GARLAND AMY T TR OF FAITH						12/01/2011	N		25884-325			
GARLAND AMY T TR OF FAITH						02/16/2010	F		24370-291			

CLASS	CLASS%	DESCRIPTION				BN ID	BN	CARD	
1020	100	CONDOMINIUM					1	1 of 1	
PMT NO	PMT DT	TY	DESC	AMOUNT	INSP	BY	1st	%	

LAND

CD	T	AC/SF/UN	Nbhd	Infl1	N Index	ADJ BASE	SAF	Topo	Lpi	VC	CREDIT AMT	ADJ VALUE

TOTAL	1.612 Acres	ZONING	1	FRNT	0	ASSESSED	CURRENT	PREVIOUS
Nbhd		NOTE		LAND		0	0	
Infl1			BUILDING	241,800	216,400			
N_Index			DETACHED	0	0			
			OTHER	0	0			
				TOTAL		241,800	216,400	

DETACHED

TY	QUAL	COND	DIM/NOTE	YB	UNITS	ADJ PRICE	RCNLD

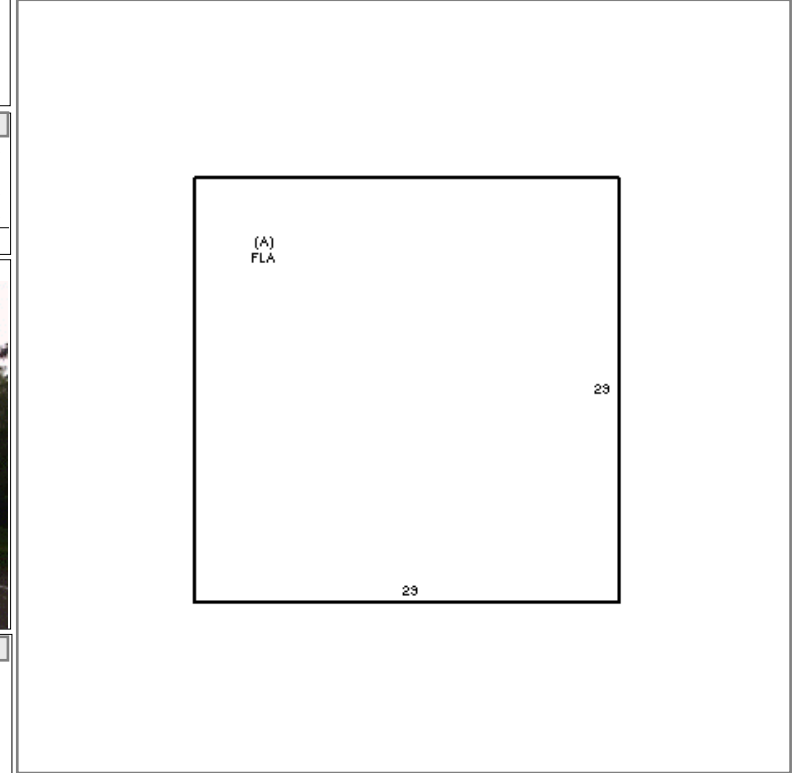

BUILDING

BUILDING	CD	ADJ	DESC	MEASURE	6/19/2019	RP
MODEL	10		RES CONDO	LIST	6/19/2019	EST
STYLE	8	1.00	CONV APTS [100%]	REVIEW		
QUALITY	A	1.00	AVERAGE [100%]			
FRAME	1	1.00	WOOD FRAME [100%]			

BLDG COMMENTS

LOADING

YEAR BLT	1969	SIZE ADJ	1.000	ELEMENT	CD	DESCRIPTION	ADJ	S	BAT	T	DESCRIPTION	UNITS	YB	ADJ PRICE	RCN	TOTAL RCN	287,804
NET AREA	841	DETAIL ADJ	1.000	COMPLEX	9	HUNTERS BROOK 1	1.05	A	FLA	L	LIVING AREA	841	1969	342.22	287,804	CONDITION ELEM	CD
\$NLA(RCN)	\$342	OVERALL	1.500	OCCUPANCY	1	YEAR ROUND	1.00									INTERIOR	A
CAPACITY		UNITS	ADJ	FLOOR/LOC	2	MIDDLE FLOOR	0.90									KITCHEN	A
ROOMS	4	1.00		VIEW INFL	8	AVG WT VIEW	1.55									BATHS	A
BEDROOMS	2	1.00		HT/CL	2	HOT WATER	1.00									EXTERIOR	A
BATHROOMS	1	1.00		WDK/PTA/BALC	2	NOT PRESENT	1.00										
HALFBATHS	0	1.00		PARKING	1	OUTDOOR 1 SPACE	1.00										
FIREPLACES	0	1.00		NET ADJ(%GOOD)	100	100 %RG	1.00										
																EFF.YR/AGE	1971 / 51
																COND	16 16 %
																FUNC	0
																ECON	0
																DEPR	16 % GD 84
																RCNLD	\$241,800