

Key: 2119

Town of Bourne - Fiscal Year 2024

12/18/2023 6:02 pm SEQ #: 2.130

LEGAL

LAND

DETACHED

BUILDING

CURRENT OWNER		PARCEL ID		LOCATION	
CARR DABNEY 60 HUNTERS BROOK RD SAGAMORE BEACH, MA 02562-2410		12.1-35-0		60 HUNTERS BROOK RD	
TRANSFER HISTORY		DOS	T	SALE PRICE	BK-PG (Cert)
CARR DABNEY		09/10/1997	N	34,000	10944-85

CLASS	CLASS%	DESCRIPTION		BN ID	BN	CARD	
1010	100	SINGLE FAMILY			1	1 of 1	
PMT NO	PMT DT	TY	DESC	AMOUNT	INSP	BY	1st %
19350	04/29/2019	3	ALT/RENO	50,000	05/18/2020	RP	100 100
15524	07/01/2015	10	WOODSTOVE		05/18/2020	RP	100 100
200673	10/13/2000	3	ALT/RENO	1,000			100 100
970486	10/06/1997	3	ALT/RENO	1,000	04/21/1998	JS	100 100

CD	T	AC/SF/UN	Nbhd	Infl1	N Index	ADJ BASE	SAF	Topo	Lpi	VC	CREDIT AMT	ADJ VALUE	
100	S	7,680 1	1.00	100	1.00	100	1.00	235,700	3.99	A	1.00	R03 1.00	165,680

TOTAL	7,667 SF	ZONING	1	FRNT	60	ASSESSED	CURRENT	PREVIOUS
Nbhd	N SAG	NOTE	LAND	165,700	146,600			
Infl1	AVG		BUILDING	291,500	257,900			
N_Index	AVG		DETACHED	0	0			
			OTHER	0	0			
			<b>TOTAL</b>	<b>457,200</b>	<b>404,500</b>			

TY	QUAL	COND	DIM/NOTE	YB	UNITS	ADJ PRICE	RCNLD
SHF	L	0.90 80 0.20	8 X 8			0.00	



BUILDING	CD	ADJ	DESC	MEASURE	7/19/2021	NMP
MODEL	1		RESIDENTIAL	LIST	5/22/2020	EST
STYLE	5	1.00	COLONIAL [100%]	REVIEW	8/5/2020	RP
QUALITY	A	1.00	AVERAGE [100%]			
FRAME	1	1.00	WOOD FRAME [100%]			

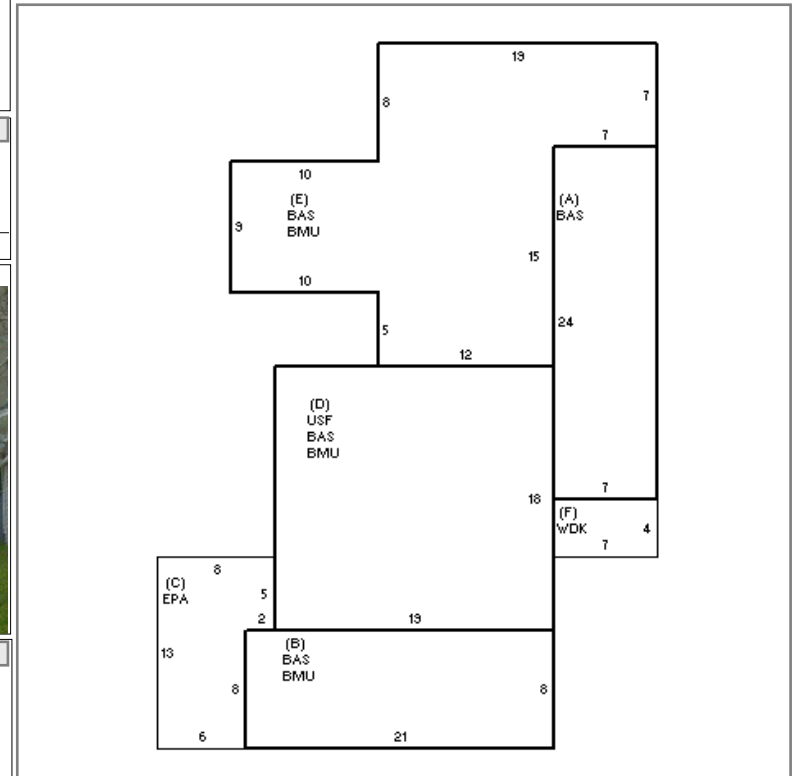

YEAR BLT	1920	SIZE ADJ	1.015
NET AREA	1,423	DETAIL ADJ	1.000
\$NLA(RCN)	\$218	OVERALL	1.040

CAPACITY	UNITS	ADJ
STORIES	1	1.00
ROOMS	5	1.00
BEDROOMS	3	1.00
BATHROOMS	2	1.00
FIXTURES	5	1.00
GARAGE CAPACITY	0	1.00
% BSMT FINISH	0	1.00
# OF HALF BATHS	0	1.00
# OF UNITS	1	1.00

ELEMENT	CD	DESCRIPTION	ADJ
FOUNDATION	4	FLR/WALL(FULL)	1.00
EXT COVER	1	WOOD SHINGLE	1.02
ROOF SHAPE	1	GABLE	1.00
ROOF COVER	1	ASPH/COMP SHIN	1.00
FLOOR COVER	2	SOFTWOOD	1.02
INT. FINISH	2	DRYWALL	1.00
HEATING/COOLING	1	FORCED AIR	1.00
FUEL SOURCE	1	OIL	1.00
USE	0		1.00

S	BAT	T	DESCRIPTION	UNITS	YB	ADJ PRICE	RCN
+	BAS	L	BASE AREA	1,081	1920	202.64	219,053
+	BMU	N	BSMT UNFINISHED	913		38.49	35,143
C	EPA	N	ENCLOSED PORCH	88		85.97	7,566
D	USF	L	UPPER STORY FIN	342	2019	116.15	39,723
F	WDK	N	WOOD DECK	28		66.92	1,874
	FIX	O	XTRA FIXTURES	3		2,248.07	6,744

TOTAL RCN	310,103
CONDITION ELEM	CD
EXTERIOR	A
INTERIOR	A
KITCHEN	G
BATHS	G
HEAT	U
ELECT	U

EFF.YR/AGE	2013 / 9
COND	6 6 %
FUNC	0
ECON	0
DEPR	6 % GD 94

RCNLD	\$291,500
-------	-----------