

Key: 2831

Town of Bourne - Fiscal Year 2024

12/18/2023 6:02 pm SEQ #: 2.868

LEGALS LAND

Table with columns: CURRENT OWNER, PARCEL ID, LOCATION, TRANSFER HISTORY, DOS, T, SALE PRICE, BK-PG (Cert). Includes owner info for MAY DONALD A ETUX and CAROLE R MAY.

Table with columns: CLASS, CLASS%, DESCRIPTION, BN ID, BN, CARD. Includes payment history with PMT NO, PMT DT, TY, DESC, AMOUNT, INSP, BY, 1st, %.

Table with columns: CD, T, AC/SF/UN, Nbhd, Infil1, N Index, ADJ BASE, SAF, Topo, Lpi, VC, CREDIT AMT, ADJ VALUE.

Table with columns: TOTAL, 1.440 Acres, ZONING, FRNT, ASSESSED, CURRENT, PREVIOUS. Includes zoning details and assessed values.

Table with columns: TY, QUAL, COND, DIM/NOTE, YB, UNITS, ADJ PRICE, RCNLD. Includes property characteristics and unit details.

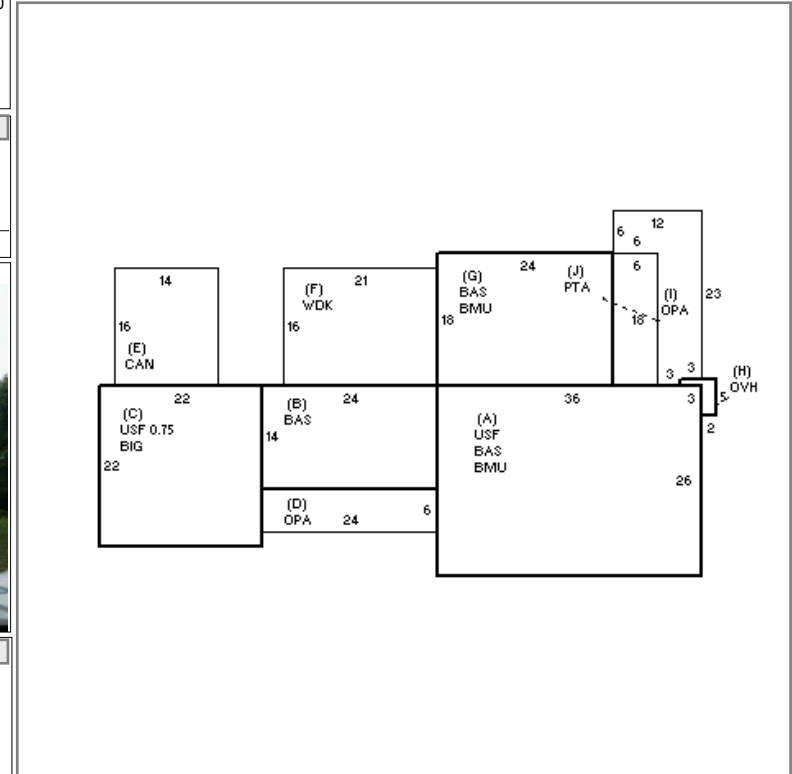

Table with columns: BUILDING, CD, ADJ, DESC, MEASURE, 7/21/2022, SL, LIST, 7/21/2022, EST, REVIEW, 8/3/2022, TL.

BLDG COMMENTS

DETACHED

BUILDING

Large summary table with columns: YEAR BLT, SIZE ADJ, ELEMENT, CD, DESCRIPTION, ADJ, S, BAT, T, DESCRIPTION, UNITS, YB, ADJ PRICE, RCN, TOTAL RCN, CONDITION ELEM, CD. Includes building details, capacity, and RCN breakdown.