

Key: 3489

Town of Bourne - Fiscal Year 2024

12/18/2023 6:02 pm SEQ #: 3.531

LEGALS

Table with columns: CURRENT OWNER, PARCEL ID, LOCATION, TRANSFER HISTORY, DOS, T, SALE PRICE, BK-PG (Cert). Includes owner info for OSTROSKY STEVEN & JUDITH A OSTROSKY and transfer history from 11/13/2020 to 11/10/2010.

Table with columns: CLASS, CLASS%, DESCRIPTION, BN ID, BN, CARD. Includes a table for SINGLE FAMILY with columns: PMT NO, PMT DT, TY, DESC, AMOUNT, INSP, BY, 1st, %.

LAND

Table with columns: CD, T, AC/SF/UN, Nbhd, Infl1, N Index, ADJ BASE, SAF, Topo, Lpi, VC, CREDIT AMT, ADJ VALUE. Includes a summary table for ASSESSED, CURRENT, and PREVIOUS values.

Table with columns: TY, QUAL, COND, DIM/NOTE, YB, UNITS, ADJ PRICE, RCNLD. Includes a photo of the property dated 01/05/2022.

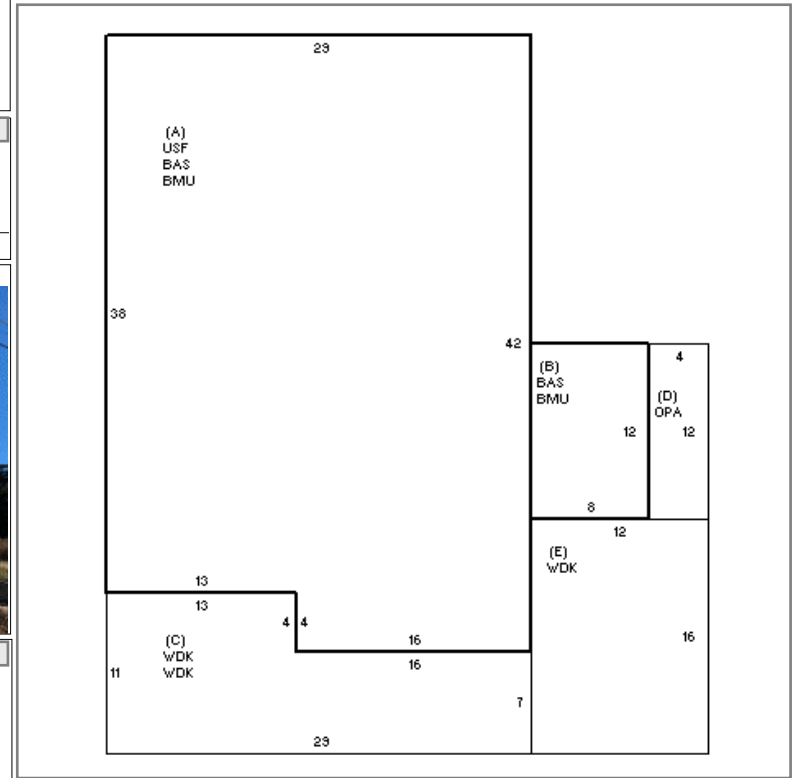

DETACHED

Table with columns: BUILDING, CD, ADJ, DESC, MEASURE, 6/30/2021, TL. Includes a table for BLDG COMMENTS.

BUILDING

Table with columns: YEAR BLT, SIZE ADJ, UNITS, ADJ, ELEMENT, CD, DESCRIPTION, ADJ, S, BAT, T, DESCRIPTION, UNITS, YB, ADJ PRICE, RCN, TOTAL RCN, CONDITION ELEM, CD. Includes a table for CAPACITY and a table for EFF. YR/AGE.