

Key: 3854

Town of Bourne - Fiscal Year 2024

12/18/2023 6:02 pm SEQ #: 3.904

LEGALS

LAND

DETACHED

BUILDING

| CURRENT OWNER | | PARCEL ID | LOCATION | | | |
|--|--|------------|------------|------------------|--------------|--|
| SOUZA ROBERT & MARIE M TRS SOUZA FAMILY IRREV TRUST 7 MAPLE ST BUZZARDS BAY, MA 02532 | | 19.4-236-0 | 7 MAPLE ST | | | |
| TRANSFER HISTORY | | DOS | T | SALE PRICE | BK-PG (Cert) | |
| SOUZA ROBERT & MARIE M TR | | 07/13/2017 | F | 1 (213486) | | |
| SOUZA MARIE M & | | 07/22/1986 | XX | 106,000 (107337) | | |

| CLASS | CLASS% | DESCRIPTION | | BN ID | BN | CARD | |
|------------|------------|---------------|-----------|--------|------------|--------|---------|
| 1010 | 100 | SINGLE FAMILY | | | 1 | 1 of 1 | |
| PMT NO | PMT DT | TY | DESC | AMOUNT | INSP | BY | 1st % |
| EXB-23-171 | 03/29/2023 | 3 | ALT/RENO | 10,650 | | | 100 100 |
| 17015 | 01/09/2017 | 3 | ALT/RENO | 16,000 | 03/23/2018 | BC | 100 100 |
| 920554 | 10/27/1992 | 2 | ADDITIONS | 9,500 | 03/08/1993 | JS | 100 100 |

| CD | T | AC/SF/UN | Nbhd | Infl1 | N Index | ADJ BASE | SAF | Topo | Lpi | VC | CREDIT AMT | ADJ VALUE | |
|-----|---|----------|------|-------|---------|----------|------|---------|------|----|------------|-----------|---------|
| 100 | S | 8,690 4 | 1.00 | 100 | 1.00 | 100 | 1.00 | 235,700 | 3.56 | A | 1.00 | R03 1.00 | 167,260 |

| TOTAL | 8,668 SF | ZONING | 1 | FRNT | 101 | ASSESSED | CURRENT | PREVIOUS |
|---------|----------|--------|--------------|----------------|----------------|----------|---------|----------|
| Nbhd | BBAY | NOTE | LAND | 167,300 | 148,000 | | | |
| Infl1 | AVG | | BUILDING | 249,500 | 220,800 | | | |
| N_Index | AVG | | DETACHED | 0 | 0 | | | |
| | | | OTHER | 0 | 0 | | | |
| | | | TOTAL | 416,800 | 368,800 | | | |

| TY | QUAL | COND | DIM/NOTE | YB | UNITS | ADJ PRICE | RCNLD |
|----|------|------|----------|----|-------|-----------|-------|
| | | | | | | | |



| BLDG COMMENTS |
|---------------|
| |

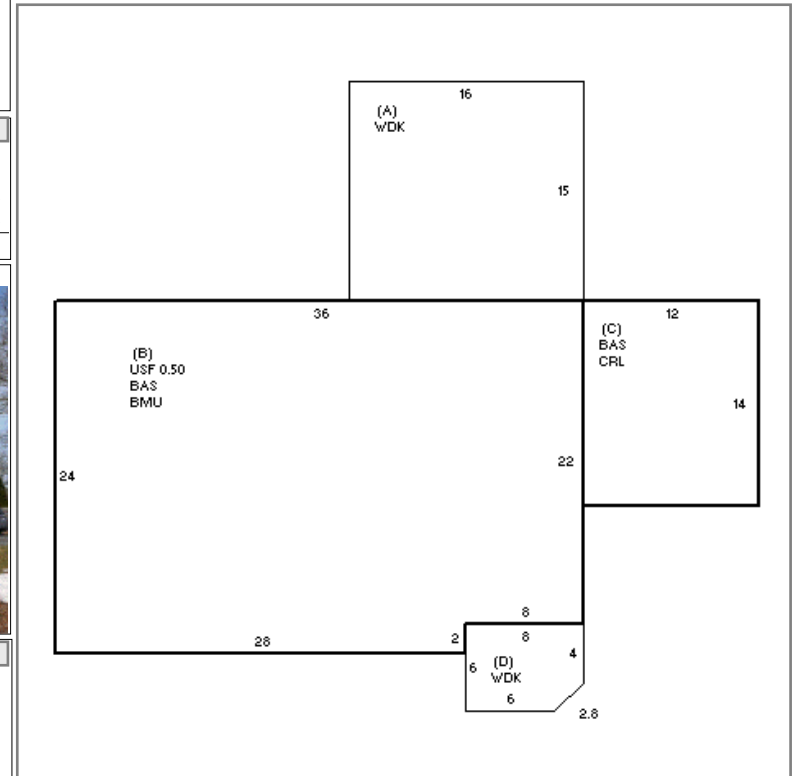

| BUILDING | CD | ADJ | DESC | MEASURE | 3/23/2018 | TL |
|----------|----|------|-------------------|---------|-----------|-----|
| MODEL | 1 | | RESIDENTIAL | LIST | 3/23/2018 | EST |
| STYLE | 4 | 1.05 | CAPE [100%] | REVIEW | | |
| QUALITY | A | 1.00 | AVERAGE [100%] | | | |
| FRAME | 1 | 1.00 | WOOD FRAME [100%] | | | |

| YEAR BLT | 1947 | SIZE ADJ | 1.015 |
|-----------------|-------|------------|-------|
| NET AREA | 1,440 | DETAIL ADJ | 1.000 |
| \$NLA(RCN) | \$222 | OVERALL | 1.070 |
| CAPACITY | | UNITS | ADJ |
| STORIES | | 1.5 | 1.00 |
| ROOMS | | 7 | 1.00 |
| BEDROOMS | | 3 | 1.00 |
| BATHROOMS | | 1 | 1.00 |
| FIXTURES | | 5 | 1.00 |
| GARAGE CAPACITY | | 0 | 1.00 |
| % BSMT FINISH | | 0 | 1.00 |
| # OF HALF BATHS | | 0 | 1.00 |
| # OF UNITS | | 1 | 1.00 |

| ELEMENT | CD | DESCRIPTION | ADJ |
|-----------------|----|----------------|------|
| FOUNDATION | 4 | FLR/WALL(FULL) | 1.00 |
| EXT COVER | 4 | VINYL | 1.00 |
| ROOF SHAPE | 1 | GABLE | 1.00 |
| ROOF COVER | 1 | ASPH/COMP SHIN | 1.00 |
| FLOOR COVER | 13 | HARDWOOD-W/W | 1.00 |
| INT. FINISH | 2 | DRYWALL | 1.00 |
| HEATING/COOLING | 2 | HOT WATER | 1.02 |
| FUEL SOURCE | 2 | GAS | 1.00 |
| USE | 0 | | 1.00 |

| S | BAT | T | DESCRIPTION | UNITS | YB | ADJ PRICE | RCN |
|---|-----|---|-----------------|-------|------|-----------|---------|
| + | WDK | N | WOOD DECK | 286 | | 28.13 | 8,044 |
| B | BMU | N | BSMT UNFINISHED | 848 | | 39.60 | 33,583 |
| B | BAS | L | BASE AREA | 848 | 1947 | 208.48 | 176,795 |
| B | USF | L | UPPER STORY FIN | 424 | 1947 | 119.50 | 50,669 |
| C | CRL | N | BSMT CRAWL | 168 | | 37.20 | 6,250 |
| C | BAS | L | BASE AREA | 168 | 1993 | 208.48 | 35,025 |
| | F21 | O | FPL 2S 1OP | 1 | | 9,567.00 | 9,567 |

| TOTAL RCN | 319,933 |
|----------------|------------|
| CONDITION ELEM | CD |
| EXTERIOR | A |
| INTERIOR | A |
| KITCHEN | A |
| BATHS | G |
| HEAT | A |
| ELECT | A |
| EFF.YR/AGE | 1997 / 25 |
| COND | 22 22 % |
| FUNC | 0 |
| ECON | 0 |
| DEPR | 22 % GD 78 |
| RCNLD | \$249,500 |