

Key: 5075

Town of Bourne - Fiscal Year 2024

12/18/2023 6:02 pm SEQ #: 5.210

LEGAL

CURRENT OWNER		PARCEL ID	LOCATION			
FRAHER LOUISE F 36 SHIPS WAY BOURNE, MA 02532		24.3-7-36	36 SHIPS WAY			
TRANSFER HISTORY		DOS	T	SALE PRICE	BK-PG (Cert)	
FRAHER LOUISE F		04/17/2019	QS	356,000	(C14-36)	
MEDEIROS MARY ANN TRS		07/02/2018	F	1	(dd/n)	
BERRY CINDERELLA & JAMES		05/11/2011	F	1	(C14-36)	

CLASS	CLASS%	DESCRIPTION		BN ID	BN	CARD			
1020	100	CONDOMINIUM			1	1 of 1			
PMT NO	PMT DT	TY	DESC	AMOUNT	INSP	BY	1st	%	
B-23-347	11/30/2023	3	ALT/RENO	74,822				0	0
		12	CYCLICAL		09/25/2018			100	100
17670	08/23/2017	3	ALT/RENO	150				100	100

LAND

CD	T	AC/SF/UN	Nbhd	Infl1	N Index	ADJ BASE	SAF	Topo	Lpi	VC	CREDIT AMT	ADJ VALUE

TOTAL	6.030 Acres	ZONING	FRNT	0	ASSESSED	CURRENT	PREVIOUS
Nbhd		NOTE	per mls canal views	LAND	0	0	
Infl1				BUILDING	434,500	451,300	
N_Index				DETACHED	0	0	
				OTHER	0	0	
				TOTAL	434,500	451,300	

DETACHED

TY	QUAL	COND	DIM/NOTE	YB	UNITS	ADJ PRICE	RCNLD	PHOTO
								06/17/2019



BLDG COMMENTS

BUILDING

BUILDING	CD	ADJ	DESC	MEASURE	6/17/2019	RP
MODEL	10		RES CONDO	LIST	6/17/2019	EST
STYLE	3	1.50	FLAT [100%]	REVIEW	6/17/2020	RP
QUALITY	A	1.00	AVERAGE [100%]			
FRAME	1	1.00	WOOD FRAME [100%]			

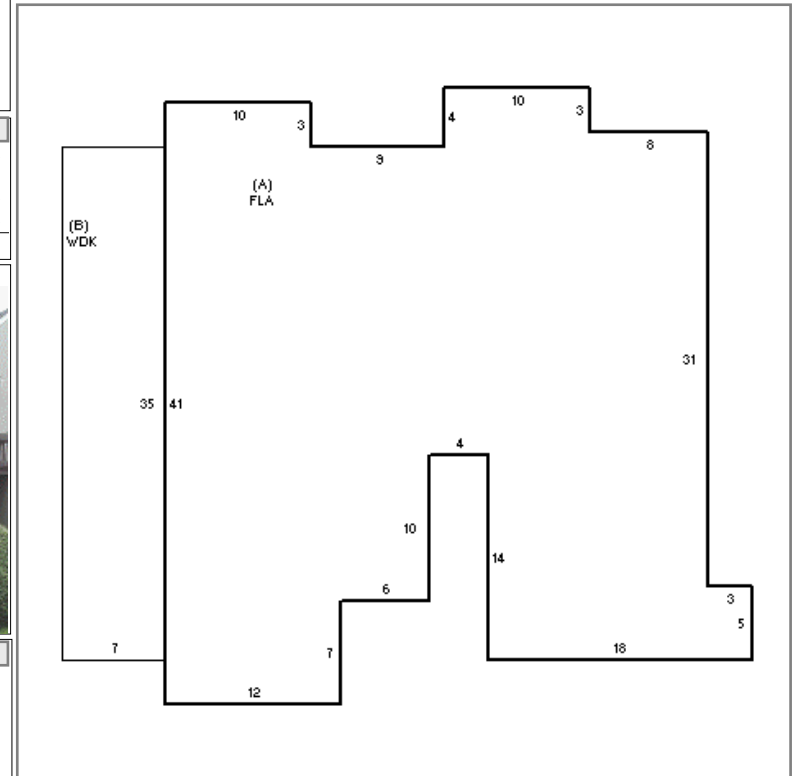

YEAR BLT	1974	SIZE ADJ	1.000
NET AREA	1,344	DETAIL ADJ	1.000
\$NLA(RCN)	\$372	OVERALL	1.600
CAPACITY		UNITS	ADJ
ROOMS	5	1.00	
BEDROOMS	2	1.00	
BATHROOMS	2	1.00	
HALFBATHS	0	1.00	
FIREPLACES	2	1.00	

ELEMENT	CD	DESCRIPTION	ADJ
COMPLEX	8	NEW APUCXET 1	0.65
OCCUPANCY	1	YEAR ROUND	1.00
FLOOR/LOC	1	FIRST FLOOR	1.00
VIEW INFL	29	NEW AP-AVG VW	1.45
HT/CL	9	WARM/COOL AIR	1.00
WDK/PTA/BALC	1	PRESENT	1.00
PARKING	1	OUTDOOR 1 SPACE	1.00
NET ADJ(%GOOD)	100	100 %RG	1.00

S	BAT	T	DESCRIPTION	UNITS	YB	ADJ PRICE	RCN
A	FLA	L	LIVING AREA	1,344	1974	338.69	455,197
B	WDK	N	WOODDECK	245		28.80	7,056
	BMU	N	BSMT UNF	658		20.96	13,792
	F12	O	FPL 1ST ZOP	2		11,676.80	23,354

TOTAL RCN	499,398
CONDITION ELEM	CD
INTERIOR	G
KITCHEN	A
BATHS	A
EXTERIOR	A
EFF.YR/AGE	1980 / 42
COND	13 13%
FUNC	0
ECON	0
DEPR	13 % GD 87
RCNLD	\$434,500