

Key: 5236

Town of Bourne - Fiscal Year 2024

12/18/2023 6:02 pm SEQ #: 5.379

LEGAL

LAND

DETACHED

BUILDING

CURRENT OWNER				PARCEL ID				LOCATION				
GUERRIERI MICHAEL A & VICTORIA T GUERRIERI 11 ANNE LANE BOURNE, MA 02532-3752				26.0-27-0				11 ANNE LN				
TRANSFER HISTORY				DOS	T	SALE PRICE	BK-PG (Cert)					
GUERRIERI MICHAEL A & SEASSIDE ASSOC. INC				09/28/1990	QS	219,900	7305-350					
				09/28/1990	B	65,000	N/A-N/A					

CLASS	CLASS%	DESCRIPTION			BN ID	BN	CARD	
1010	100	SINGLE FAMILY				1	1 of 1	
PMT NO	PMT DT	TY	DESC	AMOUNT	INSP	BY	1st	%
17374	05/22/2017	3	ALT/RENO	26,100	04/26/2018		100	100
13491	07/29/2013	10	WOODSTOVE	5,000	02/24/2015		100	100
13376	06/12/2013	9	DECK	20,000	02/24/2015		100	100
07617	10/09/2007	4	DETACH.STRUC	2,400	09/19/2008	TL	100	100
900348	07/03/1990	1	NEW CONSTRUC	175,000	11/18/1991	HS	100	100

CD	T	AC/SF/UN	Nbhd	Infl1	N Index	ADJ BASE	SAF	Topo	Lpi	VC	CREDIT AMT	ADJ VALUE			
100	S	40,000	6	1.00	100	1.00	100	1.00	294,625	1.00	A	1.00	R07	1.25	270,490
300	A	0.302	6	1.00	100	1.00	100	1.00	20,375	1.00	A	1.00	R07	1.25	6,150
300	A	0.039	6	1.00	100	1.00	100	1.00	20,375	1.00	OS	1.00	R07	1.25	790

TOTAL	1.222 Acres	ZONING	1	FRNT	0	ASSESSED	CURRENT	PREVIOUS
Nbhd	BOURNE	N O T E	326=GREEN AREA ON PLAN 1/7 INT			LAND	277,400	245,500
Infl1	AVG		BUILDING	473,100	418,600			
N_Index	AVG		DETACHED	2,100	2,000			
			OTHER	0	0			
			TOTAL	752,600	666,100			

TY	QUAL	COND	DIM/NOTE	YB	UNITS	ADJ PRICE	RCNLD
SHF	A	1.00	10 0.90 10 X 14	2007	140	16.42	2,100

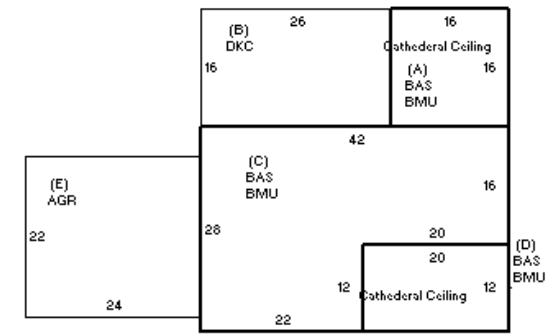

BUILDING	CD	ADJ	DESC	MEASURE	2/24/2015	DB
MODEL	1		RESIDENTIAL	LIST	2/24/2015	EST
STYLE	4	1.05	CAPE [100%]	REVIEW	4/26/2018	TL
QUALITY	+	1.05	AVERAGE + [100%]			
FRAME	1	1.00	WOOD FRAME [100%]			

BLDG COMMENTS

YEAR BLT	1990	SIZE ADJ	1.005	ELEMENT	CD	DESCRIPTION	ADJ	S	BAT	T	DESCRIPTION	UNITS	YB	ADJ PRICE	RCN	TOTAL RCN	584,078															
NET AREA	2,368	DETAIL ADJ	1.000	FOUNDATION	4	FLR/WALL(FULL)	1.00	+	BMU	N	BSMT UNFINISHED	1,432		37.42	53,585																	
\$NLA(RCN)	\$247	OVERALL	1.110	EXT COVER	1	WOOD SHINGLE	1.02	+	BAS	L	BASE AREA	1,432	1990	214.89	307,716																	
				ROOF SHAPE	1	GABLE	1.00	B	DKC	N	DECK-COMPOSITE	416		73.55	30,595																	
				ROOF COVER	1	ASPH/COMP SHIN	1.00	E	AGR	N	ATT GARAGE	528		72.39	38,224																	
				FLOOR COVER	1	HARDWOOD	1.02		USF	L	UPPER STORY FIN	936	1990	126.09	118,024																	
				INT. FINISH	2	DRYWALL	1.00		F11	O	FPL 1S 1OP	1		9,391.70	9,392																	
				HEATING/COOLING	2	HOT WATER	1.02		FIX	O	XTRA FIXTURES	3		2,494.53	7,484																	
				FUEL SOURCE	1	OIL	1.00		JAC	O	JACUZZI	1		14,383.90	14,384																	
				USE	0		1.00		MST	O	MAS/METAL STACK	1		4,674.80	4,675																	
				<table border="1"> <thead> <tr> <th>CONDITION ELEM</th> <th>CD</th> </tr> </thead> <tbody> <tr> <td>EXTERIOR</td> <td>G</td> </tr> <tr> <td>INTERIOR</td> <td>A</td> </tr> <tr> <td>KITCHEN</td> <td>A</td> </tr> <tr> <td>BATHS</td> <td>A</td> </tr> <tr> <td>HEAT</td> <td>A</td> </tr> <tr> <td>ELECT</td> <td>A</td> </tr> </tbody> </table>														CONDITION ELEM	CD	EXTERIOR	G	INTERIOR	A	KITCHEN	A	BATHS	A	HEAT	A	ELECT	A	
CONDITION ELEM	CD																															
EXTERIOR	G																															
INTERIOR	A																															
KITCHEN	A																															
BATHS	A																															
HEAT	A																															
ELECT	A																															
				<table border="1"> <thead> <tr> <th>EFF.YR/AGE</th> <td colspan="2">2000 / 22</td> </tr> </thead> <tbody> <tr> <td>COND</td> <td>19</td> <td>19 %</td> </tr> <tr> <td>FUNC</td> <td>0</td> <td></td> </tr> <tr> <td>ECON</td> <td>0</td> <td></td> </tr> <tr> <td>DEPR</td> <td>19</td> <td>% GD 81</td> </tr> </tbody> </table>														EFF.YR/AGE	2000 / 22		COND	19	19 %	FUNC	0		ECON	0		DEPR	19	% GD 81
EFF.YR/AGE	2000 / 22																															
COND	19	19 %																														
FUNC	0																															
ECON	0																															
DEPR	19	% GD 81																														
				<table border="1"> <thead> <tr> <th>RCNLD</th> <td>\$473,100</td> </tr> </thead> </table>														RCNLD	\$473,100													
RCNLD	\$473,100																															