

Key: 5326

Town of Bourne - Fiscal Year 2024

12/18/2023 6:02 pm SEQ #: 5.469

LEGAL

Table with columns: CURRENT OWNER, PARCEL ID, LOCATION, TRANSFER HISTORY, ADJ BASE, SAF, Topo, Lpi, VC, CREDIT AMT, ADJ VALUE.

Table with columns: CLASS, CLASS%, DESCRIPTION, BN ID, BN, CARD, PMT NO, PMT DT, TY, DESC, AMOUNT, INSP, BY, 1st, %.

LAND

Table with columns: TOTAL, ZONING, FRNT, ASSESSED, CURRENT, PREVIOUS, Nbhd, Infil, N_Index, N, O, T, E.

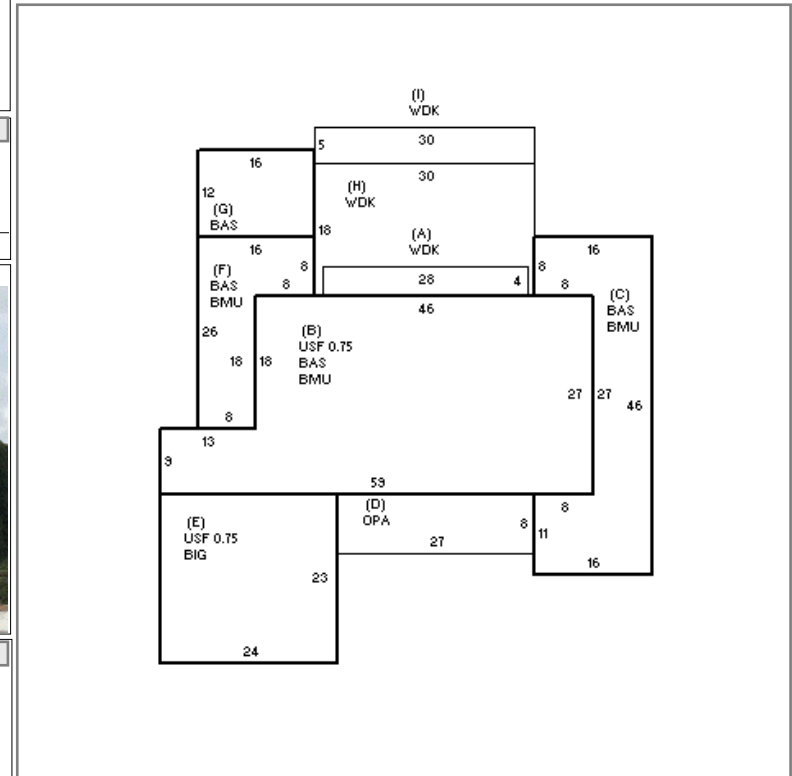

DETACHED

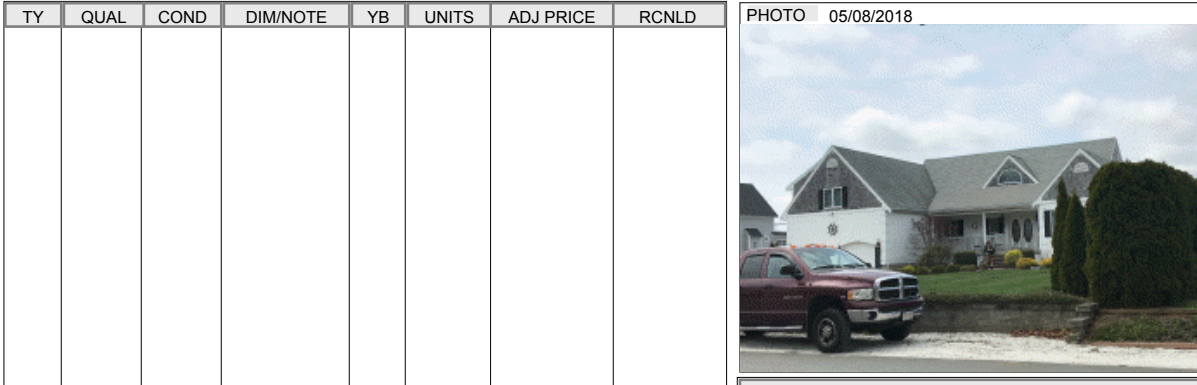

Table with columns: BUILDING, CD, ADJ, DESC, MEASURE, 5/7/2018, TL, LIST, 5/7/2018, EST, REVIEW, 5/7/2018, TL.

BUILDING

Table with columns: YEAR BLT, SIZE ADJ, 0.990, ELEMENT, CD, DESCRIPTION, ADJ, S, BAT, T, DESCRIPTION, UNITS, YB, ADJ PRICE, RCN, TOTAL RCN, 950,152, CONDITION ELEM, CD, EFF. YR/AGE, 2003 / 19, COND, 16 16 %, FUNC, 0, ECON, 0, DEPR, 16 % GD, 84, RCNLD, \$798,100.