

Key: 5654

Town of Bourne - Fiscal Year 2024

12/18/2023 6:02 pm SEQ #: 5.795

LEG
A
L
L
A
N
D

CURRENT OWNER				PARCEL ID				LOCATION				
MORNEAU GEOFFREY & KIMBERLY A MORNEAU 686 ANGELL ST PROVIDENCE, RI 02906				26.4-10-0				268 SHORE RD				
				TRANSFER HISTORY				DOS	T	SALE PRICE	BK-PG (Cert)	
				MORNEAU GEOFFREY & CURTIN EMILY CLARKE LOGAN III				04/13/2021	O	640,000	34006-183	
						01/08/2004	QS	363,200	18105-329			
						04/17/2002	F	1	15057-268			

CLASS	CLASS%	DESCRIPTION			BN ID	BN	CARD	
1010	100	SINGLE FAMILY				1	1 of 1	
PMT NO	PMT DT	TY	DESC	AMOUNT	INSP	BY	1st	%
B-21-170	06/28/2021	3	ALT/RENO		04/12/2023	TL	100	100
EXB-21-392	06/03/2021	15	INSULATE/WEA	60,000	10/26/2022	TL	100	100
12289	05/01/2012	3	ALT/RENO	8,126	04/05/2018	BC	100	100
960413	09/04/1996	9	DECK	700	07/22/1997	JC	100	100

CD	T	AC/SF/UN	Nbhd	Infl1	N Index	ADJ BASE	SAF	Topo	Lpi	VC	CREDIT AMT	ADJ VALUE					
100	S	30,290	6	1.00	100	1.00	100	1.00	341,765	1.23	A	1.00	BVG	1.45			291,670

TOTAL	30,274 SF	ZONING	1	FRNT	0	ASSESSED	CURRENT	PREVIOUS
Nbhd	BOURNE	N O T E	VIEW OF MARSH; abutts fish processing plant & railroad tracks			LAND	291,700	258,100
Infl1	AVG		BUILDING	651,100	461,900			
N_Index	AVG		DETACHED	0	0			
			OTHER	0	0			
					TOTAL	942,800	720,000	

TY	QUAL	COND	DIM/NOTE	YB	UNITS	ADJ PRICE	RCNLD



BUILDING	CD	ADJ	DESC	MEASURE	4/21/2022	TL
MODEL	1		RESIDENTIAL	LIST	4/21/2022	EST
STYLE	8	1.10	CONTEMPORARY [100%]	REVIEW	4/10/2023	TL
QUALITY	G	1.10	GOOD [100%]			
FRAME	1	1.00	WOOD FRAME [100%]			

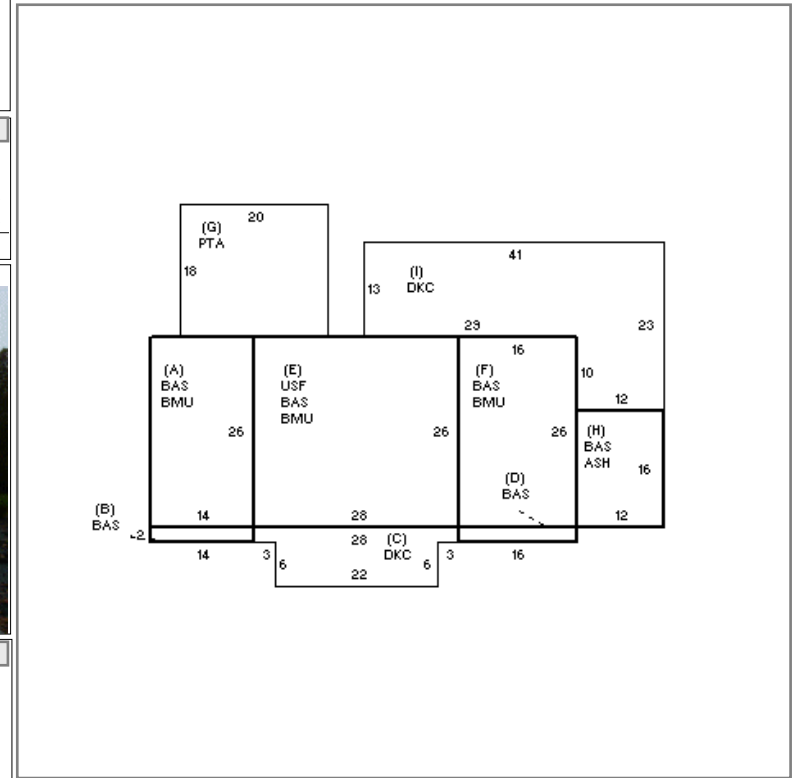

D
E
T
A
C
H
E
D

B
U
I
L
D
I
N
G

YEAR BLT	1986	SIZE ADJ	1.005	ELEMENT	CD	DESCRIPTION	ADJ	S	BAT	T	DESCRIPTION	UNITS	YB	ADJ PRICE	RCN	TOTAL RCN	678,271			
NET AREA	2,488	DETAIL ADJ	1.000	FOUNDATION	4	FLR/WALL(FULL)	1.00	+	BMU	N	BSMT UNFINISHED	1,508		42.03	63,376	CONDITION ELEM	CD			
\$NLA(RCN)	\$273	OVERALL	1.190	EXT COVER	1	WOOD SHINGLE	1.02	+	BAS	L	BASE AREA	1,568	1986	233.00	365,351	EXTERIOR	G			
				ROOF SHAPE	1	GABLE	1.00	+	DKC	N	DECK-COMPOSITE	841		80.81	67,964	INTERIOR	G			
				ROOF COVER	1	ASPH/COMP SHIN	1.00	E	USF	L	UPPER STORY FIN	728	1986	143.04	104,136	KITCHEN	G			
				FLOOR COVER	2	SOFTWOOD	1.02	G	PTA	N	PATIO	360		17.89	6,440	BATHS	G			
				INT. FINISH	1	PLASTER	1.00	H	ASH	N	ATT SHED	192		29.61	5,686	HEAT	U			
				HEATING/COOLING	11	HT WATER CL AIR	1.05	H	BAS	L	BASE AREA	192	2022	233.00	44,736	ELECT	U			
				FUEL SOURCE	2	GAS	1.00		BMG	O	BSMT GARAGE	1		9,377.20	9,377					
				USE	0		1.00		FIX	O	XTRA FIXTURES	4		2,801.45	11,206					
																		EFF.YR/AGE	2015 / 7	
																		COND	4 4 %	
																		FUNC	0	
																		ECON	0	
																		DEPR	4 % GD 96	
																		RCNLD	\$651,100	