

Key: 5712

Town of Bourne - Fiscal Year 2024

12/18/2023 6:02 pm SEQ #: 5.853

LEGAL

Table with columns: CURRENT OWNER, PARCEL ID, LOCATION, TRANSFER HISTORY, DOS, T, SALE PRICE, BK-PG (Cert). Includes owner TAYLOR THOMAS M and transfer history from 03/15/2021.

Table with columns: CLASS, CLASS%, DESCRIPTION, BN ID, BN, CARD. Includes multiple dwelling information and payment details.

LAND

Table with columns: CD, T, AC/SF/UN, Nbhd, Infl1, N Index, ADJ BASE, SAF, Topo, Lpi, VC, CREDIT AMT, ADJ VALUE. Includes land area of 32,496 SF and assessed value of 184,130.

Table with columns: TOTAL, ZONING, FRNT, ASSESSED, CURRENT, PREVIOUS. Includes zoning DISTANT VIEWS and assessed values for land, building, and other.

DETACHED

Table with columns: TY, QUAL, COND, DIM/NOTE, YB, UNITS, ADJ PRICE, RCNLD. Includes property details like 10 X 14 lot and 140 units.

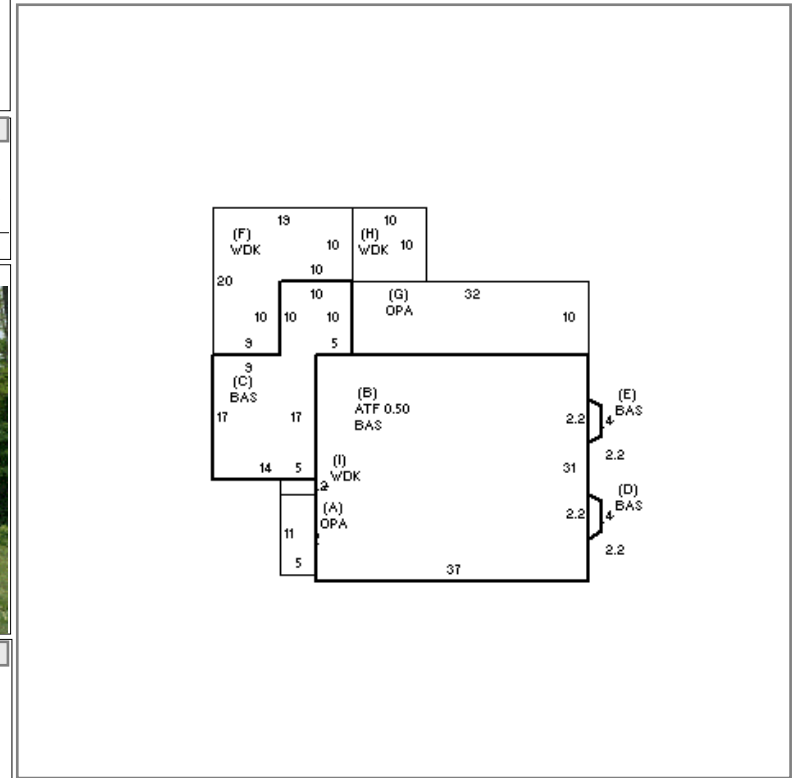

BUILDING

Table with columns: BUILDING, CD, ADJ, DESC, MEASURE, 10/14/2020, TL. Includes building details like RESIDENTIAL and WOOD FRAME [100%].

Table with columns: BLDG COMMENTS.

INDING

Large table with columns: YEAR BLT, SIZE ADJ, ELEMENT, CD, DESCRIPTION, ADJ, S, BAT, T, DESCRIPTION, UNITS, YB, ADJ PRICE, RCN, TOTAL RCN, 461,649. Includes detailed building components and capacity information.

Summary table with columns: TOTAL RCN, 461,649; CONDITION ELEM, CD; EFF. YR/AGE, 1971 / 51; COND, 48 48 %; DEPR, 48 % GD, 52; RCNLD, \$240,100.

