

Key: 622

Town of Bourne - Fiscal Year 2024

12/18/2023 6:02 pm SEQ #: 621

LEGAL

Table with columns: CURRENT OWNER, PARCEL ID, LOCATION, TRANSFER HISTORY, DOS, T, SALE PRICE, BK-PG (Cert). Includes owner name SHARON-MATTHEWS CATHERINE & JAMES R MATTHEWS TRS and parcel details.

Table with columns: CLASS, CLASS%, DESCRIPTION, BN ID, BN, CARD. Includes details for parcel 910330, class 100, and description SINGLE FAMILY.

LAND

Table with columns: CD, T, AC/SF/UN, Nbhd, Infl1, N Index, ADJ BASE, SAF, Topo, Lpi, VC, CREDIT AMT, ADJ VALUE. Includes land area and value information.

Table with columns: TOTAL, 18,557 SF, ZONING, 1, FRNT, 115, ASSESSED, CURRENT, PREVIOUS. Includes zoning and assessed value details.

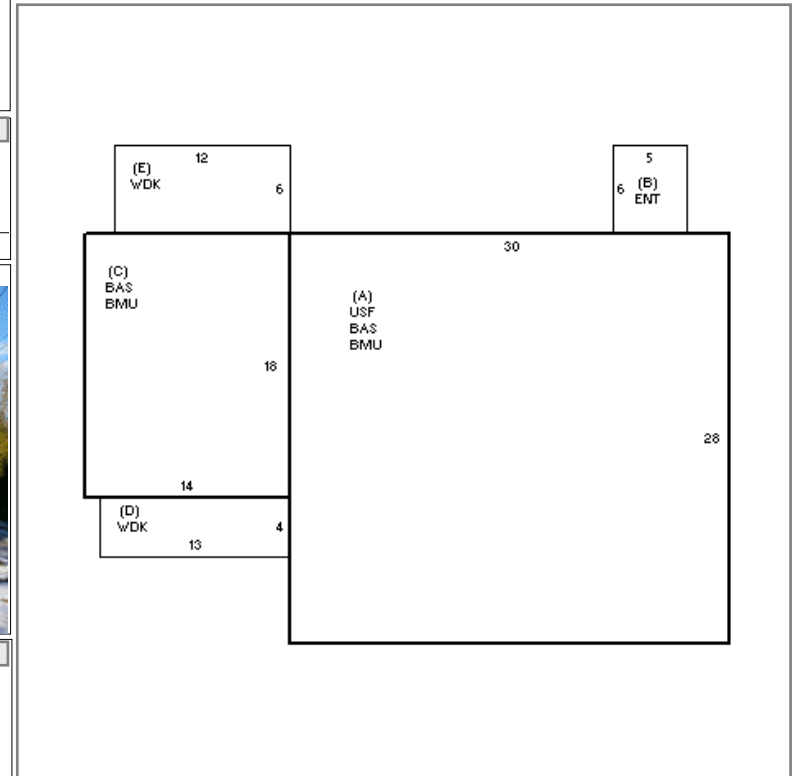

DETACHED

Table with columns: TY, QUAL, COND, DIM/NOTE, YB, UNITS, ADJ PRICE, RCNLD. Includes property characteristics and unit information.



Table with columns: BLDG COMMENTS. Includes a section for building remarks.

BUILDING

Table with columns: BUILDING, CD, ADJ, DESC, MEASURE, 7/20/2021, NMP. Includes building details and measurement dates.

Table with columns: YEAR BLT, SIZE ADJ, 1.010, ELEMENT, CD, DESCRIPTION, ADJ. Includes building age, capacity, and element details.

Table with columns: S, BAT, T, DESCRIPTION, UNITS, YB, ADJ PRICE, RCN. Includes structural and material details with prices and RCN values.

Table with columns: TOTAL RCN, 382,732, CONDITION ELEM, CD. Includes summary totals and condition codes.