

Key: 6300

Town of Bourne - Fiscal Year 2024

12/18/2023 6:02 pm SEQ #: 6.456

LEGAL

CURRENT OWNER				PARCEL ID				LOCATION			
ONEIL JOHN PO BOX 479 MONUMENT BEACH, MA 02553-0479				30.2-193-0				8 MILLBROOK RD			
TRANSFER HISTORY				DOS	T	SALE PRICE	BK-PG (Cert)				
ONEIL JOHN				05/29/1998	QS	78,000	11465-35				

CLASS	CLASS%	DESCRIPTION				BN ID	BN	CARD	
1010	100	SINGLE FAMILY					1	1 of 1	
PMT NO	PMT DT	TY	DESC	AMOUNT	INSP	BY	1st	%	

LAND

CD	T	AC/SF/UN	Nbhd	Infl1	N Index	ADJ BASE	SAF	Topo	Lpi	VC	CREDIT AMT	ADJ VALUE	
100	S	12,700 9	1.00	100	1.00	100	1.00	235,700	2.53	A	1.00	R04 1.00	173,560

TOTAL	12,720 SF	ZONING	1	FRNT	0	ASSESSED	CURRENT	PREVIOUS
Nbhd	MO BCH	NOTE	LAND	173,600	153,600			
Infl1	AVG		BUILDING	174,500	154,400			
N_Index	AVG		DETACHED	0	0			
			OTHER	0	0			
			TOTAL	348,100	308,000			

DETACHED

TY	QUAL	COND	DIM/NOTE	YB	UNITS	ADJ PRICE	RCNLD
SHF	A	1.00 A	0.75 12 X 8			0.00	

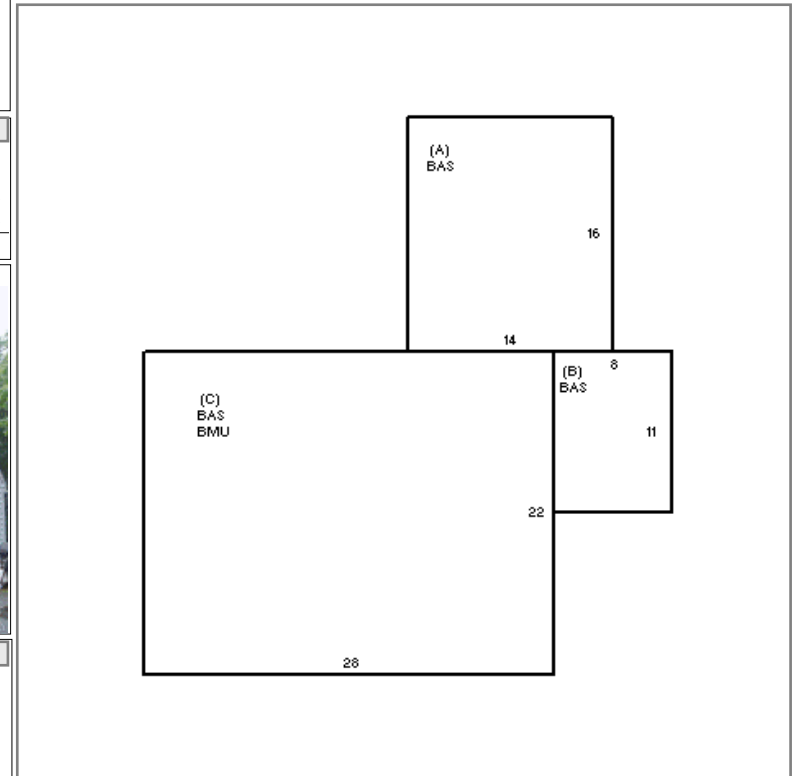

BUILDING

BUILDING	CD	ADJ	DESC	MEASURE	5/17/2012	TL
MODEL	1		RESIDENTIAL	LIST	5/17/2012	EST
STYLE	1	0.95	RANCH [100%]	REVIEW	5/17/2012	TL
QUALITY	A	1.00	AVERAGE [100%]			
FRAME	1	1.00	WOOD FRAME [100%]			

BLDG COMMENTS

G

YEAR BLT	1950	SIZE ADJ	1.020	ELEMENT	CD	DESCRIPTION	ADJ	S	BAT	T	DESCRIPTION	UNITS	YB	ADJ PRICE	RCN	TOTAL RCN	218,064	
NET AREA	928	DETAIL ADJ	1.000	FOUNDATION	4	FLR/WALL(FULL)	1.00	+	BAS	L	BASE AREA	928	1950	196.20	182,076	CONDITION ELEM	CD	
\$NLA(RCN)	\$235	OVERALL	0.970	EXT COVER	1	WOOD SHINGLE	1.02	C	BMU	N	BSMT UNFINISHED	616		45.54	28,054	EXTERIOR	A	
				ROOF SHAPE	1	GABLE	1.00		F11	O	FPL 1S 10P	1		7,933.00	7,933	INTERIOR	G	
				ROOF COVER	1	ASPH/COMP SHIN	1.00									KITCHEN	A	
				FLOOR COVER	3	W/W CARPET	1.00									BATHS	G	
				INT. FINISH	2	DRYWALL	1.00									HEAT	A	
				HEATING/COOLING	1	FORCED AIR	1.00									ELECT	A	
				FUEL SOURCE	1	OIL	1.00											
				USE	0		1.00											
																EFF.YR/AGE	1999 / 23	
																COND	20 20 %	
																FUNC	0	
																ECON	0	
																DEPR	20 % GD 80	
																RCNLD	\$174,500	