

Key: 6646

Town of Bourne - Fiscal Year 2024

12/18/2023 6:02 pm SEQ #: 6.810

LEGALS

CURRENT OWNER						PARCEL ID			LOCATION						
CARPENTER KRIS JR & SARAH FLINT 12 HARBOR HILL DR BOURNE, MA 02532						31.0-30-12			12 HARBOR HILL DR						
						TRANSFER HISTORY			DOS	T	SALE PRICE	BK-PG (Cert)			
						CARPENTER KRIS JR & BRODNICKI PAUL J ETUX			10/18/2022	QS	295,000	35430-70			
						ROGERS CAROL A			08/29/2013	QS	218,000	27654-269			
			05/31/2007	QS	265,000	22070-250									

CLASS	CLASS%	DESCRIPTION			BN ID	BN	CARD
1020	100	CONDOMINIUM				1	1 of 1
PMT NO	PMT DT	TY	DESC	AMOUNT	INSP	BY	1st %

LAND

CD	T	AC/SF/UN	Nbhd	Infl1	N Index	ADJ BASE	SAF	Topo	Lpi	VC	CREDIT AMT	ADJ VALUE

TOTAL	21.640 Acres	ZONING	FRNT	0	ASSESSED	CURRENT	PREVIOUS
Nbhd		NOTE	LAND	0	0	0	
Infl1			BUILDING	327,700	309,500		
N_Index			DETACHED	0	0		
			OTHER	0	0		
			TOTAL	327,700	309,500		

DETACHED

TY	QUAL	COND	DIM/NOTE	YB	UNITS	ADJ PRICE	RCNLD

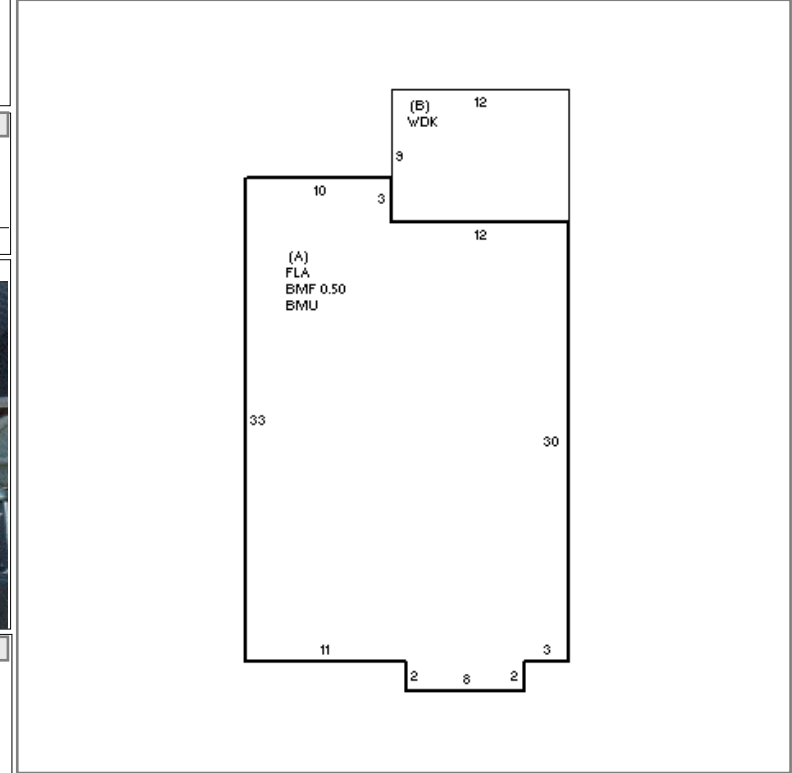

BUILDING

BUILDING	CD	ADJ	DESC	MEASURE	8/26/2021	RP
MODEL	10		RES CONDO	LIST	8/26/2021	EST
STYLE	2	1.30	TOWN HOUSE MID [100%]	REVIEW	8/26/2021	RP
QUALITY	A	1.00	AVERAGE [100%]			
FRAME	1	1.00	WOOD FRAME [100%]			

BLDG COMMENTS		

G

YEAR BLT	1986	SIZE ADJ	1.000	ELEMENT	CD	DESCRIPTION	ADJ	S	BAT	T	DESCRIPTION	UNITS	YB	ADJ PRICE	RCN	TOTAL RCN	368,192
NET AREA	1,388	DETAIL ADJ	1.000	COMPLEX	12	HARBOR HILL 1	1.15	A	BMU	N	BSMT UNF	706		19.65	13,874	CONDITION ELEM	CD
\$NLA(RCN)	\$265	OVERALL	1.500	OCCUPANCY	1	YEAR ROUND	1.00	A	BMF	N	BSMT FIN	353		19.65	6,936	INTERIOR	A
				FLOOR/LOC	5	MULTI FLOOR	1.00	A	FLA	L	LIVING AREA	706	1986	345.74	244,095	KITCHEN	A
				VIEW INFL	13	GOLF VIEW	1.05	B	WDK	N	WOODDECK	108		27.00	2,916	BATHS	A
				HT/CL	1	FORCED AIR	1.00		USF	L	UPPER STORY FIN	682	1986	130.65	89,103	EXTERIOR	A
				WDK/PTA/BALC	1	PRESENT	1.00		F21	O	FPL 2ST 10P	1		11,268.00	11,268		
				PARKING	2	OUTDOOR 2 SPACE	1.00										
				NET ADJ(%GOOD)	100	100 %RG	1.00										
CAPACITY		UNITS	ADJ														
ROOMS		4	1.00														
BEDROOMS		2	1.00														
BATHROOMS		1	1.00														
HALFBATHS		1	1.00														
FIREPLACES		1	1.00														
																EFF.YR/AGE	1986 / 36
																COND	11 11 %
																FUNC	0
																ECON	0
																DEPR	11 % GD 89
																RCNLD	\$327,700