

Key: 6915

Town of Bourne - Fiscal Year 2024

12/18/2023 6:02 pm SEQ #: 7.079

LEGAL

CURRENT OWNER						PARCEL ID			LOCATION				
SHERMAN CARL S & JODI L SHERMAN PO BOX 653 CHILMARK, MA 02535						31.3-178-84			84 ROUNDHOUSE RD				
						TRANSFER HISTORY			DOS	T	SALE PRICE	BK-PG (Cert)	
						SHERMAN CARL S & MAGINNIS JOHN			06/26/2020	QS	220,000	33020-24	
			12/16/2013			QS	152,000	27885-282					
			01/31/1992			QS	80,000	07859-00163					

CLASS	CLASS%	DESCRIPTION			BN ID	BN	CARD	
1020	100	CONDOMINIUM				1	1 of 1	
PMT NO	PMT DT	TY	DESC	AMOUNT	INSP	BY	1st	%
10000	01/04/2010	3	ALT/RENO	35,000	09/25/2010	JB	0	100

LAND

CD	T	AC/SF/UN	Nbhd	Infl1	N Index	ADJ BASE	SAF	Topo	Lpi	VC	CREDIT AMT	ADJ VALUE

TOTAL	67.170 Acres	ZONING	FRNT	0	ASSESSED	CURRENT	PREVIOUS
Nbhd		NOTE	LAND	0	0	0	
Infl1			BUILDING	279,300	249,900		
N_Index			DETACHED	0	0		
			OTHER	0	0		
			TOTAL	279,300	249,900		

DETACHED

TY	QUAL	COND	DIM/NOTE	YB	UNITS	ADJ PRICE	RCNLD	PHOTO
								08/01/2008
								

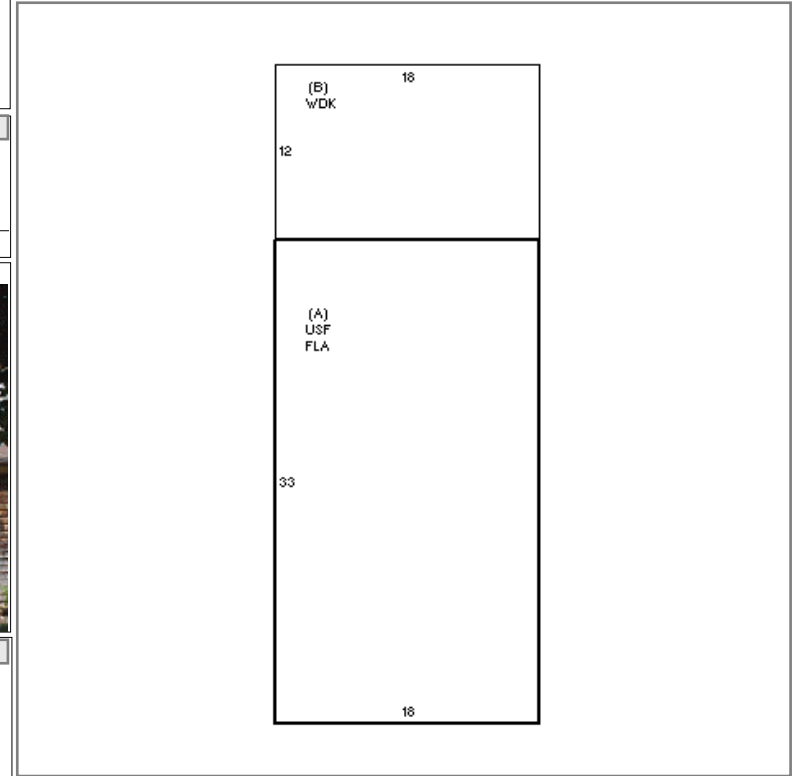

BUILDING

BUILDING	CD	ADJ	DESC	MEASURE	9/1/2021	RP
MODEL	10		RES CONDO	LIST	9/1/2021	EST
STYLE	2	1.30	TOWN HOUSE MID [100%]	REVIEW	9/1/2021	RP
QUALITY	A	1.00	AVERAGE [100%]			
FRAME	1	1.00	WOOD FRAME [100%]			

BLDG COMMENTS		

LOADING

YEAR BLT	1985	SIZE ADJ	1.000	ELEMENT	CD	DESCRIPTION	ADJ	S	BAT	T	DESCRIPTION	UNITS	YB	ADJ PRICE	RCN	TOTAL RCN	310,299	
NET AREA	1,188	DETAIL ADJ	1.000	COMPLEX	45	SEA WAT VILL 2	1.30	A	FLA	L	LIVING AREA	594	1985	372.56	221,299	CONDITION ELEM	CD	
\$NLA(RCN)	\$261	OVERALL	1.600	OCCUPANCY	1	YEAR ROUND	1.00	A	USF	L	UPPER STORY FIN	594	1985	139.36	82,779	INTERIOR	G	
				FLOOR/LOC	5	MULTI FLOOR	1.00	B	WDK	N	WOODDECK	216		28.80	6,221	KITCHEN	A	
				VIEW INFL	5	AVERAGE	1.00									BATHS	A	
				HT/CL	5	ELECTRIC BASB	1.00									EXTERIOR	A	
				WDK/PTA/BALC	1	PRESENT	1.00											
				PARKING	1	OUTDOOR 1 SPACE	1.00											
				NET ADJ(%GOOD)	100	100 %RG	1.00											
CAPACITY		UNITS	ADJ															
ROOMS		4	1.00															
BEDROOMS		2	1.00															
BATHROOMS		1	1.00															
HALFBATHS		1	1.00															
FIREPLACES		1	1.00															
EFF.YR/AGE 1989 / 33																		
COND 10 10 %																		
FUNC 0																		
ECON 0																		
DEPR 10 % GD 90																		
RCNLD \$279,300																		