

Key: 6931

Town of Bourne - Fiscal Year 2024

12/18/2023 6:02 pm SEQ #: 7.095

LEGALS AND

Table with columns: CURRENT OWNER, PARCEL ID, LOCATION, TRANSFER HISTORY, DOS, T, SALE PRICE, BK-PG (Cert), ADJ VALUE, etc.

Table with columns: CLASS, CLASS%, DESCRIPTION, BN ID, BN, CARD, PMT NO, PMT DT, TY, DESC, AMOUNT, INSP, BY, 1st, %

Table with columns: TOTAL, 26,615 SF, ZONING, 1, FRNT, 0, ASSESSED, CURRENT, PREVIOUS, NBHD, MO BCH, INF1, AVG, N_INDEX, AVG

Table with columns: TY, QUAL, COND, DIM/NOTE, YB, UNITS, ADJ PRICE, RCNLD, PHOTO 07/18/2000

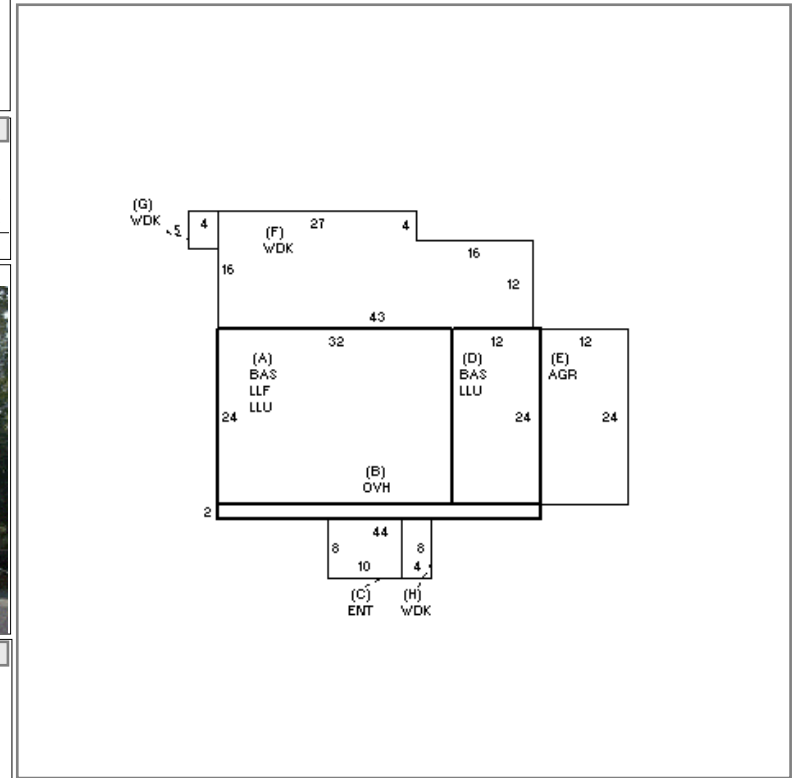

Table with columns: BUILDING, CD, ADJ, DESC, MEASURE, 7/18/2000, TL, MODEL, STYLE, QUALITY, FRAME

Table with columns: BLDG COMMENTS

DETACHED

BUILDING

Large summary table with columns: YEAR BLT, NET AREA, \$NLA(RCN), CAPACITY, UNITS, ADJ, ELEMENT, CD, DESCRIPTION, ADJ, S, BAT, T, DESCRIPTION, UNITS, YB, ADJ PRICE, RCN, TOTAL RCN, 371,906, CONDITION ELEM, CD, EFF. YR/AGE, 1980 / 42, COND, FUNC, ECON, DEPR, RCNLD, \$226,900