

Key: 7752

Town of Bourne - Fiscal Year 2024

12/18/2023 6:02 pm SEQ #: 7.911

LEGALS

DETAILED

BUILING

CURRENT OWNER				PARCEL ID				LOCATION				
OKEEFE KEVIN L ET UX PATTI M OKEEFE 32082 HORSESHOE DR EVERGREEN, CO 80439				37.4-30-0				130 WINGS NECK RD				
TRANSFER HISTORY				DOS	T	SALE PRICE	BK-PG (Cert)					
OKEEFE KEVIN L ET UX				07/28/2015	U	866,000	29041-113					
FOLEY JOHN G				10/07/1998	F	1 11749-275						
CD	T	AC/SF/UN	Nbhd	Infl1	N Index	ADJ BASE	SAF	Topo	Lpi	VC	CREDIT AMT	ADJ VALUE
100	S	32,640	11	1.00	100 1.00	1,343,490	1.16	A	1.00	BEX	5.70	1,167,560

TOTAL	32,626 SF	ZONING	1	FRNT	0	ASSESSED	CURRENT	PREVIOUS
Nbhd	POC	NOTE marsh before water				LAND	1,167,600	1,033,300
Infl1	AVG					BUILDING	478,700	423,400
N_Index	AVG					DETTACHED	0	0
						OTHER	0	0
						TOTAL	1,646,300	1,456,700

TY	QUAL	COND	DIM/NOTE	YB	UNITS	ADJ PRICE	RCNLD



BUILDING	CD	ADJ	DESC	MEASURE	11/7/2022	SL
MODEL	1		RESIDENTIAL	LIST	11/7/2022	EST
STYLE	8	1.10	CONTEMPORARY [100%]	REVIEW	11/7/2022	SL
QUALITY	+	1.05	AVERAGE + [100%]			
FRAME	1	1.00	WOOD FRAME [100%]			

YEAR BLT	1980	SIZE ADJ	1.005	ELEMENT	CD	DESCRIPTION	ADJ	S	BAT	T	DESCRIPTION	UNITS	YB	ADJ PRICE	RCN	TOTAL RCN	537,814
NET AREA	2,044	DETAIL ADJ	1.000	FOUNDATION	4	FLR/WALL(FULL)	1.00	+	BMU	N	BSMT UNFINISHED	1,262		39.44	49,776	CONDITION ELEM CD	
\$NLA(RCN)	\$263	OVERALL	1.170	EXT COVER	1	WOOD SHINGLE	1.02	+	BAS	L	BASE AREA	1,262	1980	232.09	292,898	EXTERIOR	A
				ROOF SHAPE	1	GABLE	1.00	+	DKC	N	DECK-COMPOSITE	612		76.61	46,883	INTERIOR	A
				ROOF COVER	1	ASPH/COMP SHIN	1.00		USF	L	UPPER STORY FIN	782	1980	134.25	104,980	KITCHEN	G
				FLOOR COVER	1	HARDWOOD	1.02		BMG	O	BSMT GARAGE	2		8,800.55	17,601	BATHS	G
				INT. FINISH	2	DRYWALL	1.00		F11	O	FPL 1S 1OP	1		9,899.40	9,899	HEAT	U
				HEATING/COOLING	9	WARM-COOL AIR	1.03		FIX	O	XTRA FIXTURES	6		2,629.38	15,776	ELECT	U
				FUEL SOURCE	2	GAS	1.00										
				USE	0		1.00										

CLASS	CLASS%	DESCRIPTION			BN ID	BN	CARD	
1010	100	SINGLE FAMILY				1	1 of 1	
PMT NO	PMT DT	TY	DESC	AMOUNT	INSP	BY	1st	%
B-21-458	12/20/2021	3	ALT/RENO	25,000	11/07/2022	SL	100	100
18569	07/05/2018	9	DECK	12,000	05/09/2022	TL	100	100
161083	12/23/2016	3	ALT/RENO	20,000	03/28/2018		100	100
03579	08/26/2003	3	ALT/RENO	5,000	01/29/2004	TL	100	100

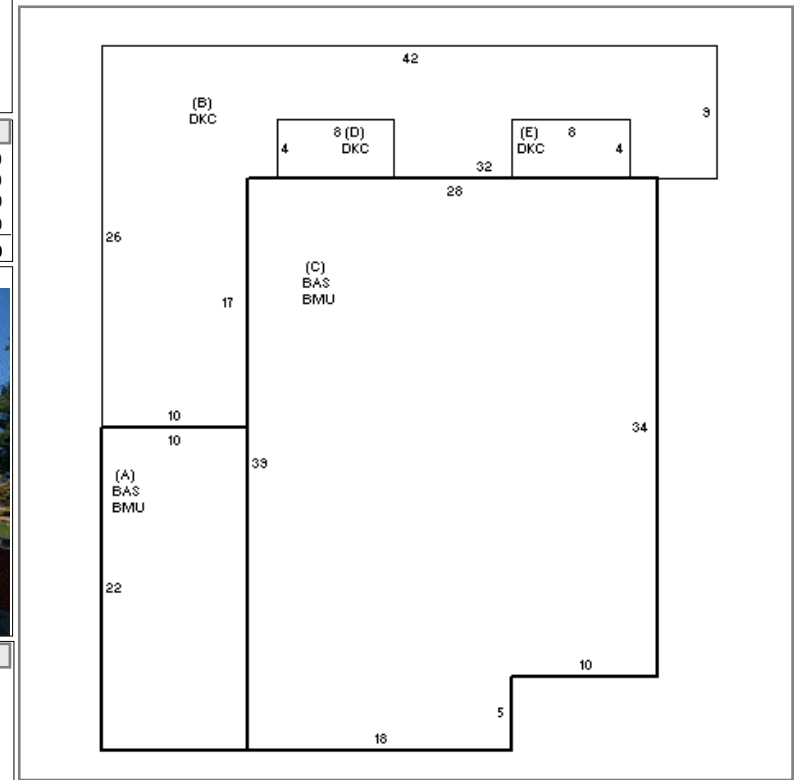

BLDG COMMENTS

BLDG COMMENTS

EFF.YR/AGE	2008 / 14
COND	11 11 %
FUNC	0
ECON	0
DEPR	11 % GD 89
RCNLD	\$478,700