

Key: 8466

Town of Bourne - Fiscal Year 2024

12/18/2023 6:02 pm SEQ #: 8.631

LEGALS

CURRENT OWNER						PARCEL ID			LOCATION			
ICKLER WARREN & PATRICIA HARTY-ICKLER 2C BROWNING CT POCASSET, MA 02559						39.0-70-3			2-40C BROWNING CT			
						TRANSFER HISTORY			DOS	T	SALE PRICE	BK-PG (Cert)
						ICKLER WARREN & DITULLIO JANICE E			10/03/2018	QS	287,000	31574-123
			ANDRUKONIS RUTH MAUREEN			02/28/2007	QS	281,500	21812-199			
						02/22/2007	N	21795-108				

CLASS	CLASS%	DESCRIPTION			BN ID	BN	CARD	
1020	100	CONDOMINIUM				1	1 of 1	
PMT NO	PMT DT	TY	DESC	AMOUNT	INSP	BY	1st	%
19221	03/28/2019	3	ALT/RENO	6,496	04/19/2019	RP	100	100

LAND

CD	T	AC/SF/UN	Nbhd	Infl1	N Index	ADJ BASE	SAF	Topo	Lpi	VC	CREDIT AMT	ADJ VALUE

TOTAL	29.230 Acres	ZONING	FRNT	0	ASSESSED	CURRENT	PREVIOUS
Nbhd		NOTE	LAND	0	0	0	
Infl1			BUILDING	383,700	343,200		
N_Index			DETACHED	0	0		
			OTHER	0	0		
			TOTAL	383,700	343,200		

DETACHED

TY	QUAL	COND	DIM/NOTE	YB	UNITS	ADJ PRICE	RCNLD



BLDG COMMENTS

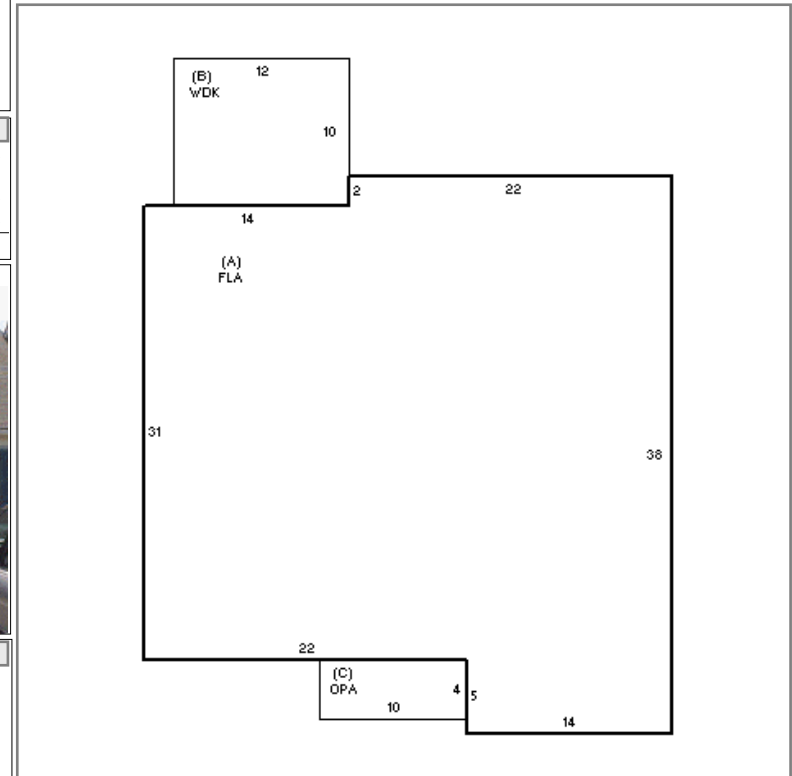

BUILDING

BUILDING	CD	ADJ	DESC	MEASURE	4/19/2019	RP
MODEL	10		RES CONDO	LIST	4/19/2019	EST
STYLE	2	1.30	TOWN HOUSE MID [100%]	REVIEW		
QUALITY	A	1.00	AVERAGE [100%]			
FRAME	1	1.00	WOOD FRAME [100%]			

YEAR BLT	1995	SIZE ADJ	1.000
NET AREA	1,561	DETAIL ADJ	1.000
\$NLA(RCN)	\$270	OVERALL	1.450
CAPACITY		UNITS	ADJ
ROOMS	5	1.00	
BEDROOMS	2	1.00	
BATHROOMS	2	1.00	
HALFBATHS	0	1.00	
FIREPLACES	1	1.00	

ELEMENT	CD	DESCRIPTION	ADJ
COMPLEX	13	LILY POND 1	1.15
OCCUPANCY	1	YEAR ROUND	1.00
FLOOR/LOC	5	MULTI FLOOR	1.00
VIEW INFL	5	AVERAGE	1.00
HT/CL	2	HOT WATER	1.00
WDK/PTA/BALC	1	PRESENT	1.00
PARKING	2	OUTDOOR 2 SPACE	1.00
NET ADJ(%GOOD)	100	100 %RG	1.00

S	BAT	T	DESCRIPTION	UNITS	YB	ADJ PRICE	RCN
A	FLA	L	LIVING AREA	1,230	1995	313.76	385,920
B	WDK	N	WOODDECK	120		26.10	3,132
C	OPA	N	OPEN PORCH ATTA	40		28.57	1,143
	LFT	L	LOFT	331	1995	64.38	21,309
	F11	O	FPL 1ST 10P	1		10,131.20	10,131

TOTAL RCN	421,635
CONDITION ELEM	CD
INTERIOR	A
KITCHEN	A
BATHS	A
EXTERIOR	A
EFF.YR/AGE	1995 / 27
COND	9 9 %
FUNC	0
ECON	0
DEPR	9 % GD 91
RCNLD	\$383,700