

Key: 8783

Town of Bourne - Fiscal Year 2024

12/18/2023 6:02 pm SEQ #: 8.961

LEG
A
L

L
A
N
D

D
E
T
A
C
H
E
D

B
U
I
L
D
I
N
G

CURRENT OWNER				PARCEL ID				LOCATION			
HAUPT RICHARD K ETUX KAYLEY E MARSH-HAUPT PO BOX 1091 NORTH FALMOUTH, MA 02556				42.0-27-0				70 NORTH RD			
TRANSFER HISTORY				DOS	T	SALE PRICE	BK-PG (Cert)				
HAUPT RICHARD K ETUX				03/28/2007	F	1	21886-241				
HAUPT RICHARD K				06/15/2006	QS	850,000	21102-86				
HAAS WALTER G				06/15/2006	N		21102-73				

CLASS	CLASS%	DESCRIPTION			BN ID	BN	CARD	
1010	100	SINGLE FAMILY				1	1 of 1	
PMT NO	PMT DT	TY	DESC	AMOUNT	INSP	BY	1st	%
11271	05/24/2011	6	FENCE		06/08/2011	JC	100	100
970506	01/08/1999	2	ADDITIONS	20,000	03/08/1999	JC	100	100
970506	10/07/1997	2	ADDITIONS	20,000	05/20/1998	JS	100	100
970019	01/06/1997	3	ALT/RENO	20,000	05/20/1998	JS	100	100
950422	08/30/1995	2	ADDITIONS	15,000	05/22/1996	JC	100	100

CD	T	AC/SF/UN	Nbhd	Infl1	N Index	ADJ BASE	SAF	Topo	Lpi	VC	CREDIT AMT	ADJ VALUE				
100	S	40,000	11	1.00	100	1.00	100	1.00	589,250	1.00	A	1.00	BA+	2.50		540,980
300	A	0.543	11	1.00	100	1.00	100	1.00	40,750	1.00	A	1.00	BA+	2.50		22,130

TOTAL	1.461 Acres	ZONING	1	FRNT	0	ASSESSED	CURRENT	PREVIOUS
Nbhd	POC	NOTE				LAND	563,100	438,500
Infl1	AVG					BUILDING	462,500	409,300
N_Index	AVG					DETACHED	29,900	26,400
						OTHER	0	0
						TOTAL	1,055,500	874,200

TY	QUAL	COND	DIM/NOTE	YB	UNITS	ADJ PRICE	RCNLD
SHF	A	1.00	50 0.50	16 X 12	192	15.95	1,500
GFU	G	1.20	10 0.90	24 X 24	576	49.32	25,600
IPG	G	1.20	10 0.90	5X12 INDOOR	60	51.50	2,800

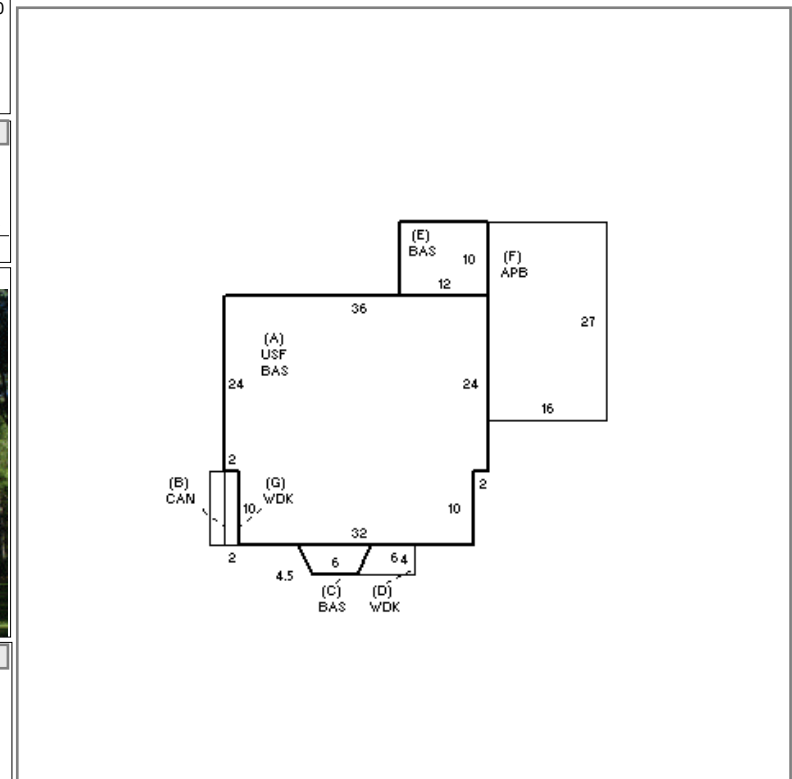

BUILDING	CD	ADJ	DESC	MEASURE	6/20/2011	TL
MODEL	1		RESIDENTIAL	LIST	6/20/2011	TL
STYLE	8	1.10	CONTEMPORARY [100%]	REVIEW	5/15/2018	KT
QUALITY	G	1.10	GOOD [100%]			
FRAME	1	1.00	WOOD FRAME [100%]			

BLDG COMMENTS

YEAR BLT	1998	SIZE ADJ	1.000	ELEMENT	CD	DESCRIPTION	ADJ	S	BAT	T	DESCRIPTION	UNITS	YB	ADJ PRICE	RCN	TOTAL RCN	564,029															
NET AREA	2,520	DETAIL ADJ	1.000	FOUNDATION	4	FLR/WALL(FULL)	1.00	+	BAS	L	BASE AREA	1,336	1998	241.93	323,222																	
\$NLA(RCN)	\$224	OVERALL	1.170	EXT COVER	10	VERT BOARD	1.00	A	USF	L	UPPER STORY FIN	1,184	1998	133.81	158,427																	
				ROOF SHAPE	3	GAMBREL	1.00	B	CAN	N	CANOPY	20		19.89	398																	
				ROOF COVER	1	ASP/COMP SHIN	1.00	+	WDK	N	WOOD DECK	68		69.06	4,696																	
				FLOOR COVER	1	HARDWOOD	1.02	F	APB	N	ATT POOL BLDG	432		73.10	31,580																	
				INT. FINISH	2	DRYWALL	1.00		CPC	O	CAPE CELLAR	1		4,859.70	4,860																	
				HEATING/COOLING	11	HT WATER CL AIR	1.05		F21	O	FPL 2S 1OP	1		11,337.20	11,337																	
				FUEL SOURCE	1	OIL	1.00		FIX	O	XTRA FIXTURES	5		2,740.80	13,704																	
				USE	0		1.00		JAC	O	JACUZZI	1		15,804.40	15,804																	
				<table border="1"> <thead> <tr> <th>CONDITION ELEM</th> <th>CD</th> </tr> </thead> <tbody> <tr> <td>EXTERIOR</td> <td>A</td> </tr> <tr> <td>INTERIOR</td> <td>A</td> </tr> <tr> <td>KITCHEN</td> <td>A</td> </tr> <tr> <td>BATHS</td> <td>A</td> </tr> <tr> <td>HEAT</td> <td>A</td> </tr> <tr> <td>ELECT</td> <td>A</td> </tr> </tbody> </table>														CONDITION ELEM	CD	EXTERIOR	A	INTERIOR	A	KITCHEN	A	BATHS	A	HEAT	A	ELECT	A	
CONDITION ELEM	CD																															
EXTERIOR	A																															
INTERIOR	A																															
KITCHEN	A																															
BATHS	A																															
HEAT	A																															
ELECT	A																															
				<table border="1"> <thead> <tr> <th>EFF.YR/AGE</th> <th colspan="2">2001 / 21</th> </tr> </thead> <tbody> <tr> <td>COND</td> <td>18</td> <td>18 %</td> </tr> <tr> <td>FUNC</td> <td>0</td> <td></td> </tr> <tr> <td>ECON</td> <td>0</td> <td></td> </tr> <tr> <td>DEPR</td> <td>18</td> <td>% GD 82</td> </tr> </tbody> </table>														EFF.YR/AGE	2001 / 21		COND	18	18 %	FUNC	0		ECON	0		DEPR	18	% GD 82
EFF.YR/AGE	2001 / 21																															
COND	18	18 %																														
FUNC	0																															
ECON	0																															
DEPR	18	% GD 82																														
				<table border="1"> <thead> <tr> <th>RCNLD</th> <th>\$462,500</th> </tr> </thead> </table>														RCNLD	\$462,500													
RCNLD	\$462,500																															