

Key: 9202

Town of Bourne - Fiscal Year 2024

12/18/2023 6:02 pm SEQ #: 9.410

LEGAL

Table with columns: CURRENT OWNER, PARCEL ID, LOCATION, TRANSFER HISTORY, DOS, T, SALE PRICE, BK-PG (Cert).

Table with columns: CLASS, CLASS%, DESCRIPTION, BN ID, BN, CARD, PMT NO, PMT DT, TY, DESC, AMOUNT, INSP, BY, 1st, %.

LAND

Table with columns: CD, T, AC/SF/UN, Nbhd, Infl1, N Index, ADJ BASE, SAF, Topo, Lpi, VC, CREDIT AMT, ADJ VALUE.

Table with columns: TOTAL, 22,586 SF, ZONING, 1, FRNT, 0, ASSESSED, CURRENT, PREVIOUS.

Table with columns: TY, QUAL, COND, DIM/NOTE, YB, UNITS, ADJ PRICE, RCNLD, PHOTO 07/23/2019.

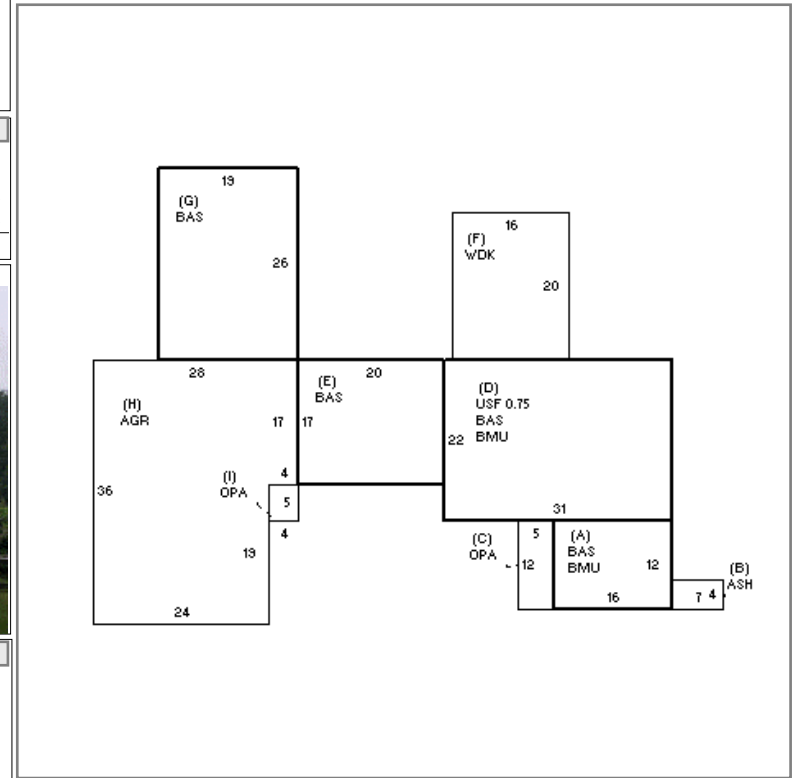

DETACHED

Table with columns: BUILDING, CD, ADJ, DESC, MEASURE, 7/23/2019, RP.

BUILDING

Table with columns: YEAR BLT, 1967, SIZE ADJ, 1.005, ELEMENT, CD, DESCRIPTION, ADJ, S, BAT, T, DESCRIPTION, UNITS, YB, ADJ PRICE, RCN.

Table with columns: TOTAL RCN, 544,127, CONDITION ELEM, CD, EFF.YR/AGE, 2006 / 16, COND, 13 13 %, FUNC, 0, ECON, 0, DEPR, 13 % GD, 87, RCNLD, \$473,400.