

Key: 9471

Town of Bourne - Fiscal Year 2024

12/18/2023 6:02 pm SEQ #: 9.689

LEGAL LAND

Table with columns: CURRENT OWNER, PARCEL ID, LOCATION, TRANSFER HISTORY, DOS, T, SALE PRICE, BK-PG (Cert). Includes owner names: COLLINS JOSEPH S ETUX, SUZANNE CALLAGY COLLINS.

Table with columns: CLASS, CLASS%, DESCRIPTION, BN ID, BN, CARD. Includes transaction details like PMT NO, PMT DT, TY, DESC, AMOUNT, INSP, BY, 1st, %.

Table with columns: CD, T, AC/SF/UN, Nbhd, Infl1, N Index, ADJ BASE, SAF, Topo, Lpi, VC, CREDIT AMT, ADJ VALUE.

Table with columns: TOTAL, 5,009 SF, ZONING, 1, FRNT, 0, ASSESSED, CURRENT, PREVIOUS. Includes breakdown for LAND, BUILDING, DETACHED, OTHER.

Table with columns: TY, QUAL, COND, DIM/NOTE, YB, UNITS, ADJ PRICE, RCNLD. Includes photo reference: PHOTO 05/03/2018.



Table with columns: BUILDING, CD, ADJ, DESC, MEASURE, 5/2/2018, TL. Includes model, style, quality, and frame details.

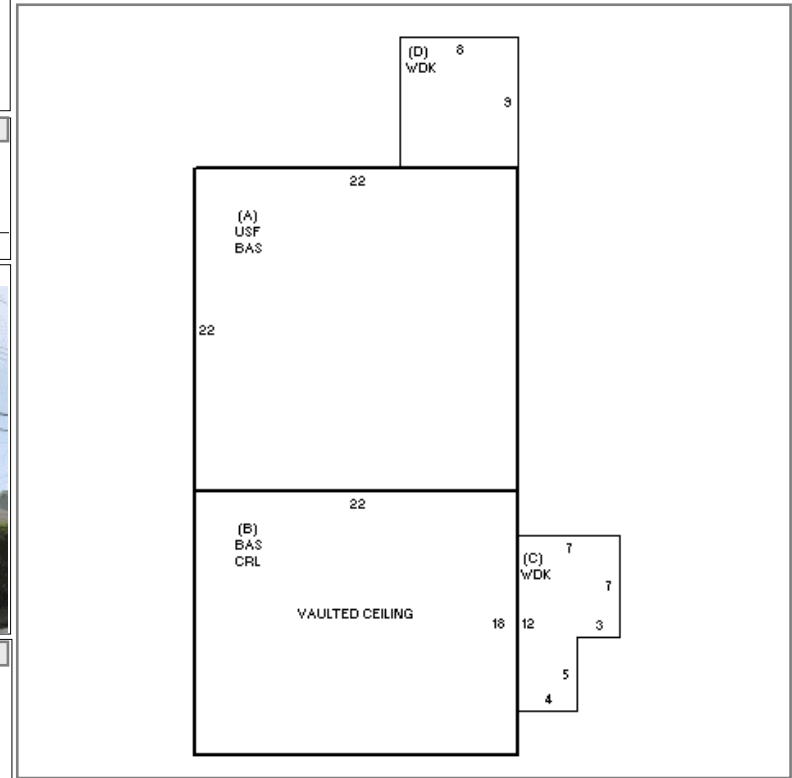

DETACHED

BUILDING

Large summary table with columns: YEAR BLT, NET AREA, SNLA(RCN), CAPACITY, UNITS, ADJ, ELEMENT, CD, DESCRIPTION, ADJ, S, BAT, T, DESCRIPTION, UNITS, YB, ADJ PRICE, RCN, RCN, TOTAL RCN, 287.007, CONDITION ELEM, CD, EFF.YR/AGE, 1995 / 27, COND, FUNC, ECON, DEPR, RCNLD, \$218,100.