

Key: 9485

Town of Bourne - Fiscal Year 2024

12/18/2023 6:02 pm SEQ #: 9.706

LEGALS AND

Table with columns: CURRENT OWNER, PARCEL ID, LOCATION, TRANSFER HISTORY, DOS, T, SALE PRICE, BK-PG (Cert). Includes owner info for SHINNEY ROBERT D & RUTH I TST and parcel details for 43.3-210-0.

Table with columns: CLASS, CLASS%, DESCRIPTION, BN ID, BN, CARD. Includes a list of transactions with PMT NO, PMT DT, TY, DESC, AMOUNT, INSP, BY, 1st, %.

LAND

Table with columns: TOTAL, 4,574 SF, ZONING, 1, FRNT, 0, ASSESSED, CURRENT, PREVIOUS. Includes sub-table for Nbd, Inf1, N\_Index and another for LAND, BUILDING, DETACHED, OTHER.

Table with columns: TY, QUAL, COND, DIM/NOTE, YB, UNITS, ADJ PRICE, RCNLD. Includes a row for SHF A 1.00 A 0.75 8 X 10.

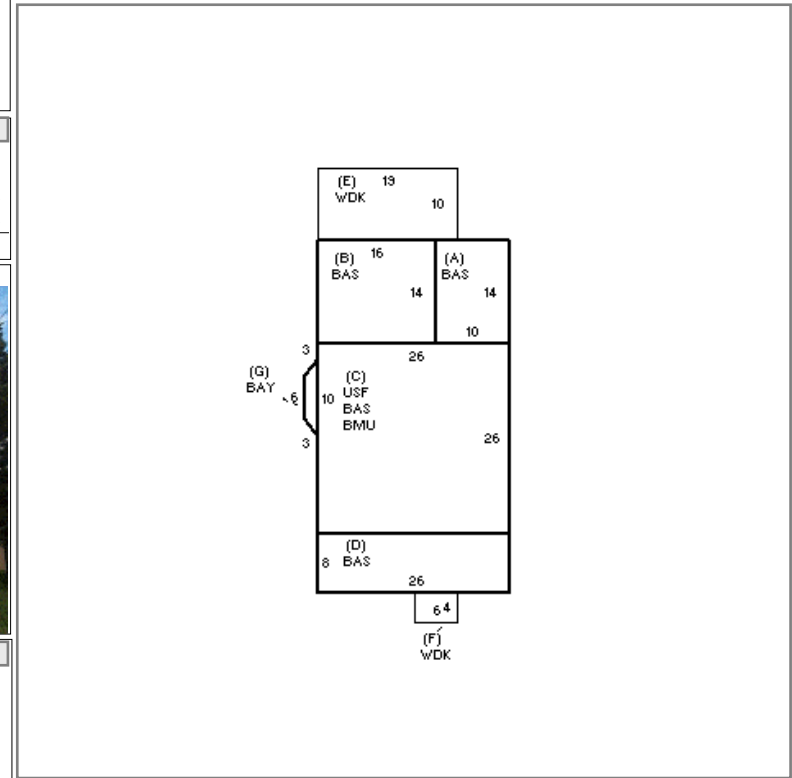

DETACHED

Table with columns: BUILDING, CD, ADJ, DESC, MEASURE, 10/10/2000, TL. Includes rows for MODEL, STYLE, QUALITY, FRAME.

BUILDING

Large summary table with columns: YEAR BLT, NET AREA, \$NLA(RCN), CAPACITY, UNITS, ADJ, ELEMENT, CD, DESCRIPTION, ADJ, S, BAT, T, DESCRIPTION, UNITS, YB, ADJ PRICE, RCN, TOTAL RCN, 391,468, CONDITION ELEM, CD, EFF.YR/AGE, 1995 / 27, COND, FUNC, ECON, DEPR, RCNLD, \$297,500.