

Key: 12656

Town of BREWSTER - Fiscal Year 2025

9/17/2024 2:15 pm SEQ #: 9.111

LEG  
AL  
LAND

CURRENT OWNER						PARCEL ID				LOCATION			
HERO ALAN W & PAMELA J 670 SATUCKET ROAD BREWSTER, MA 02631						24-72-0				670 SATUCKET ROAD			
TRANSFER HISTORY						DOS	T	SALE PRICE	BK-PG (Cert)				
HERO ALAN W & PAMELA J						05/05/2006	QS	1,037,500	20977-129				
RASMUSSEN ERIC K & JUNE B						03/16/1999	P	96,000	12130-018				
FRANKLIN VIVIAN C						07/19/1988	XX	1	6356-204				
CD	T	AC/SF/UN	Nbhd	St Ind	Infl	ADJ BASE	SAF	Topo	Lpi	VC	CREDIT AMT	ADJ VALUE	
100	S	60,000	12	1.00	A	1.00	A	1.00	1.00	PF3	1.70	515,690	
300	A	0.043	12	1.00	A	1.00	A	1.00	1.00	PF3	1.70	880	
350	A	0.090	12	1.00	A	1.00	A	1.00	1.00	TWP	1.00	190	

CLASS	CLASS%	DESCRIPTION			BN ID	BN	CARD	
1010	100	SINGLE FAMILY				1	1 of 1	
PMT NO	PMT DT	TY	DESC	AMOUNT	INSP	BY	1st	%
227	05/06/2003	8	YARD ITEMS	2,000			100	100
579	10/07/1999	5	OTHER	10,000	03/25/2000	LB	100	100
460	08/16/1999	5	OTHER	10,000	03/25/2000	LB	100	100
243	05/07/1999	1	NEW CONSTRUCT	275,000	03/25/2000	LB	100	100

DE  
TA  
CH  
ED

TOTAL	1.510 Acres	ZONING	RL	FRNT	150	ASSESSED	CURRENT	PREVIOUS
Nbhd	NBHD 12	N O T E	SUBDIV OF LOT 36 FOR F/Y 2000 LOT 3 ON PLAN			LAND	516,800	487,500
St Ind	AVERAGE		543/86			BUILDING	1,008,600	963,700
Infl	AVERAGE					DETACHED	0	0
						OTHER	0	0
					TOTAL	1,525,400	1,451,200	

PH  
OTO

TY	QUAL	COND	DIM/NOTE	YB	UNITS	ADJ PRICE	RCNLD

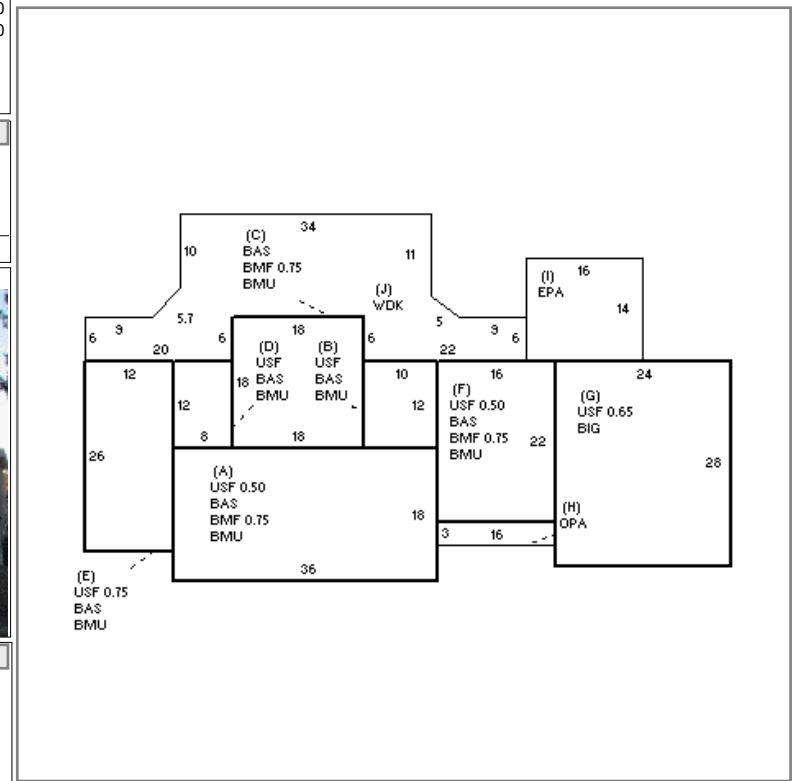

BL  
UD  
ING

BUILDING	CD	ADJ	DESC	MEASURE	11/28/2017	NF
MODEL	1		RESIDENTIAL	LIST	12/28/2017	EST
STYLE	4	1.02	CAPE [100%]	REVIEW	12/26/2017	TD
QUALITY	G	1.30	GOOD [100%]			
FRAME	1	1.00	WD FRAME [100%]			

BLDG COMMENTS

IL  
D  
IN  
G

YEAR BLT	2000	SIZE ADJ	0.980	ELEMENT	CD	DESCRIPTION	ADJ	S	BAT	T	DESCRIPTION	UNITS	YB	ADJ PRICE	RCN	TOTAL RCN	1,215,176														
NET AREA	3,239	DETAIL ADJ	1.000	FOUNDATION	4	FLR & WALL	1.00	+	BMU	N	BSMT UNFINISHED	1,852		67.96	125,864																
\$NLA(RCN)	\$375	OVERALL	1.070	EXT COVER	1	WD SHINGLE	1.00	+	BMF	N	BSMT FINISH	993		48.53	48,190																
				ROOF SHAPE	1	GABLE	1.00	+	BAS	L	BASE AREA	1,852	2000	315.86	584,977																
				ROOF COVER	1	ASPH/CMP SH	1.00	+	USF	L	UPPER STORY FIN	1,387	2000	230.16	319,231																
				FLOOR COVER	1	HARDWOOD	1.00	G	BIG	N	BUILT-IN GARAGE	672		64.83	43,566																
				INT FINISH	2	DRYWALL	1.00	H	OPA	N	OPEN PORCH	48		68.16	3,272																
				HEATING/COOL	11	HTWT/CL AIR	1.05	I	EPA	N	ENCLOSED PORCH	224		98.76	22,123																
				FUEL SOURCE	2	GAS	1.00	J	WDK	N	WOOD DECK	742		53.44	39,650																
									F21	O	FPL 2S 10P	1		13,837.60	13,838																
<table border="1"> <thead> <tr> <th>CONDITION ELEM</th> <th>CD</th> </tr> </thead> <tbody> <tr> <td>EXTERIOR</td> <td>A</td> </tr> <tr> <td>INTERIOR</td> <td>A</td> </tr> <tr> <td>KITCHEN</td> <td>A</td> </tr> <tr> <td>BATHS</td> <td>A</td> </tr> <tr> <td>HEAT/ELEC</td> <td>A</td> </tr> </tbody> </table>																	CONDITION ELEM	CD	EXTERIOR	A	INTERIOR	A	KITCHEN	A	BATHS	A	HEAT/ELEC	A			
CONDITION ELEM	CD																														
EXTERIOR	A																														
INTERIOR	A																														
KITCHEN	A																														
BATHS	A																														
HEAT/ELEC	A																														
<table border="1"> <thead> <tr> <th>EFF.YR/AGE</th> <td colspan="2">2000 / 23</td> </tr> </thead> <tbody> <tr> <td>COND</td> <td>17</td> <td>17 %</td> </tr> <tr> <td>FUNC</td> <td>0</td> <td></td> </tr> <tr> <td>ECON</td> <td>0</td> <td></td> </tr> <tr> <td>DEPR</td> <td>17</td> <td>% GD 83</td> </tr> </tbody> </table>																	EFF.YR/AGE	2000 / 23		COND	17	17 %	FUNC	0		ECON	0		DEPR	17	% GD 83
EFF.YR/AGE	2000 / 23																														
COND	17	17 %																													
FUNC	0																														
ECON	0																														
DEPR	17	% GD 83																													
<table border="1"> <thead> <tr> <th>RCNLD</th> <td>\$1,008,600</td> </tr> </thead> </table>																	RCNLD	\$1,008,600													
RCNLD	\$1,008,600																														