

Key: 12830

Town of BREWSTER - Fiscal Year 2025

9/17/2024 2:15 pm SEQ #: 9.178

LEGALS

Table with columns: CURRENT OWNER, PARCEL ID, LOCATION, TRANSFER HISTORY, DOS, T, SALE PRICE, BK-PG (Cert), MORIN AFSANEH G TRUSTEE & MALINOWSKI AFSANEH G & MO, YAVINSKY RITA M TRUSTEE

Table with columns: CLASS, CLASS%, DESCRIPTION, BN ID, BN, CARD, PMT NO, PMT DT, TY, DESC, AMOUNT, INSP, BY, 1st, %

LAND

Table with columns: CD, T, AC/SF/UN, Nbhd, St Ind, Infl, ADJ BASE, SAF, Topo, Lpi, VC, CREDIT AMT, ADJ VALUE, TOTAL, ZONING, RL, FRNT, 0, ASSESSED, CURRENT, PREVIOUS

Table with columns: TY, QUAL, COND, DIM/NOTE, YB, UNITS, ADJ PRICE, RCNLD, PHOTO 06/04/2024

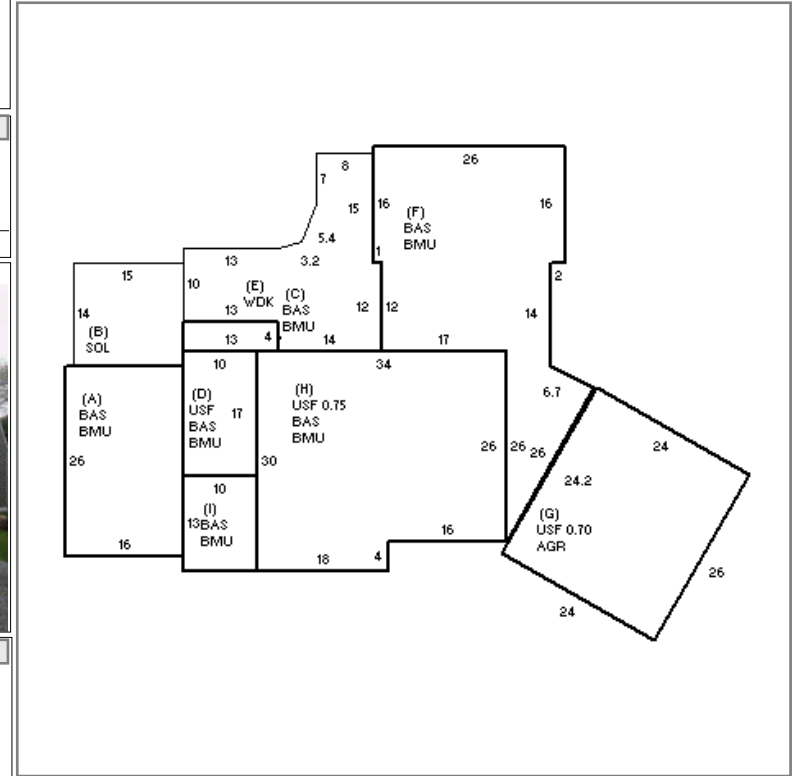

DETACHED

Table with columns: BUILDING, CD, ADJ, DESC, MEASURE, 1/14/2021, TCK, MODEL, STYLE, QUALITY, FRAME

Table with columns: BLDG COMMENTS, INFO @ DOOR 1/14/2021

BUILDING

Table with columns: YEAR BLT, SIZE ADJ, 0.970, NET AREA, 3,905, DETAIL ADJ, 1.000, \$NLA(RCN), \$344, OVERALL, 1.050, CAPACITY, UNITS, ADJ, ELEMENT, CD, DESCRIPTION, ADJ, S, BAT, T, DESCRIPTION, UNITS, YB, ADJ PRICE, RCN, TOTAL RCN, 1,342,512, CONDITION ELEM, CD, EXTERIOR, INTERIOR, KITCHEN, BATHS, HEAT/ELEC, EFF.YR/AGE, 2007 / 16, COND, 13 13 %, FUNC, 0, ECON, 0, DEPR, 13 % GD, 87, RCNLD, \$1,168,000