

Key: 1637

Town of BREWSTER - Fiscal Year 2025

9/17/2024 2:15 pm SEQ #: 1.780

LEGALS

| CURRENT OWNER   |  |  |  | PARCEL ID  |   |            |              | LOCATION         |  |  |  |
|---|--|--|--|------------|---|------------|--------------|------------------|--|--|--|
| REMY JANE M TRUSTEE<br>JOHNSON ELISABETH REMY TRUSTEE<br>175 A P NEWCOMB ROAD<br>BREWSTER, MA 02631 |  |  |  | 78-96-0    |   |            |              | 2520 MAIN STREET |  |  |  |
| TRANSFER HISTORY  |  |  |  | DOS        | T | SALE PRICE | BK-PG (Cert) |                  |  |  |  |
| REMY JANE M TRUSTEE   |  |  |  | 12/04/2009 | A | 100        | 24215-1      |                  |  |  |  |
| REMY JANE M TRUSTEE   |  |  |  | 12/04/2009 | A | 100        | 24214-328    |                  |  |  |  |
| REMY JANE M   |  |  |  | 08/03/2005 | F |            | 20120-328    |                  |  |  |  |

| CLASS  | CLASS%     | DESCRIPTION   |              |         | BN ID      | BN  | CARD   |     |
|--------|------------|---------------|--------------|---------|------------|-----|--------|-----|
| 1010   | 100        | SINGLE FAMILY |              |         |            | 1   | 1 of 1 |     |
| PMT NO | PMT DT     | TY            | DESC         | AMOUNT  | INSP       | BY  | 1st    | %   |
| 863    | 10/04/2018 | 7             | ALTERATIONS  | 10,000  | 07/29/2019 | NF  | 100    | 100 |
| 700    | 08/13/2018 | 7             | ALTERATIONS  | 50,000  | 07/29/2019 | NF  | 100    | 100 |
| 659    | 08/20/2014 | 1             | NEW CONSTRUC |         | 05/27/2015 | MW  | 100    | 100 |
| 659    | 08/20/2014 | 2             | ADD          | 200,000 | 04/14/2016 | WFF | 100    | 100 |
| SS2013 |            | 13            | SPLIT/SUB/LA |         | 12/31/2011 |     | 100    | 100 |

LAND

| CD  | T | AC/SF/UN | Nbhd | St Ind | Infl | ADJ BASE | SAF | Topo | Lpi     | VC   | CREDIT AMT | ADJ VALUE |     |      |  |         |
|-----|---|----------|------|--------|------|----------|-----|------|---------|------|------------|-----------|-----|------|--|---------|
| 100 | S | 60,000   | 10   | 1.00   | A    | 1.00     | A   | 1.00 | 219,200 | 1.00 | A          | 1.00      | R03 | 1.00 |  | 303,350 |
| 300 | A | 0.354    | 10   | 1.00   | A    | 1.00     | A   | 1.00 | 12,000  | 1.00 | A          | 1.00      | R03 | 1.00 |  | 4,250   |

|        |             |  |          |         |         |          |         |          |
|--------|-------------|--|----------|---------|---------|----------|---------|----------|
| TOTAL  | 1.731 Acres | ZONING   | RM       | FRNT    | 0       | ASSESSED | CURRENT | PREVIOUS |
| Nbhd   | NBHD 10     | NOTE<br>For FY 13 Parcel A on PB 642/12 added. | LAND     | 307,600 | 290,200 |          |         |          |
| St Ind | AVERAGE     |  | BUILDING | 349,200 | 329,800 |          |         |          |
| Infl   | AVERAGE     |  | DETACHED | 26,000  | 25,800  |          |         |          |
|        |             |  | OTHER    | 0       | 0       |          |         |          |
|        |             |  | TOTAL    | 682,800 | 645,800 |          |         |          |

DETAILED

| TY  | QUAL | COND | DIM/NOTE | YB    | UNITS | ADJ PRICE | RCNLD  | PHOTO |
|-----|------|------|----------|-------|-------|-----------|--------|-------|
| LBN | +    | 1.10 | 20 0.80  | 18X18 | 324   | 20.13     | 5,200  |       |
| SHF | A    | 1.00 | 30 0.70  | 12X17 | 204   | 19.84     | 2,800  |       |
| SHF | A    | 1.00 | 30 0.70  | 8X30  | 240   | 19.84     | 3,300  |       |
| DGF | A    | 1.00 | 30 0.70  | 26X30 | 780   | 26.84     | 14,700 |       |

| BUILDING | CD | ADJ  | DESC              | MEASURE | 12/6/2007 | JH  |
|----------|----|------|-------------------|---------|-----------|-----|
| MODEL    | 1  |      | RESIDENTIAL       | LIST    | 12/6/2007 | JH  |
| STYLE    | 7  | 1.05 | CONVEN/OLD [100%] | REVIEW  | 8/6/2019  | EMZ |
| QUALITY  | +  | 1.10 | PLUS AVE [100%]   |         |           |     |
| FRAME    | 1  | 1.00 | WD FRAME [100%]   |         |           |     |

| YEAR BLT   | 1880  | SIZE ADJ   | 1.000 | ELEMENT      | CD | DESCRIPTION   | ADJ  | S | BAT | T | DESCRIPTION     | UNITS | YB   | ADJ PRICE | RCN     | TOTAL RCN | 563.305 |
|------------|-------|------------|-------|--------------|----|---------------|------|---|-----|---|-----------------|-------|------|-----------|---------|-----------|---------|
| NET AREA   | 1,983 | DETAIL ADJ | 1.000 | FOUNDATION   | 4  | FLR & WALL    | 1.00 | + | BAS | L | BASE AREA       | 1,426 | 1880 | 281.67    | 401,663 |           |         |
| \$NLA(RCN) | \$284 | OVERALL    | 1.060 | EXT COVER    | 1  | WD SHINGLE    | 1.00 | B | BAS | L | BASE AREA       | 49    | 2014 | 281.67    | 13,802  |           |         |
|            |       |            |       | ROOF SHAPE   | 1  | GABLE         | 1.00 | + | BMU | N | BSMT UNFINISHED | 170   |      | 77.94     | 13,250  |           |         |
|            |       |            |       | ROOF COVER   | 1  | ASPH/CMP SH   | 1.00 | + | USF | L | UPPER STORY FIN | 508   | 1880 | 216.55    | 110,010 |           |         |
|            |       |            |       | FLOOR COVER  | 2  | SOFTWOOD      | 1.00 | + | OPA | N | OPEN PORCH      | 72    |      | 58.30     | 4,198   |           |         |
|            |       |            |       | INT FINISH   | 2  | DRYWALL       | 1.00 | H | CRL | N | BSMT CRAWL      | 198   |      | 35.40     | 7,010   |           |         |
|            |       |            |       | HEATING/COOL | 15 | HTWT+DCTLS AC | 1.01 | I | WDK | N | WOOD DECK       | 32    |      | 45.69     | 1,462   |           |         |
|            |       |            |       | FUEL SOURCE  | 1  | OIL           | 1.00 | O | ODS | O | OUTDOOR SHOWER  | 1     |      | 2,815.90  | 2,816   |           |         |

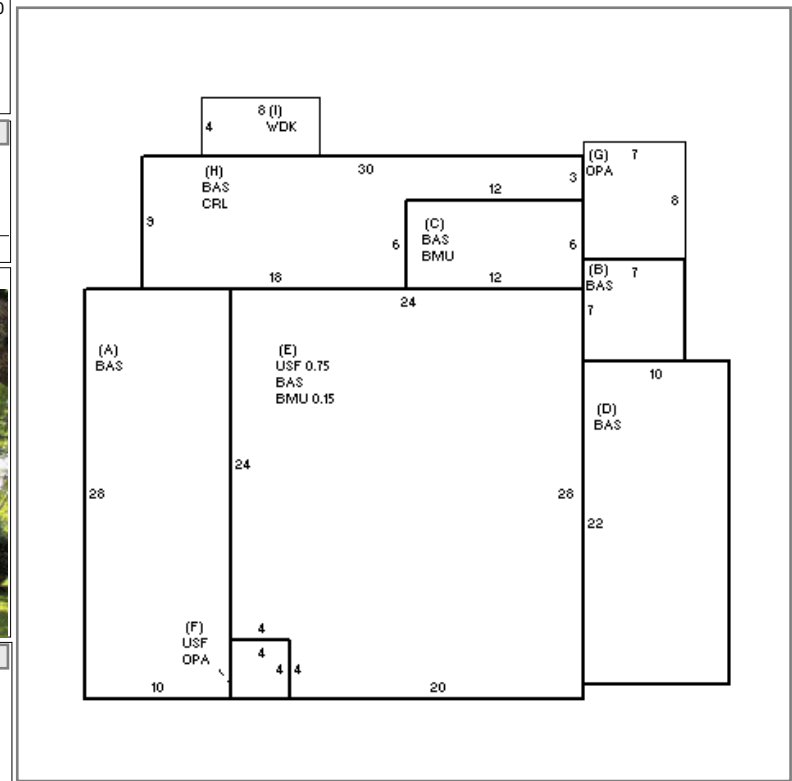

BUILDING

|                |            |
|----------------|------------|
| CONDITION ELEM | CD         |
| EXTERIOR       | G          |
| INTERIOR       | A          |
| KITCHEN        | A          |
| BATHS          | A          |
| HEAT/ELEC      | A          |
| EFF.YR/AGE     | 1957 / 66  |
| COND           | 38 38 %    |
| FUNC           | 0          |
| ECON           | 0          |
| DEPR           | 38 % GD 62 |
| RCNLD          | \$349,200  |