

Key: 21

Town of BREWSTER - Fiscal Year 2025

9/17/2024 2:15 pm SEQ #: 17

LEGALS

CURRENT OWNER				PARCEL ID				LOCATION			
FERRAGUTO PAIGE E & ROBINSON SARAH E 230 HOLLY AVENUE BREWSTER, MA 02631				37-9-21				433 PAINES CREEK ROAD			
TRANSFER HISTORY				DOS	T	SALE PRICE	BK-PG (Cert)				
FERRAGUTO PAIGE E & ROBINSON				05/03/2019	A	230,000	31997-70				
FERRAGUTO ANDREW S & EDWIN T NADEAU				11/21/1994	QS	62,500	9453-313				
				01/11/1989	F	100	N/A-N/A				

CLASS	CLASS%	DESCRIPTION			BN ID	BN	CARD	
1020	100	CONDOMINIUM				1	1 of 1	
PMT NO	PMT DT	TY	DESC	AMOUNT	INSP	BY	1st	%
23-159	02/15/2023	7	ALTERATIONS	6,000	05/07/2024	NF	100	100
055	04/10/2018	5	OTHER	2,500	04/10/2018	JMG	100	100
	02/17/1995	2	ADD					

LAND

CD	T	AC/SF/UN	Nbhd	St Ind	Infl	ADJ BASE	SAF	Topo	Lpi	VC	CREDIT AMT	ADJ VALUE

TOTAL	SF	ZONING	RM	FRNT	0	ASSESSED	CURRENT	PREVIOUS
Nbhd		NOTE				LAND	0	0
St Ind			BUILDING	447,100	422,200			
Infl			DETACHED	0	0			
			OTHER	0	0			
						TOTAL	447,100	422,200

DETACHED

TY	QUAL	COND	DIM/NOTE	YB	UNITS	ADJ PRICE	RCNLD	PHOTO	05/21/2024
									

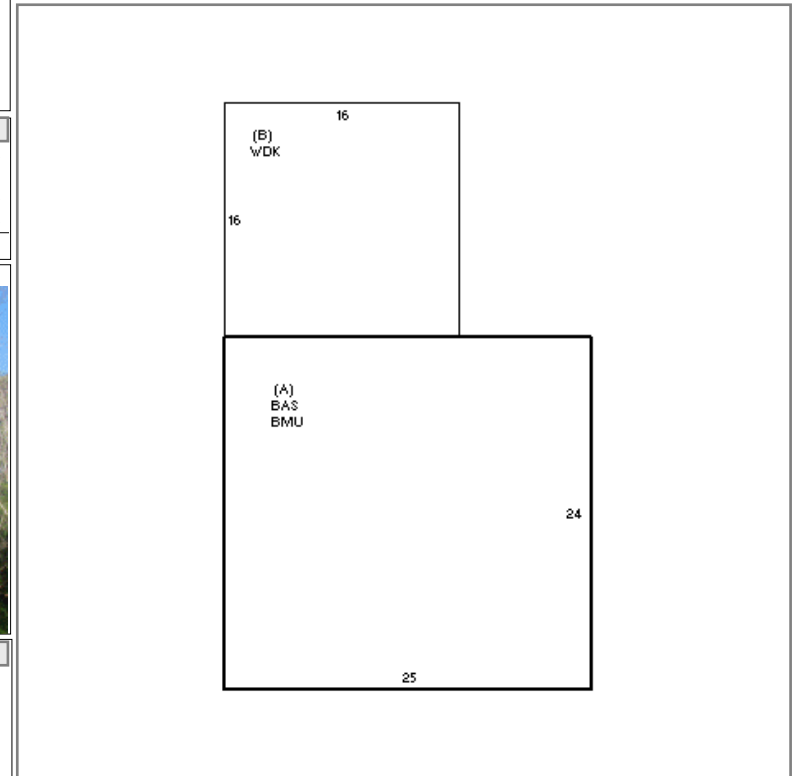

BUILDING

BUILDING	CD	ADJ	DESC	MEASURE	3/15/2018	NF
MODEL	10		CONDO RES	LIST	3/15/2018	EST
STYLE	3	1.00	DUPLEX [100%]	REVIEW	5/21/2024	EMZ
QUALITY	A	1.00	AVG [100%]	BLDG COMMENTS		
FRAME	1	1.00	N/A [100%]	BUILDING E - OUTDOOR SHOWER		

BUILDING

YEAR BLT	1960	SIZE ADJ	1.000	ELEMENT	CD	DESCRIPTION	ADJ	S	BAT	T	DESCRIPTION	UNITS	YB	ADJ PRICE	RCN	TOTAL RCN	545,286																								
NET AREA	600	DETAIL ADJ	2.950	COMPLEX	7	GULL COLONY	2.95	A	BMU	N	BSMT UNF	600		47.60	28,560	CONDITION ELEM	CD																								
\$NLA(RCN)	\$909	OVERALL	1.000	STYLE	26	07-GULL	1.00	A	BAS	L	BASE AREA	600	1960	832.58	499,548			INTERIOR	A																						
				VIEW/LOC	1	NONE	1.00	B	WDK	N	WOOD DECK	256		33.90	8,678	KITCHEN	A																								
				HVAC	1	FORCED AIR	1.00									BATHS	A																								
				END/MIDDLE	1	END	1.00									EXTERIOR	A																								
				<table border="1"> <thead> <tr> <th>CAPACITY</th> <th>UNITS</th> <th>ADJ</th> </tr> </thead> <tbody> <tr> <td>ROOMS</td> <td>2</td> <td>1.00</td> </tr> <tr> <td>BEDROOMS</td> <td>1</td> <td>1.00</td> </tr> <tr> <td>BATHS</td> <td>1</td> <td>1.00</td> </tr> <tr> <td>HALF BATHS</td> <td>0</td> <td>1.00</td> </tr> <tr> <td>FIREPLACES</td> <td>1</td> <td>\$3,300</td> </tr> <tr> <td>% COMMON OWNER</td> <td>12</td> <td>1.00</td> </tr> <tr> <td>FIXTURES</td> <td>4</td> <td>\$5,200</td> </tr> </tbody> </table>														CAPACITY	UNITS	ADJ	ROOMS	2	1.00	BEDROOMS	1	1.00	BATHS	1	1.00	HALF BATHS	0	1.00	FIREPLACES	1	\$3,300	% COMMON OWNER	12	1.00	FIXTURES	4	\$5,200
CAPACITY	UNITS	ADJ																																							
ROOMS	2	1.00																																							
BEDROOMS	1	1.00																																							
BATHS	1	1.00																																							
HALF BATHS	0	1.00																																							
FIREPLACES	1	\$3,300																																							
% COMMON OWNER	12	1.00																																							
FIXTURES	4	\$5,200																																							
																EFF.YR/AGE	1966 / 57																								
																COND	18 18 %																								
																FUNC	0																								
																ECON	0																								
																DEPR	18 % GD 82																								
																RCNLD	\$447,100																								