

Key: 2355

Town of BREWSTER - Fiscal Year 2025

9/17/2024 2:15 pm SEQ #: 2.512

LEGAL

LAND

DETACHED

BUILDING

CURRENT OWNER		PARCEL ID		LOCATION	
WONG-SOMMER MARY L 354 STONY BROOK ROAD BREWSTER, MA 02631		15-63-0		354 STONY BROOK ROAD	
TRANSFER HISTORY		DOS	T	SALE PRICE	BK-PG (Cert)
WONG-SOMMER MARY L		11/15/2010	QS	530,000	24997-100
BRIDGWOOD RICHARD A & DIA		05/12/1976	XX		2337-147

CLASS	CLASS%	DESCRIPTION		BN ID	BN	CARD	
1010	100	SINGLE FAMILY			1	1 of 1	
PMT NO	PMT DT	TY	DESC	AMOUNT	INSP	BY	1st %
855	10/26/2017	2	ADD	325,000	07/11/2019	NF	100 100
FY19-11	06/23/2017	13	SPLIT/SUB/LA	1	07/11/2018	JMG	100 100
485	08/13/2001	3	OUT BUILDING	1,600			100 100

CD	T	AC/SF/UN	Nbhd	St Ind	Infl	ADJ BASE	SAF	Topo	Lpi	VC	CREDIT AMT	ADJ VALUE			
100	S	60,000	12	1.00	12M	1.00	A	1.00	252,080	1.00	A	1.00	RM5	1.15	348,850
300	A	1,217	12	1.00	12M	1.00	A	1.00	13,800	1.00	A	1.00	RM5	1.15	16,790

TOTAL	2.593 Acres	ZONING	RM	FRNT	0	ASSESSED	CURRENT	PREVIOUS
Nbhd	NBHD 12	N O T E	FY19 Lot 2 Plan Bk 328 Pg 11 & Lot 6B Plan Bk 670 Pg 87 (Deed Bk 30583 Pg 134)			LAND	365,600	344,900
St Ind	STONYBROOK		BUILDING	1,039,600	981,900			
Infl	AVERAGE		DETACHED	2,600	2,600			
			OTHER	0	0			
			TOTAL	1,407,800	1,329,400			

TY	QUAL	COND	DIM/NOTE	YB	UNITS	ADJ PRICE	RCNLD
SHF	A	1.00	30 0.70 6X8		48	22.94	800
SHF	A	1.00	30 0.70 10X12	2001	120	21.39	1,800



BLDG COMMENTS	INTERIOR ESTIMATED PER PLANS (02/01/18)
---------------	---

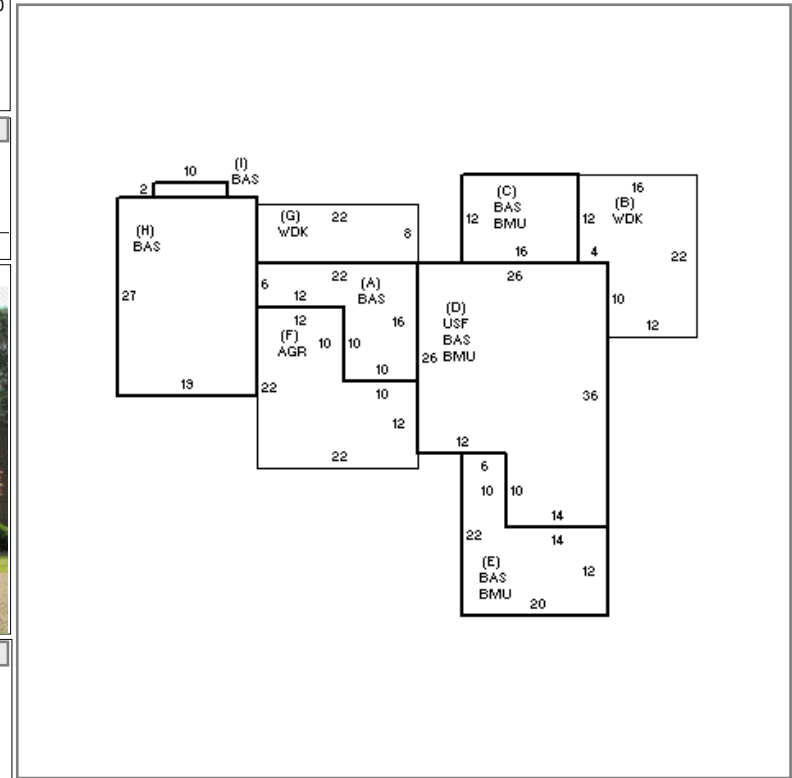

BUILDING	CD	ADJ	DESC	MEASURE	2/1/2018	NF
MODEL	1		RESIDENTIAL	LIST	1/22/2008	JH
STYLE	8	0.95	CONTEMPOR [100%]	REVIEW	7/17/2019	EMZ
QUALITY	G+	1.45	GOOD + [100%]			
FRAME	1	1.00	WD FRAME [100%]			

YEAR BLT	1977	SIZE ADJ	0.990	ELEMENT	CD	DESCRIPTION	ADJ	S	BAT	T	DESCRIPTION	UNITS	YB	ADJ PRICE	RCN	TOTAL RCN	1,039,581		
NET AREA	2,889	DETAIL ADJ	1.000	FOUNDATION	4	FLR & WALL	1.00	+	BAS	L	BASE AREA	765	2017	312.10	238,753	CONDITION ELEM	CD		
\$NLA(RCN)	\$360	OVERALL	0.980	EXT COVER	10	VERT BOARD	0.98	+	WDK	N	WOOD DECK	488		55.15	26,912	EXTERIOR	A		
CAPACITY		UNITS	ADJ	ROOF SHAPE	4	FLAT/SHED	1.00	+	BMU	N	BSMT UNFINISHED	1,308		76.44	99,988	INTERIOR	E		
STORIES	2	1.00		ROOF COVER	1	ASPH/CMP SH	1.00	+	BAS	L	BASE AREA	1,008	1977	312.10	314,593	KITCHEN	E		
ROOMS	8	1.00		FLOOR COVER	3	W/W CARPET	1.00	D	USF	L	UPPER STORY FIN	816	1977	256.00	208,893	BATHS	E		
BEDROOMS	4	1.00		INT FINISH	2	DRYWALL	1.00	E	BAS	L	BASE AREA	300	1977	312.10	93,629	HEAT/ELEC	E		
BATHROOMS	2	1.00		HEATING/COOL	11	HTWT/CL AIR	1.05	F	AGR	N	ATT GARAGE	384		58.21	22,351				
FIXTURES	11	\$20,320		FUEL SOURCE	1	OIL	1.00	F11	O	FPL 1S 1OP	1		10,743.70	10,744					
GARAGE SPACES	1	1.00						ODS	O	OUTDOOR SHOWER	1		3,397.40	3,397					
% BSMT FIN	0	1.00																	
# 1/2 BATHS	2	1.00																	
# OF UNITS	1	1.00																	
																EFF.YR/AGE	2023 / 0		
																COND	0 0 %		
																FUNC	0		
																ECON	0		
																DEPR	0	% GD	100
																RCNLD	\$1,039,600		