

Key: 2467

Town of BREWSTER - Fiscal Year 2025

9/17/2024 2:15 pm SEQ #: 2.624

LEG
A
L
L
A
N
D

CURRENT OWNER				PARCEL ID				LOCATION				
BOJANOWSKI GERALD ANTHONY & WOOD CYNTHIA J TRUSTEES 844 CHAPMAN LANE PETALUMA, CA 94952				5-40-0				81 PINE RIDGE ROAD				
TRANSFER HISTORY				DOS	T	SALE PRICE	BK-PG (Cert)					
BOJANOWSKI GERALD ANTHONY				01/02/2007	F	1 (182019)						
BOJANOWSKI GERALD A &				09/05/2002	QS	349,000 (166486)						
HEINTZ MARJORIE K				09/20/1999	QS	172,500 (154836)						
CD	T	AC/SF/UN	Nbhd	St Ind	Infl	ADJ BASE	SAF	Topo	Lpi	VC	CREDIT AMT	ADJ VALUE
100	S	26,875	12	1.00	12R 1.00	A	1.00					272,740

CLASS	CLASS%	DESCRIPTION			BN ID	BN	CARD	
1010	100	SINGLE FAMILY				1	1 of 1	
PMT NO	PMT DT	TY	DESC	AMOUNT	INSP	BY	1st	%
23-325	03/23/2023	7	ALTERATIONS	47,000	07/01/2024	TCK	100	100
842	11/15/2022	7	ALTERATIONS	6,000	03/23/2023	TCK	100	100
492	05/28/2019	77	SOLAR PANELS	32,076	12/18/2019	MR	100	100
NP	02/25/2008	12	CYCLICAL NON		02/25/2008	JH	100	100
169	04/07/2003	2	ADD	65,000	06/25/2004	WH	100	100

D
E
T
A
C
H
E
D

TOTAL	26,877 SF	ZONING	RM	FRNT	0	ASSESSED	CURRENT	PREVIOUS
Nbhd	NBHD 12	N O T E	Small portion of lot in Dennis			LAND	272,700	257,300
St Ind	AIRLINE		BUILDING	700,300	606,800			
Infl	AVERAGE		DETACHED	0	0			
			OTHER	0	0			
			TOTAL	973,000	864,100			

TY	QUAL	COND	DIM/NOTE	YB	UNITS	ADJ PRICE	RCNLD

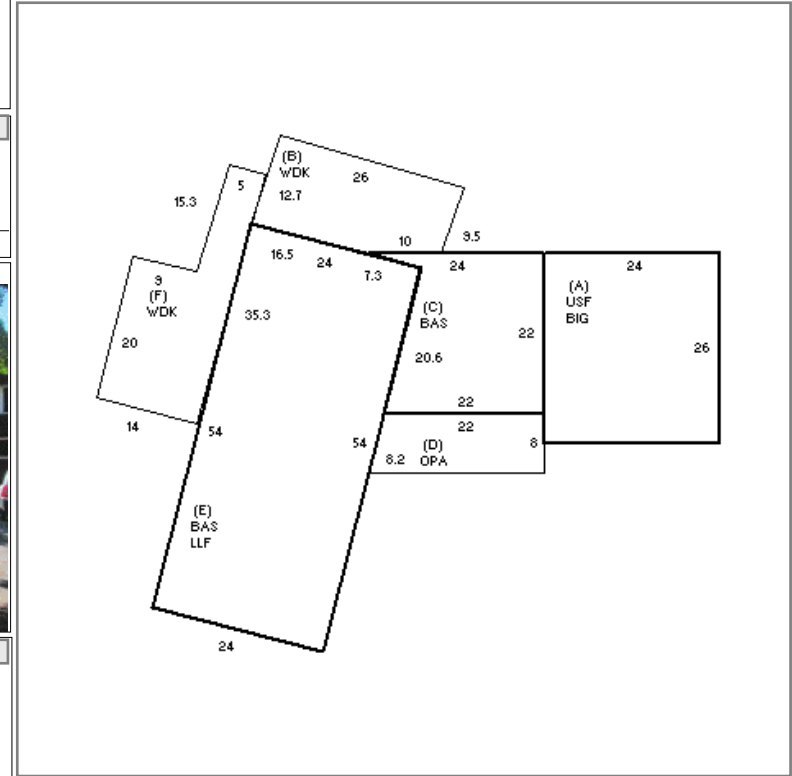

B
U
I
L
D
I
N
G

BUILDING	CD	ADJ	DESC	MEASURE	2/8/2018	NF
MODEL	1		RESIDENTIAL	LIST	9/26/2023	EST
STYLE	1	1.00	RANCH [100%]	REVIEW	7/25/2024	EMZ
QUALITY	A+	1.20	AVG + [100%]			
FRAME	1	1.00	WD FRAME [100%]			

BLDG COMMENTS
BASEMENT HAS KITCHEN
27 SOLAR PANELS; 4 Bedrooms per BOH 9/26/2023

YEAR BLT	1973	SIZE ADJ	0.970	ELEMENT	CD	DESCRIPTION	ADJ	S	BAT	T	DESCRIPTION	UNITS	YB	ADJ PRICE	RCN	TOTAL RCN	946,343
NET AREA	3,647	DETAIL ADJ	1.000	FOUNDATION	4	FLR & WALL	1.00	A	BIG	N	BUILT-IN GARAGE	624		58.13	36,270	CONDITION ELEM	CD
\$NLA(RCN)	\$259	OVERALL	1.050	EXT COVER	1	WD SHINGLE	1.00	A	USF	L	UPPER STORY FIN	624	2003	224.70	140,212	EXTERIOR	A
				ROOF SHAPE	1	GABLE	1.00	+	WDK	N	WOOD DECK	673		47.91	32,244	INTERIOR	A
				ROOF COVER	1	ASPH/CMP SH	1.00	C	BAS	L	BASE AREA	431	2003	289.22	124,655	KITCHEN	A
				FLOOR COVER	3	W/W CARPET	1.00	D	OPA	N	OPEN PORCH	184		61.11	11,244	BATHS	A
				INT FINISH	2	DRYWALL	1.00	E	LLF	L	LOWER LEVEL FIN	1,296	1973	144.10	186,750	HEAT/ELEC	A
				HEATING/COOL	11	HTWT/CL AIR	1.05	E	BAS	L	BASE AREA	1,296	1973	289.22	374,830		
				FUEL SOURCE	2	GAS	1.00	GFP	O		GAS FIREPLACE	1		3,820.60	3,821		
								KIT	O		XTRA KITCHEN	1		2,652.20	2,652		
								MST	O		MAS/METAL STACK	1		6,144.00	6,144		
								ODS	O		OUTDOOR SHOWER	1		2,951.60	2,952		
																EFF.YR/AGE	1982 / 41
																COND	26 26 %
																FUNC	0
																ECON	0
																DEPR	26 % GD 74
																RCNLD	\$700,300