

Key: 2492

Town of BREWSTER - Fiscal Year 2025

9/17/2024 2:15 pm SEQ #: 2.649

LEGAL

LAND

DETACHED

BUILDING

| CURRENT OWNER | | | | PARCEL ID | | | | LOCATION | | | |
|---|--|--|--|------------|----|------------|--------------|---------------------|--|--|--|
| DOUGLASS JILLIAN D 53 PEBBLE PATH LANE BREWSTER, MA 02631 | | | | 15-11-0 | | | | 53 PEBBLE PATH LANE | | | |
| TRANSFER HISTORY | | | | DOS | T | SALE PRICE | BK-PG (Cert) | | | | |
| DOUGLASS JILLIAN D | | | | 03/28/2016 | O | 419,900 | 29537-326 | | | | |
| CHAMBERLAIN BARBARA C | | | | 08/08/1986 | XX | 168,000 | 5236-146 | | | | |

| CLASS | CLASS% | DESCRIPTION | | | BN ID | BN | CARD | |
|---------|------------|---------------|-------------|--------|------------|-----|--------|-----|
| 1010 | 100 | SINGLE FAMILY | | | | 1 | 1 of 1 | |
| PMT NO | PMT DT | TY | DESC | AMOUNT | INSP | BY | 1st | % |
| 23-1103 | 10/25/2023 | 7 | ALTERATIONS | 20,000 | 06/07/2024 | TCK | 100 | 100 |
| 23-813 | 07/18/2023 | 7 | ALTERATIONS | 2,000 | 06/07/2024 | TCK | 100 | 100 |
| 152 | 02/19/2021 | 7 | ALTERATIONS | 3,600 | 05/06/2022 | TCK | 100 | 100 |
| 726 | 10/22/2020 | 7 | ALTERATIONS | 3,450 | 12/29/2020 | NF | 100 | 100 |
| 619 | 07/12/2016 | 7 | ALTERATIONS | 1,200 | 03/02/2017 | NF | 100 | 100 |

| CD | T | AC/SF/UN | Nbhd | St Ind | Infl | ADJ BASE | SAF | Topo | Lpi | VC | CREDIT AMT | ADJ VALUE |
|-----|---|----------|------|--------|----------|----------|---------|------|--------|----------|------------|-----------|
| 100 | S | 25,151 | 12 | 1.00 | 12M 1.00 | A 1.00 | 252,080 | 1.85 | A 1.00 | R06 1.15 | | 268,720 |

| | | | | | | | | |
|--------|------------|--------|----------|------|---------|----------|---------|----------|
| TOTAL | 25,151 SF | ZONING | RM | FRNT | 0 | ASSESSED | CURRENT | PREVIOUS |
| Nbhd | NBHD 12 | NOTE | LAND | | 268,700 | 253,500 | | |
| St Ind | STONYBROOK | | BUILDING | | 486,900 | 459,700 | | |
| Infl | AVERAGE | | DETACHED | | 1,300 | 1,300 | | |
| | | | OTHER | | 0 | 0 | | |
| | | | TOTAL | | 756,900 | 714,500 | | |

| TY | QUAL | COND | DIM/NOTE | YB | UNITS | ADJ PRICE | RCNLD |
|-----|------|------|---------------|----|-------|-----------|-------|
| SHF | A | 1.00 | 50 0.50 10X12 | | 120 | 21.39 | 1,300 |

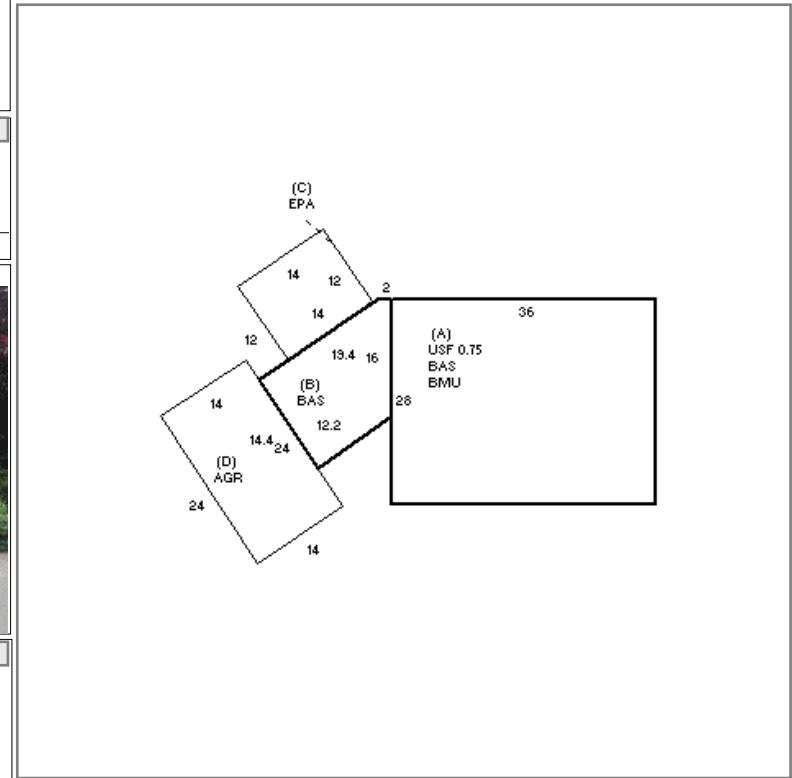

| BUILDING | CD | ADJ | DESC | MEASURE | 1/3/2018 | NF |
|----------|----|------|-----------------|---------|-----------|-----|
| MODEL | 1 | | RESIDENTIAL | LIST | 2/26/2008 | JH |
| STYLE | 4 | 1.02 | CAPE [100%] | REVIEW | 6/14/2024 | EMZ |
| QUALITY | + | 1.10 | PLUS AVE [100%] | | | |
| FRAME | 1 | 1.00 | WD FRAME [100%] | | | |

| BLDG COMMENTS |
|---------------|
| |

| YEAR BLT | 1979 | SIZE ADJ | 1.000 |
|---------------|-------|------------|---------|
| NET AREA | 2,007 | DETAIL ADJ | 1.000 |
| \$NLA(RCN) | \$307 | OVERALL | 1.020 |
| CAPACITY | | UNITS | ADJ |
| STORIES | | 1.75 | 1.00 |
| ROOMS | | 7 | 1.00 |
| BEDROOMS | | 3 | 1.00 |
| BATHROOMS | | 2 | 1.00 |
| FIXTURES | | 6 | \$8,752 |
| GARAGE SPACES | | 1 | 1.00 |
| % BSMT FIN | | 0 | 1.00 |
| # 1/2 BATHS | | 0 | 1.00 |
| # OF UNITS | | 1 | 1.00 |

| ELEMENT | CD | DESCRIPTION | ADJ |
|--------------|----|-------------|------|
| FOUNDATION | 4 | FLR & WALL | 1.00 |
| EXT COVER | 1 | WD SHINGLE | 1.00 |
| ROOF SHAPE | 1 | GABLE | 1.00 |
| ROOF COVER | 1 | ASPH/CMP SH | 1.00 |
| FLOOR COVER | 3 | W/W CARPET | 1.00 |
| INT FINISH | 2 | DRYWALL | 1.00 |
| HEATING/COOL | 2 | HOT WATER | 1.00 |
| FUEL SOURCE | 1 | OIL | 1.00 |

| S | BAT | T | DESCRIPTION | UNITS | YB | ADJ PRICE | RCN |
|---|-----|---|-----------------|-------|------|-----------|---------|
| A | BMU | N | BSMT UNFINISHED | 1,008 | | 63.35 | 63,859 |
| + | BAS | L | BASE AREA | 1,251 | 1979 | 276.57 | 345,993 |
| A | USF | L | UPPER STORY FIN | 756 | 1979 | 206.28 | 155,946 |
| C | EPA | N | ENCLOSED PORCH | 168 | | 85.81 | 14,416 |
| D | AGR | N | ATT GARAGE | 336 | | 47.39 | 15,923 |
| | F21 | O | FPL 2S 1OP | 1 | | 11,389.40 | 11,389 |
| | GEN | O | GENERATOR | 1 | | 0.00 | |

| TOTAL RCN | 616,278 | |
|----------------|-----------|---------|
| CONDITION ELEM | CD | |
| EXTERIOR | A | |
| INTERIOR | G | |
| KITCHEN | V | |
| BATHS | A | |
| HEAT/ELEC | A | |
| EFF.YR/AGE | 1991 / 32 | |
| COND | 21 | 21 % |
| FUNC | 0 | |
| ECON | 0 | |
| DEPR | 21 | % GD 79 |
| RCNLD | \$486,900 | |