

Key: 271

Town of BREWSTER - Fiscal Year 2025

9/17/2024 2:15 pm SEQ #: 283

LEGALS

CURRENT OWNER						PARCEL ID				LOCATION					
BELL JONATHAN B TRUSTEE & FERNBACH DEBORAH S TRUSTEE 21 ROBIN ROAD WOODBIDGE, CT 06525						57-3-271				17 SAND DOLLAR LANE					
						TRANSFER HISTORY				DOS	T	SALE PRICE		BK-PG (Cert)	
						BELL JONATHAN B TRUSTEE & KING WILLIAM C				11/27/2013	QS	520,000 (C148-21)		1 (DOC# 913,207)	
KING WILLIAM C &				03/25/2003	A	267,000 (DOC# 713,671)									
KING WILLIAM C &				01/05/1998	QS										

CLASS	CLASS%	DESCRIPTION			BN ID	BN	CARD	
1020	100	CONDOMINIUM				1	1 of 1	
PMT NO	PMT DT	TY	DESC	AMOUNT	INSP	BY	1st	%
808	09/03/2021	7	ALTERATIONS	2,050	05/23/2022	TCK	100	100
36	01/22/1998	7	ALTERATIONS	21,000			100	100
446	10/06/1993	2	ADD	6,000	02/01/1994		100	100
299	10/17/1991	5	OTHER	3,400	02/01/1994		100	100

LAND

TOTAL	SF	ZONING	RL	FRNT	0	ASSESSED	CURRENT	PREVIOUS
Nbhd		NOTE				LAND	0	0
St Ind			LAND	949,700	896,700			
Infl			DETACHED	8,700	8,700			
			OTHER	0	0			
						TOTAL	958,400	905,400

DETACHED

TY	QUAL	COND	DIM/NOTE	YB	UNITS	ADJ PRICE	RCNLD	PHOTO
DGF	A	1.00	10 0.90 12X22	1984	264	36.79	8.700	05/23/2022

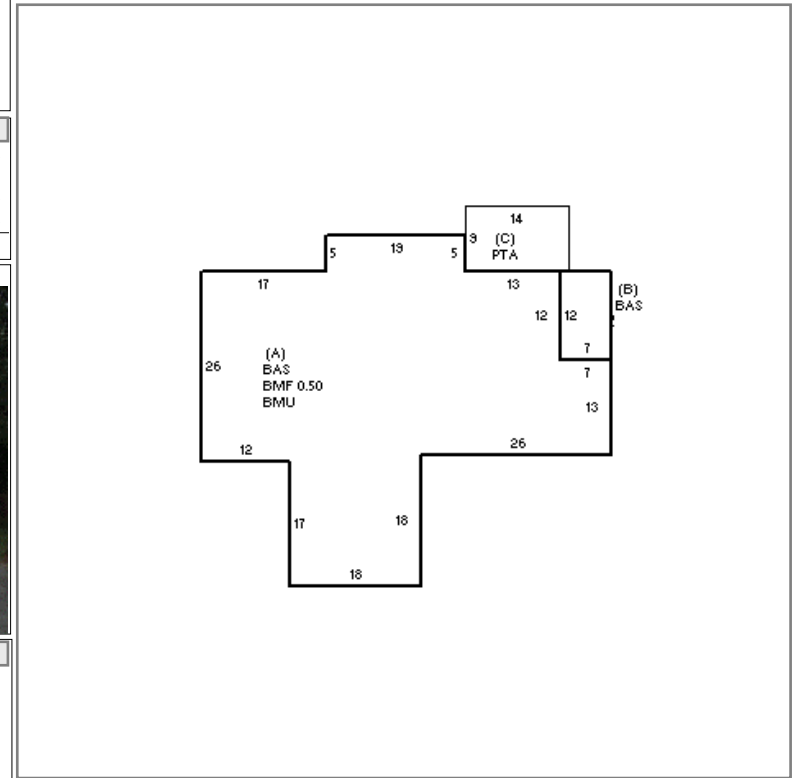

BUILDING

BUILDING	CD	ADJ	DESC	MEASURE	12/4/2008	SAM
MODEL	10		CONDO RES	LIST	12/4/2008	EST
STYLE	3	1.00	DUPLEX [100%]	REVIEW	6/10/2022	EMZ
QUALITY	A	1.00	AVG [100%]			
FRAME	1	1.00	N/A [100%]			

BLDG COMMENTS
BMF= 1rm/1bth

BUILDING

YEAR BLT	1984	SIZE ADJ	1.000	ELEMENT	CD	DESCRIPTION	ADJ	S	BAT	T	DESCRIPTION	UNITS	YB	ADJ PRICE	RCN	TOTAL RCN	1,010,271														
NET AREA	1,831	DETAIL ADJ	2.020	COMPLEX	4	SEARS POINT	2.00	A	BMU	N	BSMT UNF	1,747		47.60	83,157																
\$NLA(RCN)	\$552	OVERALL	1.000	STYLE	22	04-TERN	1.00	A	BMF	N	BSMT FIN-ADD	874		12.90	11,275																
				VIEW/LOC	1	NONE	1.00	+	BAS	L	BASE AREA	1,831	1984	491.11	899,214																
				HVAC	9	WARM/CL AIR	1.01	C	PTA	N	PATIO	126		12.90	1,625																
				END/MIDDLE	1	END	1.00																								
<table border="1"> <thead> <tr> <th>CONDITION ELEM</th> <th>CD</th> </tr> </thead> <tbody> <tr> <td>INTERIOR</td> <td>G</td> </tr> <tr> <td>KITCHEN</td> <td>G</td> </tr> <tr> <td>BATHS</td> <td>G</td> </tr> <tr> <td>EXTERIOR</td> <td>A</td> </tr> </tbody> </table>																	CONDITION ELEM	CD	INTERIOR	G	KITCHEN	G	BATHS	G	EXTERIOR	A					
CONDITION ELEM	CD																														
INTERIOR	G																														
KITCHEN	G																														
BATHS	G																														
EXTERIOR	A																														
<table border="1"> <thead> <tr> <th>EFF. YR/AGE</th> <td colspan="2">2003 / 20</td> </tr> </thead> <tbody> <tr> <td>COND</td> <td>6</td> <td>6 %</td> </tr> <tr> <td>FUNC</td> <td>0</td> <td></td> </tr> <tr> <td>ECON</td> <td>0</td> <td></td> </tr> <tr> <td>DEPR</td> <td>6</td> <td>% GD 94</td> </tr> </tbody> </table>																	EFF. YR/AGE	2003 / 20		COND	6	6 %	FUNC	0		ECON	0		DEPR	6	% GD 94
EFF. YR/AGE	2003 / 20																														
COND	6	6 %																													
FUNC	0																														
ECON	0																														
DEPR	6	% GD 94																													
<table border="1"> <thead> <tr> <th>RCNLD</th> <td>\$949,700</td> </tr> </thead> </table>																	RCNLD	\$949,700													
RCNLD	\$949,700																														