

Key: 2734

Town of BREWSTER - Fiscal Year 2025

9/17/2024 2:15 pm SEQ #: 2.903

LEGALS AND

Table with columns: CURRENT OWNER, PARCEL ID, LOCATION, TRANSFER HISTORY, DOS, T, SALE PRICE, BK-PG (Cert). Includes owner info for BURBANK ROSLYN TRUSTEE and transfer history for 1119 STONY BROOK ROAD.

Table with columns: CLASS, CLASS%, DESCRIPTION, BN ID, BN, CARD. Includes payment history for 398 NP and 301.

Table with columns: CD, T, AC/SF/UN, Nbhd, St Ind, Infl, ADJ BASE, SAF, Topo, Lpi, VC, CREDIT AMT, ADJ VALUE. Includes totals for 1.930 Acres and assessed values.

Table with columns: TY, QUAL, COND, DIM/NOTE, YB, UNITS, ADJ PRICE, RCNLD. Includes property details for GFU, DGF, OPA.

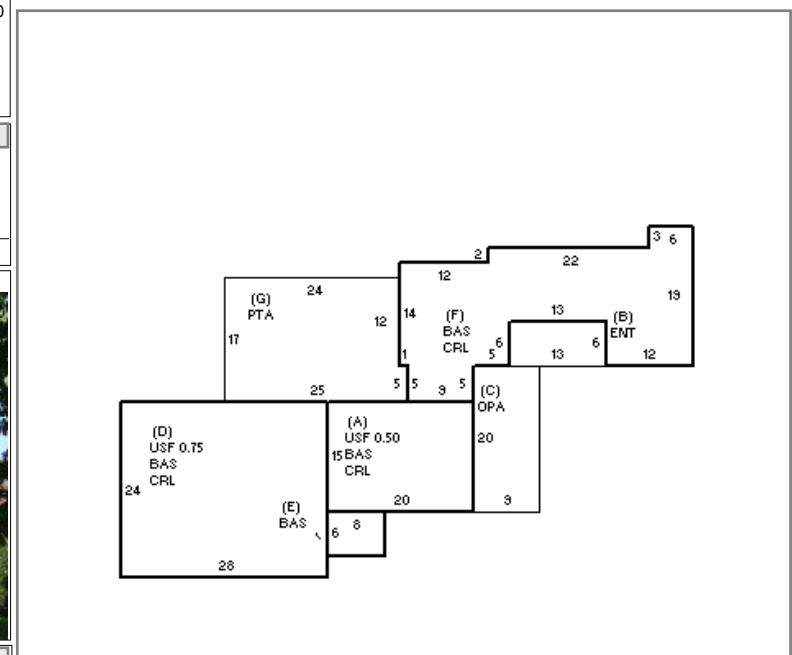

DETACHED

Table with columns: BUILDING, CD, ADJ, DESC, MEASURE, LIST, REVIEW. Includes building details like RESIDENTIAL, ANTIQUE [100%].

BLDG COMMENTS: Fixture in Laundry, Addition YB Estimated

BUILDING

Large table with columns: YEAR BLT, SIZE ADJ, ELEMENT, CD, DESCRIPTION, ADJ, S, BAT, T, DESCRIPTION, UNITS, YB, ADJ PRICE, RCN, TOTAL RCN, CONDITION ELEM, CD. Includes building capacity, element details, and a summary of RCN values.