

Key: 280

Town of BREWSTER - Fiscal Year 2025

9/17/2024 2:15 pm SEQ #: 292

LEG
A
L
L
A
N
D

CURRENT OWNER						PARCEL ID			LOCATION					
TURK JAY M & NAAMI SEIDMAN 6 MINUTEMAN ROAD SHARON, MA 02067						57-3-280			13 OYSTER LEAF LANE					
						TRANSFER HISTORY			DOS	T	SALE PRICE		BK-PG (Cert)	
						TURK JAY M & NAAMI SEIDMA			11/06/2023	QS	1,135,000 (C148-30)			
TYLDESLEY GLENN M TRUSTEE			04/21/2023	F	10 (C148-30)									
TYLDESLEY RICHARD & MAURE			08/01/2016	QS	712,500 (C148-30)									
CD	T	AC/SF/UN	Nbhd	St Ind	Infl	ADJ BASE	SAF	Topo	Lpi	VC	CREDIT AMT	ADJ VALUE		

CLASS	CLASS%	DESCRIPTION			BN ID	BN	CARD	
1020	100	CONDOMINIUM				1	1 of 1	
PMT NO	PMT DT	TY	DESC	AMOUNT	INSP	BY	1st	%
1034	11/06/2023	16	MLS REVIEW	1,135,000	06/24/2024	JMG	100	100
118	12/06/2018	7	ALTERATIONS	2,400	06/17/2019	NF	100	100
583	03/28/2011	7	ALTERATIONS	5,400	03/22/2012	MR	100	100
	10/27/2008	7	ALTERATIONS	22,000	04/12/2010	JH	100	100

D
E
T
A
C
H
E
D

TOTAL	SF	ZONING	RL	FRNT	0	ASSESSED	CURRENT	PREVIOUS
						LAND	0	0
						BUILDING	1,124,600	965,900
						DETACHED	8,700	8,700
						OTHER	0	0
						TOTAL	1,133,300	974,600

TY	QUAL	COND	DIM/NOTE	YB	UNITS	ADJ PRICE	RCNLD
DGF	A	1.00	10 0.90 12X22	1985	264	36.79	8,700

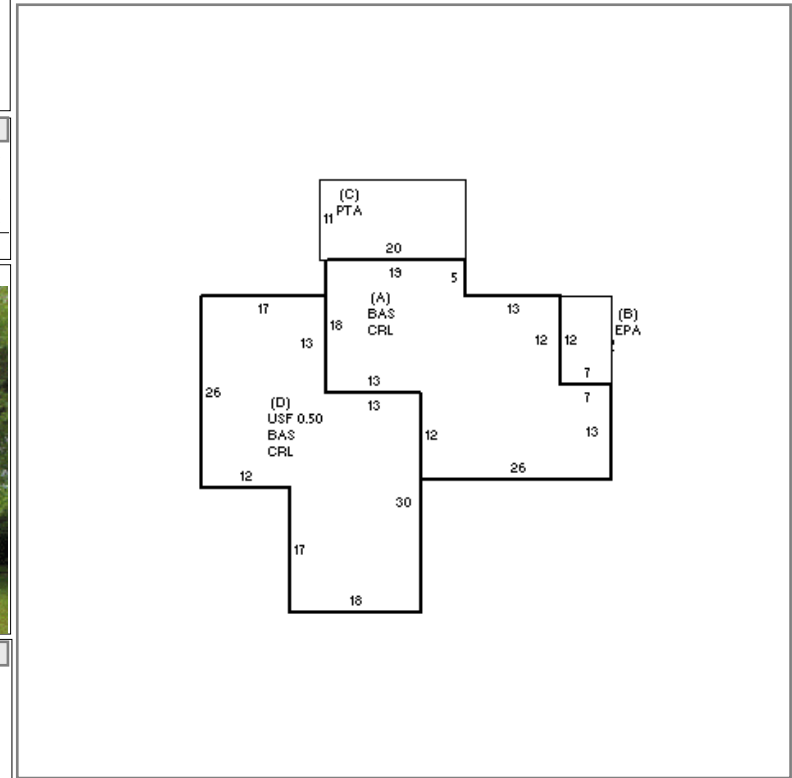

B
U
I
L
D
I
N
G

BUILDING	CD	ADJ	DESC	MEASURE	12/8/2008	SAM
MODEL	10		CONDO RES	LIST	3/10/2009	JH
STYLE	5	1.00	TRIPLEX [100%]	REVIEW	6/24/2024	JMG
QUALITY	A	1.00	AVG [100%]	BLDG COMMENTS ACCESS TO USF VIA CLOSET STAIRS		
FRAME	1	1.00	N/A [100%]			

YEAR BLT	1984	SIZE ADJ	1.000	ELEMENT	CD	DESCRIPTION	ADJ	S	BAT	T	DESCRIPTION	UNITS	YB	ADJ PRICE	RCN	TOTAL RCN	1,124,647															
NET AREA	2,206	DETAIL ADJ	2.020	COMPLEX	4	SEARS POINT	2.00	+	CRL	N	CRAWL	1,747		17.60	30,747																	
\$NLA(RCN)	\$510	OVERALL	1.000	STYLE	22	04-TERN	1.00	+	BAS	L	BASE AREA	1,747	1984	484.56	846,534																	
				VIEW/LOC	1	NONE	1.00	B	EPA	N	EN. PORCH	84		69.20	5,813																	
				HVAC	9	WARM/CL AIR	1.01	C	PTA	N	PATIO	220		12.90	2,838																	
				END/MIDDLE	1	END	1.00	D	USF	L	UPPER STORY	459	1984	484.56	222,415																	
				<table border="1"> <thead> <tr> <th>CONDITION ELEM</th> <th>CD</th> </tr> </thead> <tbody> <tr> <td>INTERIOR</td> <td>V</td> </tr> <tr> <td>KITCHEN</td> <td>V</td> </tr> <tr> <td>BATHS</td> <td>G</td> </tr> <tr> <td>EXTERIOR</td> <td>G</td> </tr> </tbody> </table>														CONDITION ELEM	CD	INTERIOR	V	KITCHEN	V	BATHS	G	EXTERIOR	G					
CONDITION ELEM	CD																															
INTERIOR	V																															
KITCHEN	V																															
BATHS	G																															
EXTERIOR	G																															
				<table border="1"> <thead> <tr> <th>EFF. YR/AGE</th> <td colspan="2">2021 / 2</td> </tr> </thead> <tbody> <tr> <td>COND</td> <td>0</td> <td>0 %</td> </tr> <tr> <td>FUNC</td> <td>0</td> <td></td> </tr> <tr> <td>ECON</td> <td>0</td> <td></td> </tr> <tr> <td>DEPR</td> <td>0</td> <td>% GD 100</td> </tr> </tbody> </table>														EFF. YR/AGE	2021 / 2		COND	0	0 %	FUNC	0		ECON	0		DEPR	0	% GD 100
EFF. YR/AGE	2021 / 2																															
COND	0	0 %																														
FUNC	0																															
ECON	0																															
DEPR	0	% GD 100																														
				<table border="1"> <thead> <tr> <th>RCNLD</th> <td>\$1,124,600</td> </tr> </thead> </table>														RCNLD	\$1,124,600													
RCNLD	\$1,124,600																															