

Key: 284

Town of BREWSTER - Fiscal Year 2025

9/17/2024 2:15 pm SEQ #: 296

LEGALS

CURRENT OWNER						PARCEL ID			LOCATION							
MACGILPIN GREGORY LLOYD & MACOMBER MELISSA DIXON 8 OYSTER LEAF LANE BREWSTER, MA 02631						57-3-284			8 OYSTER LEAF LANE							
						TRANSFER HISTORY			DOS	T	SALE PRICE	BK-PG (Cert)				
						MACGILPIN GREGORY LLOYD & MCDONALD MARY J			04/13/2020	QS	540,000	(C148-34)				
			11/03/2003	DC		(C148-34)										
			05/29/1985	XX		(DOC# 363,806)										

CLASS	CLASS%	DESCRIPTION			BN ID	BN	CARD	
1020	100	CONDOMINIUM				1	1 of 1	
PMT NO	PMT DT	TY	DESC	AMOUNT	INSP	BY	1st	%
	04/13/2020	15	SALE REVIEW	540,000	01/22/2021	JMG	100	100
345	04/25/2016	7	ALTERATIONS	25,000	04/10/2017	NF	100	100
65	01/31/2012	7	ALTERATIONS	6,000	02/05/2013	MR	100	100
512	11/04/1993	5	OTHER	3,900			100	100

LAND

CD	T	AC/SF/UN	Nbhd	St Ind	Infl	ADJ BASE	SAF	Topo	Lpi	VC	CREDIT AMT	ADJ VALUE

TOTAL	SF	ZONING	RL	FRNT	0	ASSESSED	CURRENT	PREVIOUS
						LAND	0	0
						BUILDING	800,100	755,400
						DETACHED	8,700	8,700
						OTHER	0	0
						TOTAL	808,800	764,100

DETACHED

TY	QUAL	COND	DIM/NOTE	YB	UNITS	ADJ PRICE	RCNLD
DGF	A	1.00	10 0.90	12X22 (1CAR)	1984	264	36.79
							8,700

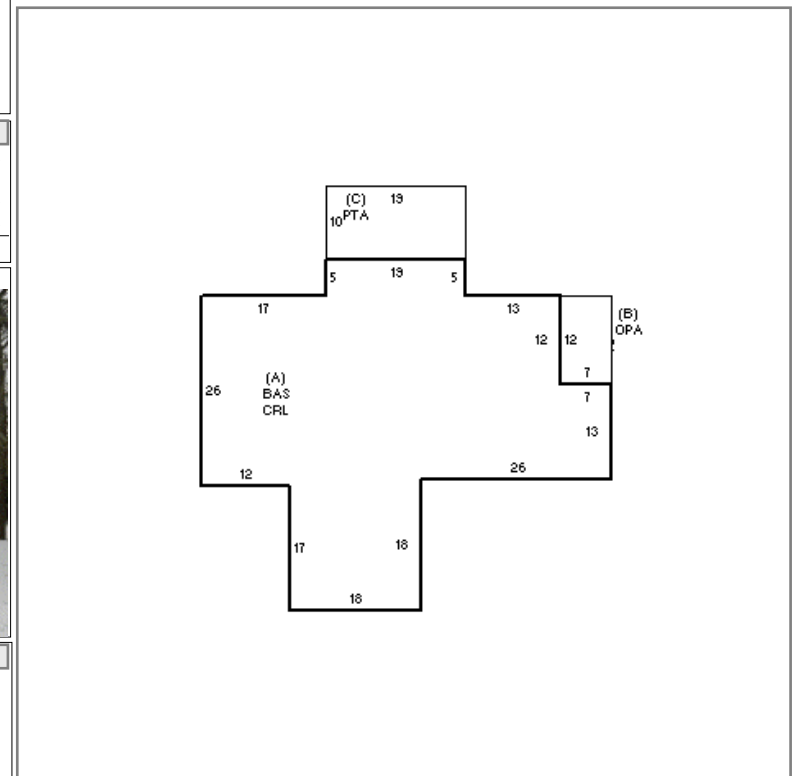

BUILDING

BUILDING	CD	ADJ	DESC	MEASURE	12/8/2008	SAM
MODEL	10		CONDO RES	LIST	12/8/2008	EST
STYLE	3	1.00	DUPLEX [100%]	REVIEW	6/8/2017	TD
QUALITY	A	1.00	AVG [100%]			
FRAME	1	1.00	N/A [100%]			

BLDG COMMENTS

G

YEAR BLT	1984	SIZE ADJ	1.000	ELEMENT	CD	DESCRIPTION	ADJ	S	BAT	T	DESCRIPTION	UNITS	YB	ADJ PRICE	RCN	TOTAL RCN	909,254														
NET AREA	1,747	DETAIL ADJ	2.020	COMPLEX	4	SEARS POINT	2.00	A	CRL	N	CRAWL	1,747		17.60	30,747																
\$NLA(RCN)	\$520	OVERALL	1.000	STYLE	22	04-TERN	1.00	A	BAS	L	BASE AREA	1,747	1984	493.12	861,478																
				VIEW/LOC	1	NONE	1.00	B	OPA	N	OPEN PORCH	84		41.40	3,478																
				HVAC	9	WARM/CL AIR	1.01	C	PTA	N	PATIO	190		12.90	2,451																
				END/MIDDLE	1	END	1.00																								
<table border="1" style="width: 100%;"> <thead> <tr> <th>CONDITION ELEM</th> <th>CD</th> </tr> </thead> <tbody> <tr> <td>INTERIOR</td> <td>A</td> </tr> <tr> <td>KITCHEN</td> <td>A</td> </tr> <tr> <td>BATHS</td> <td>A</td> </tr> <tr> <td>EXTERIOR</td> <td></td> </tr> </tbody> </table>																	CONDITION ELEM	CD	INTERIOR	A	KITCHEN	A	BATHS	A	EXTERIOR						
CONDITION ELEM	CD																														
INTERIOR	A																														
KITCHEN	A																														
BATHS	A																														
EXTERIOR																															
<table border="1" style="width: 100%;"> <thead> <tr> <th>EFF. YR/AGE</th> <td colspan="2">1984 / 39</td> </tr> </thead> <tbody> <tr> <td>COND</td> <td>12</td> <td>12 %</td> </tr> <tr> <td>FUNC</td> <td>0</td> <td></td> </tr> <tr> <td>ECON</td> <td>0</td> <td></td> </tr> <tr> <td>DEPR</td> <td>12</td> <td>% GD 88</td> </tr> </tbody> </table>																	EFF. YR/AGE	1984 / 39		COND	12	12 %	FUNC	0		ECON	0		DEPR	12	% GD 88
EFF. YR/AGE	1984 / 39																														
COND	12	12 %																													
FUNC	0																														
ECON	0																														
DEPR	12	% GD 88																													
RCNLD																\$800,100															