

Key: 3086

Town of BREWSTER - Fiscal Year 2025

9/17/2024 2:15 pm SEQ #: 3.282

LEGAL

LAND

DETAILED

BUILDING

CURRENT OWNER				PARCEL ID				LOCATION				
ESCHER MICHAEL C & WAHLSTROM MEIKA 20 DEPOT STREET BREWSTER, MA 02631				65-20-0				20 DEPOT STREET				
				TRANSFER HISTORY				DOS	T	SALE PRICE	BK-PG (Cert)	
				ESCHER MICHAEL C & SMITH DENNIS A TRUSTEE & SMITH DENNIS A &				12/17/2015	QS	750,000	29340-350	
								10/07/2011	F	25738-163		
								08/29/2011	F	1 25647-193		

CLASS	CLASS%	DESCRIPTION			BN ID	BN	CARD	
1010	100	SINGLE FAMILY				1	1 of 1	
PMT NO	PMT DT	TY	DESC	AMOUNT	INSP	BY	1st	%
24-314	04/01/2024	9	HVAC	30,000				0 0
23-1198	11/29/2023	2	ADD	100,000	07/11/2024	TCK	100	100
23-1036	10/26/2023	7	ALTERATIONS	6,874	07/11/2024	TCK	100	100
23-99	02/09/2023	7	ALTERATIONS	20,670	07/11/2024	TCK	100	100
		12	CYCLICAL NON		06/12/2013	SF	100	100

CD	T	AC/SF/UN	Nbhd	St Ind	Infl	ADJ BASE	SAF	Topo	Lpi	VC	CREDIT AMT	ADJ VALUE
100	S	60,000	13	1.00	A	1.00	A	1.00	R04	1.15		348,850
300	A	2,973	13	1.00	A	1.00	A	1.00	R04	1.15		41,030

TOTAL	4.350 Acres				ZONING	RM	FRNT	0	ASSESSED	CURRENT	PREVIOUS
Nbhd	NBHD 13				NOTE				LAND	389,900	367,800
St Ind	AVERAGE								BUILDING	908,900	814,500
Infl	AVERAGE								DETACHED	63,600	62,900
								OTHER	0	0	
								TOTAL	1,362,400	1,245,200	

TY	QUAL	COND	DIM/NOTE	YB	UNITS	ADJ PRICE	RCNLD
DBN	A	1.00	10 0.90 30X40		1,200	36.00	38,900
IPV	G	1.20	10 0.90 34X16	2009	544	44.37	21,700
PTD	G	1.20	20 0.80 16X12		192	10.26	1,600
SHF	A	1.00	20 0.80 10X8		80	22.01	1,400



BLDG COMMENTS
STABLE 30X40 100% COMPLETE W/ELEC, PLUMBING & BATHROOM

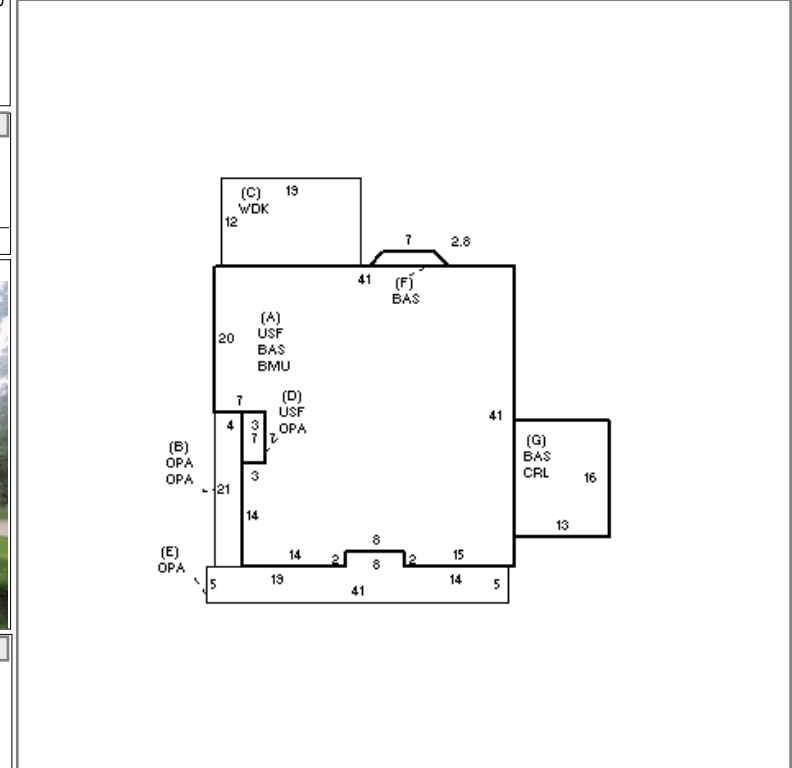

BUILDING	CD	ADJ	DESC	MEASURE	5/8/2019	REF
MODEL	1		RESIDENTIAL	LIST	6/5/2006	JB
STYLE	5	1.05	COLONIAL [100%]	REVIEW	7/29/2024	EMZ
QUALITY	G	1.30	GOOD [100%]			
FRAME	1	1.00	WD FRAME [100%]			

YEAR BLT	1991	SIZE ADJ	0.980	ELEMENT	CD	DESCRIPTION	ADJ	S	BAT	T	DESCRIPTION	UNITS	YB	ADJ PRICE	RCN	TOTAL RCN	1,081,972														
NET AREA	3,367	DETAIL ADJ	1.000	FOUNDATION	4	FLR & WALL	1.00	A	BMU	N	BSMT UNFINISHED	1,560		70.40	109,825																
\$NLA(RCN)	\$321	OVERALL	1.050	EXT COVER	1	WD SHINGLE	1.00	+	USF	L	UPPER STORY FIN	1,581	1991	215.82	341,210																
				ROOF SHAPE	2	HIP	1.00	+	OPA	N	OPEN PORCH	410		66.89	27,423																
				ROOF COVER	1	ASPH/CMP SH	1.00	C	WDK	N	WOOD DECK	228		52.44	11,956																
				FLOOR COVER	1	HARDWOOD	1.00	+	BAS	L	BASE AREA	1,578	1991	316.55	499,521																
				INT FINISH	2	DRYWALL	1.00	G	CRL	N	BSMT CRAWL	208		40.62	8,449																
				HEATING/COOL	2	HOT WATER	1.00	G	BAS	L	BASE AREA	208	2023	316.55	65,843																
				FUEL SOURCE	1	OIL	1.00																								
<table border="1"> <thead> <tr> <th>CONDITION ELEM</th> <th>CD</th> </tr> </thead> <tbody> <tr> <td>EXTERIOR</td> <td>G</td> </tr> <tr> <td>INTERIOR</td> <td>G</td> </tr> <tr> <td>KITCHEN</td> <td>A</td> </tr> <tr> <td>BATHS</td> <td>A</td> </tr> <tr> <td>HEAT/ELEC</td> <td>A</td> </tr> </tbody> </table>																	CONDITION ELEM	CD	EXTERIOR	G	INTERIOR	G	KITCHEN	A	BATHS	A	HEAT/ELEC	A			
CONDITION ELEM	CD																														
EXTERIOR	G																														
INTERIOR	G																														
KITCHEN	A																														
BATHS	A																														
HEAT/ELEC	A																														
<table border="1"> <thead> <tr> <th>EFF.YR/AGE</th> <td colspan="2">2001 / 22</td> </tr> </thead> <tbody> <tr> <td>COND</td> <td>16</td> <td>16 %</td> </tr> <tr> <td>FUNC</td> <td>0</td> <td></td> </tr> <tr> <td>ECON</td> <td>0</td> <td></td> </tr> <tr> <td>DEPR</td> <td>16</td> <td>% GD 84</td> </tr> </tbody> </table>																	EFF.YR/AGE	2001 / 22		COND	16	16 %	FUNC	0		ECON	0		DEPR	16	% GD 84
EFF.YR/AGE	2001 / 22																														
COND	16	16 %																													
FUNC	0																														
ECON	0																														
DEPR	16	% GD 84																													
<table border="1"> <thead> <tr> <th>RCNLD</th> <td>\$908,900</td> </tr> </thead> </table>																	RCNLD	\$908,900													
RCNLD	\$908,900																														