

Key: 3232

Town of BREWSTER - Fiscal Year 2025

9/17/2024 2:15 pm SEQ #: 3.429

LEGAL

LAND

DETACHED

BUILDING

CURRENT OWNER		PARCEL ID	LOCATION		
CAMARA REGINA 46 WOODVIEW DRIVE BREWSTER, MA 02631		76-34-3232	46 WOODVIEW DRIVE		
TRANSFER HISTORY		DOS	T	SALE PRICE	BK-PG (Cert)
CAMARA REGINA		12/05/2013	QS	182,000	27865-133
TENEDINI KENNETH JOHN		08/01/2012	F	1 26551-52	
TENEDINI KENNETH JOHN &		07/16/2012	F	26501-119	

CLASS	CLASS%	DESCRIPTION			BN ID	BN	CARD	
1020	100	CONDOMINIUM				1	1 of 1	
PMT NO	PMT DT	TY	DESC	AMOUNT	INSP	BY	1st	%
23-863	07/31/2023	7	ALTERATIONS	2,000	05/13/2024	TCK	100	100
281	05/05/2006	7	ALTERATIONS	2,837	08/02/2007	JH	100	100

CD	T	AC/SF/UN	Nbhd	St Ind	Infl	ADJ BASE	SAF	Topo	Lpi	VC	CREDIT AMT	ADJ VALUE

TOTAL	SF	ZONING	RL	FRNT	0	ASSESSED	CURRENT	PREVIOUS
Nbhd		NOTE				LAND	0	0
St Ind			BUILDING	367,800	302,700			
Infl			DETACHED	0	0			
			OTHER	0	0			
						TOTAL	367,800	302,700

TY	QUAL	COND	DIM/NOTE	YB	UNITS	ADJ PRICE	RCNLD



BUILDING	CD	ADJ	DESC	MEASURE	3/13/2008	SAL
MODEL	10		CONDO RES	LIST	3/13/2008	REF
STYLE	1	1.00	TOWN HOUSE [100%]	REVIEW	6/3/2024	EMZ
QUALITY	A	1.00	AVG [100%]			
FRAME	1	1.00	N/A [100%]			

ELEMENT	CD	DESCRIPTION	ADJ	S	BAT	T	DESCRIPTION	UNITS	YB	ADJ PRICE	RCN
COMPLEX	2	OAKWOOD	1.40	A	PTA	N	PATIO	182		12.90	2,348
STYLE	23	02-OAKWOOD	1.00	B	BAS	L	BASE AREA	576	1983	356.41	205,293
VIEW/LOC	1	NONE	1.00	B	USF	L	UPPER STORY	576	1983	356.41	205,293
HVAC	5	ELECTRIC BB	1.00								
END/MIDDLE	1	END	1.00								

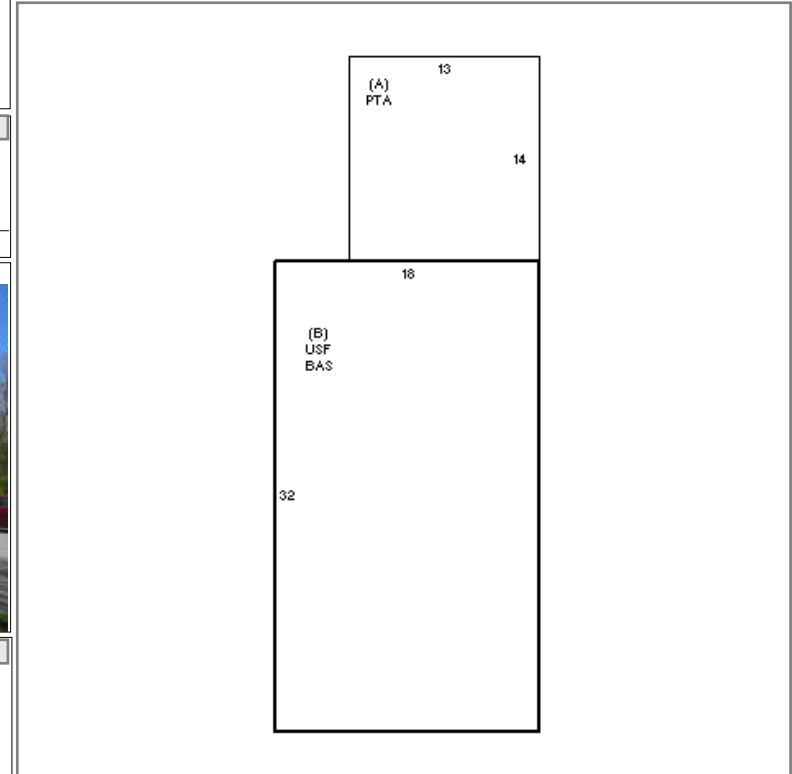

YEAR BLT	1983	SIZE ADJ	1.000
NET AREA	1,152	DETAIL ADJ	1.400
\$NLA(RCN)	\$367	OVERALL	1.000
CAPACITY		UNITS	ADJ
ROOMS	4	1.00	
BEDROOMS	2	1.00	
BATHS	1	1.00	
HALF BATHS	1	1.00	
FIREPLACES	1	\$3,300	
% COMMON OWNER	0	1.00	
FIXTURES	5	\$6,500	

TOTAL RCN	422,734	
CONDITION ELEM	CD	
INTERIOR	A	
KITCHEN	A	
BATHS	A	
EXTERIOR		
EFF.YR/AGE	1983 / 40	
COND	13	13 %
FUNC	0	
ECON	0	
DEPR	13	% GD 87
RCNLD	\$367,800	