

Key: 3245

Town of BREWSTER - Fiscal Year 2025

9/17/2024 2:15 pm SEQ #: 3.442

LEGAL

LAND

DETACHED

BUILDING

CURRENT OWNER		PARCEL ID	LOCATION		
BOSCO DEBORAH M 76 WOODVIEW DRIVE BREWSTER, MA 02631		76-34-3245	76 WOODVIEW DRIVE		
TRANSFER HISTORY		DOS	T	SALE PRICE	BK-PG (Cert)
BOSCO DEBORAH M		09/11/2006	QS	279,500	21338-013
MURRAY CARLETON E &		11/05/2002	A	1	15865-143
MURRAY ELIZABETH H		08/20/1984	XX	79,450	4220-001

CLASS	CLASS%	DESCRIPTION			BN ID	BN	CARD	
1020	100	CONDOMINIUM				1	1 of 1	
PMT NO	PMT DT	TY	DESC	AMOUNT	INSP	BY	1st	%
23-704	06/05/2023	7	ALTERATIONS	4,000	05/13/2024	TCK	100	100
553	07/10/2014	7	ALTERATIONS	5,000	05/16/2016	WFF	100	100

CD	T	AC/SF/UN	Nbhd	St Ind	Infl	ADJ BASE	SAF	Topo	Lpi	VC	CREDIT AMT	ADJ VALUE

TOTAL	SF	ZONING	RL	FRNT	0	ASSESSED	CURRENT	PREVIOUS
						LAND	0	0
						BUILDING	437,100	363,600
						DETACHED	0	0
						OTHER	0	0
						<b>TOTAL</b>	<b>437,100</b>	<b>363,600</b>

TY	QUAL	COND	DIM/NOTE	YB	UNITS	ADJ PRICE	RCNLD



BLDG COMMENTS

OUTDOOR SHOWER

BUILDING	CD	ADJ	DESC	MEASURE	3/13/2008	SAL
MODEL	10		CONDO RES	LIST	3/13/2008	EST
STYLE	1	1.00	TOWN HOUSE [100%]	REVIEW	6/3/2024	EMZ
QUALITY	A	1.00	AVG [100%]			
FRAME	1	1.00	N/A [100%]			

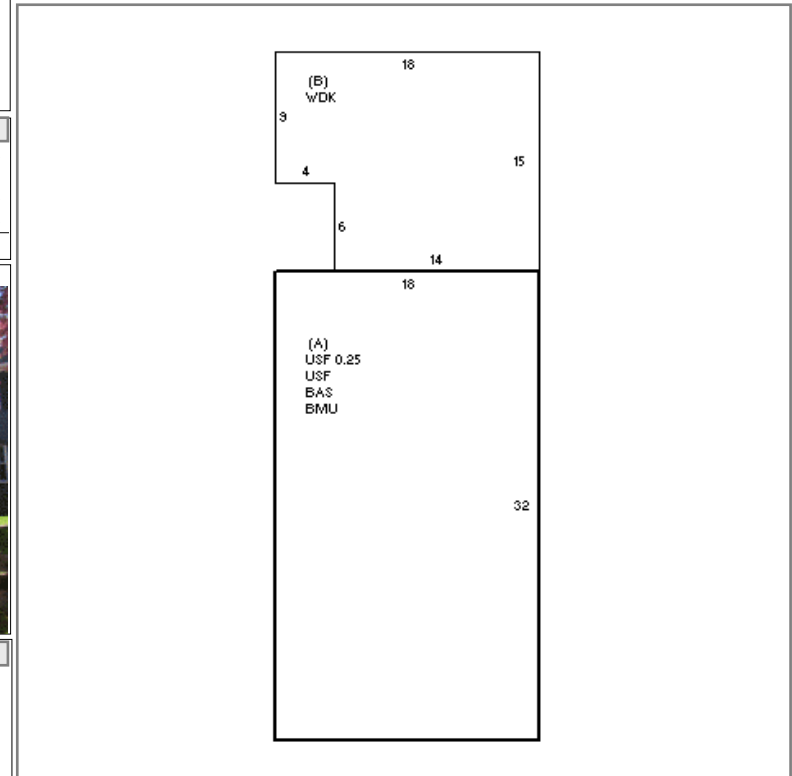

YEAR BLT	1983	SIZE ADJ	1.000	ELEMENT	CD	DESCRIPTION	ADJ	S	BAT	T	DESCRIPTION	UNITS	YB	ADJ PRICE	RCN
NET AREA	1,296	DETAIL ADJ	1.400	COMPLEX	2	OAKWOOD	1.40	A	BMU	N	BSMT UNF	576		47.60	27,418
\$NLA(RCN)	\$388	OVERALL	1.000	STYLE	23	02-OAKWOOD	1.00	A	BAS	L	BASE AREA	576	1983	351.53	202,481
				VIEW/LOC	1	NONE	1.00	+	USF	L	UPPER STORY	720	1983	351.53	253,102
				HVAC	5	ELECTRIC BB	1.00	B	WDK	N	WOOD DECK	246		33.90	8,339
				END/MIDDLE	1	END	1.00								
CAPACITY		UNITS	ADJ												
ROOMS		5	1.00												
BEDROOMS		2	1.00												
BATHS		1	1.00												
HALF BATHS		1	1.00												
FIREPLACES		1	\$3,300												
% COMMON OWNER		4.1	1.00												
FIXTURES		6	\$7,800												

TOTAL RCN	502,440
CONDITION ELEM	CD
INTERIOR	A
KITCHEN	A
BATHS	A
EXTERIOR	A
EFF.YR/AGE	1983 / 40
COND	13 13%
FUNC	0
ECON	0
DEPR	13 % GD 87
RCNLD	\$437,100