

Key: 3269

Town of BREWSTER - Fiscal Year 2025

9/17/2024 2:15 pm SEQ #: 3.466

LEGALS

CURRENT OWNER				PARCEL ID				LOCATION			
NAKASHIAN JANE F 85 P STREET SOUTH BOSTON, MA 02127				76-34-3269				113 WOODVIEW DRIVE			
TRANSFER HISTORY				DOS	T	SALE PRICE	BK-PG (Cert)				
NAKASHIAN JANE F				09/04/2020	F		1 ()				
NAKASHIAN JANE F TRUSTEE				04/25/2019	J		1 ()				
NAKASHIAN JANE F & RICHA				07/09/1990	A		1 7219-276				

CLASS	CLASS%	DESCRIPTION			BN ID	BN	CARD	
1020	100	CONDOMINIUM				1	1 of 1	
PMT NO	PMT DT	TY	DESC	AMOUNT	INSP	BY	1st	%

LAND

CD	T	AC/SF/UN	Nbhd	St Ind	Infl	ADJ BASE	SAF	Topo	Lpi	VC	CREDIT AMT	ADJ VALUE

TOTAL	SF	ZONING	RL	FRNT	0	ASSESSED	CURRENT	PREVIOUS
						LAND	0	0
						BUILDING	407,000	334,900
						DETACHED	0	0
						OTHER	0	0
						<b>TOTAL</b>	<b>407,000</b>	<b>334,900</b>

DETACHED

TY	QUAL	COND	DIM/NOTE	YB	UNITS	ADJ PRICE	RCNLD



BLDG COMMENTS

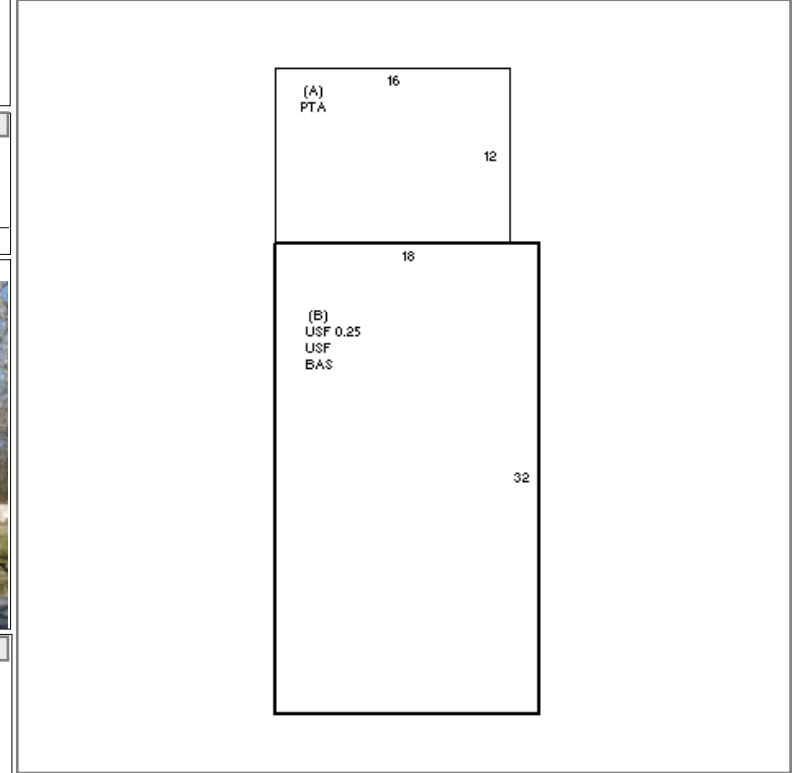

BUILDING

BUILDING	CD	ADJ	DESC	MEASURE	3/13/2008	SAL
MODEL	10		CONDO RES	LIST	3/13/2008	EST
STYLE	1	1.00	TOWN HOUSE [100%]	REVIEW	7/15/2008	SEJ
QUALITY	A	1.00	AVG [100%]			
FRAME	1	1.00	N/A [100%]			

G

YEAR BLT	1983	SIZE ADJ	1.000	ELEMENT	CD	DESCRIPTION	ADJ	S	BAT	T	DESCRIPTION	UNITS	YB	ADJ PRICE	RCN	TOTAL RCN	467.860		
NET AREA	1,296	DETAIL ADJ	1.400	COMPLEX	2	OAKWOOD	1.40	A	PTA	N	PATIO	192		12.90	2,477	CONDITION ELEM	CD		
\$NLA(RCN)	\$361	OVERALL	1.000	STYLE	23	02-OAKWOOD	1.00	B	BAS	L	BASE AREA	576	1983	351.53	202,481	INTERIOR	A		
				VIEW/LOC	1	NONE	1.00	B	USF	L	UPPER STORY	720	1983	351.53	253,102	KITCHEN	A		
				HVAC	5	ELECTRIC BB	1.00									BATHS	A		
				END/MIDDLE	1	END	1.00									EXTERIOR	A		
CAPACITY		UNITS	ADJ																
ROOMS		5	1.00																
BEDROOMS		2	1.00																
BATHS		1	1.00																
HALF BATHS		1	1.00																
FIREPLACES		1	\$3,300																
% COMMON OWNER		1.85	1.00																
FIXTURES		5	\$6,500																
																EFF.YR/AGE	1983 / 40		
																COND	13 13%		
																FUNC	0		
																ECON	0		
																DEPR	13	% GD	87
																RCNLD	\$407,000		