

Key: 4790

Town of BREWSTER - Fiscal Year 2025

9/17/2024 2:15 pm SEQ #: 5.005

LEGALS

CURRENT OWNER		PARCEL ID		LOCATION	
MUSCAT ANGELA M TRUSTEE SKAKET AIRE NOMINEE TRUST 36 PELL'S FISHING ROAD BREWSTER, MA 02631		125-56-0		36 PELL'S FISHING ROAD	
TRANSFER HISTORY		DOS	T	SALE PRICE	BK-PG (Cert)
MUSCAT ANGELA M TRUSTEE		06/08/1998	F	100 (148848)	
MUSCAT ANGELA M		05/06/1994	QS	186,000 (133720)	
EIZENBERG DANIEL A & MICH		01/19/1989	QS	66,667 (116619)	

CLASS	CLASS%	DESCRIPTION		BN ID	BN	CARD	
1010	100	SINGLE FAMILY			1	1 of 1	
PMT NO	PMT DT	TY	DESC	AMOUNT	INSP	BY	1st %
456	08/21/2008	2	ADD	4,000	03/28/2009	JH	100 100
101	03/15/2005	2	ADD	90,000	05/16/2006	JB	100 100
537	09/13/2004	2	ADD	75,000	05/16/2006	JB	100 100
215	04/19/1994	5	OTHER	3,000			100 100

LAND

CD	T	AC/SF/UN	Nbhd	St Ind	Infl	ADJ BASE	SAF	Topo	Lpi	VC	CREDIT AMT	ADJ VALUE
100	S	29,796 9	1.00 9-B	1.00 A	1.00	241,120	1.62	A	1.00 R06	1.10		267,770

TOTAL	29,795 SF	ZONING	RM	FRNT	0	ASSESSED	CURRENT	PREVIOUS
Nbhd	NBHD 9	NOTE				LAND	267,800	252,600
St Ind	OWL POND		BUILDING	656,300	619,900			
Infl	AVERAGE		DETACHED	2,100	2,000			
			OTHER	0	0			
TOTAL						926,200	874,500	

DETACHED

TY	QUAL	COND	DIM/NOTE	YB	UNITS	ADJ PRICE	RCNLD	PHOTO
SHF	A	1.00 20 0.80	10 X 12	2008	120	21.39	2,100	05/30/2019

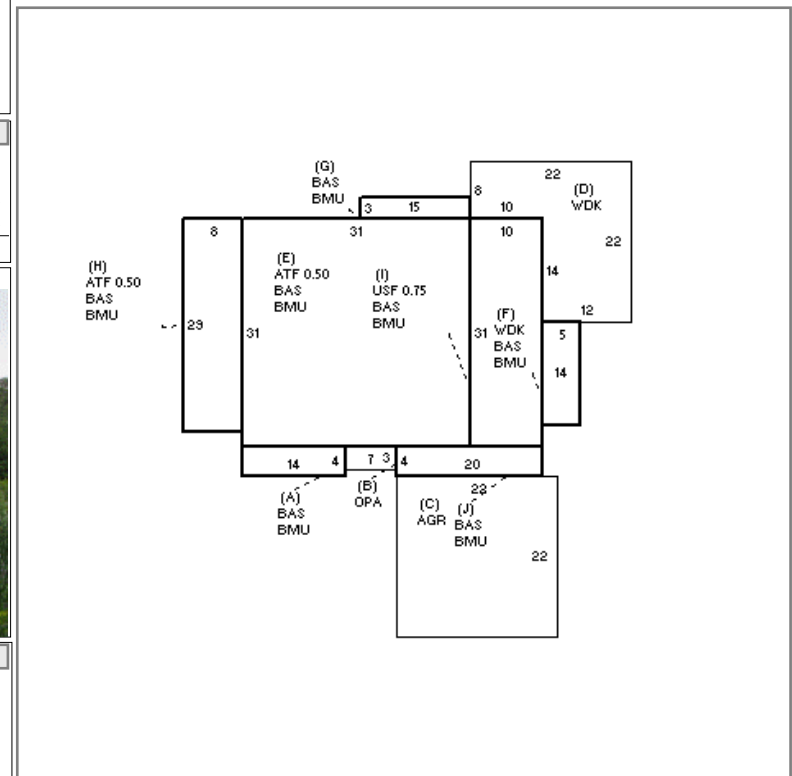

BUILDING

BUILDING	CD	ADJ	DESC	MEASURE	5/30/2019	NF
MODEL	1		RESIDENTIAL	LIST	5/30/2019	NF
STYLE	4	1.02	CAPE [100%]	REVIEW	1/6/2020	MR
QUALITY	A+	1.20	AVG + [100%]			
FRAME	1	1.00	WD FRAME [100%]			

BLDG COMMENTS

G

YEAR BLT	1993	SIZE ADJ	1.000	ELEMENT	CD	DESCRIPTION	ADJ	S	BAT	T	DESCRIPTION	UNITS	YB	ADJ PRICE	RCN	TOTAL RCN	820,436
NET AREA	1,987	DETAIL ADJ	1.000	FOUNDATION	4	FLR & WALL	1.00	+	BMU	N	BSMT UNFINISHED	1,754		64.45	113,050		
\$NLA(RCN)	\$413	OVERALL	1.050	EXT COVER	1	WD SHINGLE	1.00	+	BAS	L	BASE AREA	1,754	1993	298.17	522,984		
				ROOF SHAPE	1	GABLE	1.00	B	OPA	N	OPEN PORCH	21		63.00	1,323		
				ROOF COVER	1	ASPH/CMP SH	1.00	C	AGR	N	ATT GARAGE	484		49.96	24,182		
				FLOOR COVER	1	HARDWOOD	1.00	+	WDK	N	WOOD DECK	414		49.39	20,449		
				INT FINISH	2	DRYWALL	1.00	E	ATF	N	ATTIC FINISH	481		97.02	46,667		
				HEATING/COOL	9	WARM/CL AIR	1.03	H	ATF	N	ATTIC FINISH	116		97.02	11,254		
				FUEL SOURCE	2	GAS	1.00	I	USF	L	UPPER STORY FIN	233	1993	234.01	54,525		
									F11	O	FPL 1S 10P	1		9,622.60	9,623		

CONDITION ELEM	CD
EXTERIOR	A
INTERIOR	A
KITCHEN	A
BATHS	A
HEAT/ELEC	A

EFF.YR/AGE	1993 / 30
COND	20 20 %
FUNC	0
ECON	0
DEPR	20 % GD 80

RCNLD	\$656,300
-------	-----------