

Key: 5163

Town of BREWSTER - Fiscal Year 2025

9/17/2024 2:15 pm SEQ #: 5.387

LEGAL

LAND

DETACHED

BUILDING

| CURRENT OWNER | | | | PARCEL ID | | | | LOCATION | | | |
|---|--|--|--|------------|----|------------|--|--------------------|--|--|--|
| BREWSTER PROPERTIES INC 2907 MAIN STREET BREWSTER, MA 02631 | | | | 75-12-0 | | | | 749 LONG POND ROAD | | | |
| TRANSFER HISTORY | | | | DOS | T | SALE PRICE | | BK-PG (Cert) | | | |
| BREWSTER PROPERTIES INC | | | | 11/05/1997 | B | | | 10 11047-315 | | | |
| VILLAGES DEVELOPMENT CO I | | | | 04/05/1985 | XX | | | 4477-267 | | | |

| CLASS | CLASS% | DESCRIPTION | | BN ID | BN | CARD | |
|--------|------------|---------------|------------------|--------|------------|--------|---------|
| 1010 | 100 | SINGLE FAMILY | | | 1 | 1 of 1 | |
| PMT NO | PMT DT | TY | DESC | AMOUNT | INSP | BY | 1st % |
| 506 | 05/31/2019 | 7 | ALTERATIONS | 6,200 | 07/15/2020 | TCK | 100 100 |
| 182 | 04/24/1995 | 12 | CYCLICAL NON ADD | 60,000 | 03/26/2013 | SF | 100 100 |
| | | 2 | | | 06/12/1996 | JB | 100 100 |

| CD | T | AC/SF/UN | Nbhd | St Ind | Infl | ADJ BASE | SAF | Topo | Lpi | VC | CREDIT AMT | ADJ VALUE |
|-----|---|----------|---------|--------|--------|----------|------|--------|----------|----|------------|-----------|
| 100 | S | 41,400 | 13 1.00 | A 1.00 | A 1.00 | 197,280 | 1.28 | A 1.00 | RM2 0.90 | | | 240,770 |

| | | | | | | | | |
|--------|-----------|--|----------|---------|---------|----------|---------|----------|
| TOTAL | 41,400 SF | ZONING | RM | FRNT | 0 | ASSESSED | CURRENT | PREVIOUS |
| Nbhd | NBHD 13 | NOTE EASEMENT FOR OCEAN EDGE DRIVEWAY | LAND | 240,800 | 227,200 | | | |
| St Ind | AVERAGE | | BUILDING | 489,300 | 461,900 | | | |
| Infl | AVERAGE | | DETACHED | 0 | 0 | | | |
| | | | OTHER | 0 | 0 | | | |
| | | | TOTAL | 730,100 | 689,100 | | | |

| TY | QUAL | COND | DIM/NOTE | YB | UNITS | ADJ PRICE | RCNLD |
|----|------|------|----------|----|-------|-----------|-------|
| | | | | | | | |



BLDG COMMENTS
DREW HOUSE - MAY INSTITUTE LEASES PROPERTY

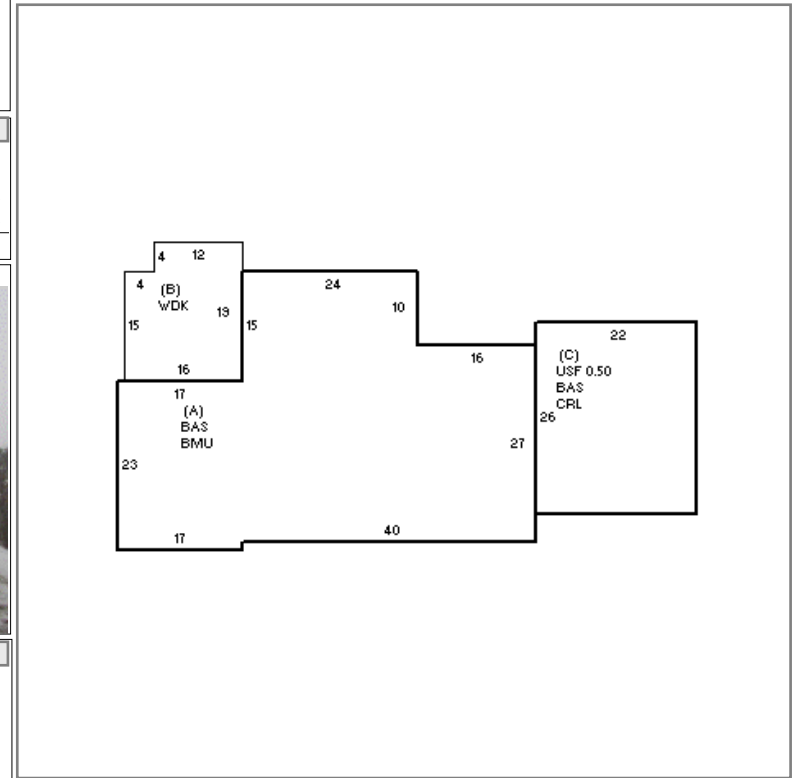

| BUILDING | CD | ADJ | DESC | MEASURE | 1/29/2021 | TCK |
|----------|----|------|-----------------|---------|-----------|-----|
| MODEL | 1 | | RESIDENTIAL | LIST | 1/29/2021 | EST |
| STYLE | 1 | 1.00 | RANCH [100%] | REVIEW | 3/10/2021 | MR |
| QUALITY | + | 1.10 | PLUS AVE [100%] | | | |
| FRAME | 1 | 1.00 | WD FRAME [100%] | | | |

| YEAR BLT | 1963 | SIZE ADJ | 0.990 | ELEMENT | CD | DESCRIPTION | ADJ | S | BAT | T | DESCRIPTION | UNITS | YB | ADJ PRICE | RCN |
|------------|-------|------------|-------|--------------|----|-------------|------|---|-----|---|-----------------|-------|------|-----------|---------|
| NET AREA | 2,569 | DETAIL ADJ | 1.000 | FOUNDATION | 4 | FLR & WALL | 1.00 | A | BMU | N | BSMT UNFINISHED | 1,711 | | 55.71 | 95,313 |
| \$NLA(RCN) | \$293 | OVERALL | 1.000 | EXT COVER | 1 | WD SHINGLE | 1.00 | + | BAS | L | BASE AREA | 2,283 | 1963 | 241.59 | 551,561 |
| | | | | ROOF SHAPE | 1 | GABLE | 1.00 | B | WDK | N | WOOD DECK | 288 | | 42.69 | 12,295 |
| | | | | ROOF COVER | 1 | ASPH/CMP SH | 1.00 | C | CRL | N | BSMT CRAWL | 572 | | 33.07 | 18,914 |
| | | | | FLOOR COVER | 1 | HARDWOOD | 1.00 | C | USF | L | UPPER STORY FIN | 286 | 1963 | 202.25 | 57,844 |
| | | | | INT FINISH | 2 | DRYWALL | 1.00 | | F11 | O | FPL 1S 1OP | 1 | | 8,316.70 | 8,317 |
| | | | | HEATING/COOL | 2 | HOT WATER | 1.00 | | | | | | | | |
| | | | | FUEL SOURCE | 1 | OIL | 1.00 | | | | | | | | |

| TOTAL RCN | 752,823 |
|----------------|------------|
| CONDITION ELEM | CD |
| EXTERIOR | A |
| INTERIOR | A |
| KITCHEN | A |
| BATHS | A |
| HEAT/ELEC | A |
| EFF.YR/AGE | 1963 / 60 |
| COND | 35 35 % |
| FUNC | 0 |
| ECON | 0 |
| DEPR | 35 % GD 65 |
| RCNLD | \$489,300 |