

Key: 6412

Town of BREWSTER - Fiscal Year 2025

9/17/2024 2:15 pm SEQ #: 6.644

LEGALS

CURRENT OWNER		PARCEL ID	LOCATION		
LEMOINE JANET TRUSTEE & WILSON NANCY L TRUSTEE 152 N CAYMAN ISLES BLVD ENGLEWOOD, FL 34223		13-39-0	117 STURBRIDGE WAY		
		TRANSFER HISTORY		DOS	T
		LEMOINE JANET TRUSTEE & WILSON NANCY L & SALVADORE JOHN L & JANICE		12/18/2013 05/17/2002 01/21/2000	F QS H

CLASS	CLASS%	DESCRIPTION		BN ID	BN	CARD	
1010	100	SINGLE FAMILY			1	1 of 1	
PMT NO	PMT DT	TY	DESC	AMOUNT	INSP	BY	1st %
820	10/17/2017	7	ALTERATIONS	32,250	05/30/2018	NF	100 100
206	05/06/2010	7	ALTERATIONS	2,500	12/17/2010	MR	100 100
263	06/29/2009	7	ALTERATIONS	15,000	04/05/2010	JH	100 100
503	09/16/2008	5	OTHER	53,337	03/13/2009	JH	100 100
791	11/30/2007	3	OUT BUILDING	2,400	07/25/2008	DHT	100 100

LAND

CD	T	AC/SF/UN	Nbhd	St Ind	Infl	ADJ BASE	SAF	Topo	Lpi	VC	CREDIT AMT	ADJ VALUE
100	S	15,075	12	1.00	12S 1.00 A 1.00	230,160	2.80	A	1.00	PF1	1.05	223,230

TOTAL	15,072 SF	ZONING	RL	FRNT	0	ASSESSED	CURRENT	PREVIOUS
Nbhd	NBHD 12	N O T E	POND VIEW			LAND	223,200	210,600
St Ind	STURBRIDGE		BUILDING	339,000	320,200			
Infl	AVERAGE		DETACHED	1,900	1,900			
			OTHER	0	0			
			TOTAL	564,100	532,700			

TY	QUAL	COND	DIM/NOTE	YB	UNITS	ADJ PRICE	RCNLD
SHF	G	1.20 10 0.90	8X10	2007	80	26.41	1,900



BLDG COMMENTS

24 SOLAR PANELS

DETACHED

BUILDING	CD	ADJ	DESC	MEASURE	11/9/2017	NF
MODEL	1		RESIDENTIAL	LIST	5/30/2018	NF
STYLE	1	1.00	RANCH [100%]	REVIEW	6/14/2018	TD
QUALITY	A	1.00	AVG [100%]			
FRAME	1	1.00	WD FRAME [100%]			

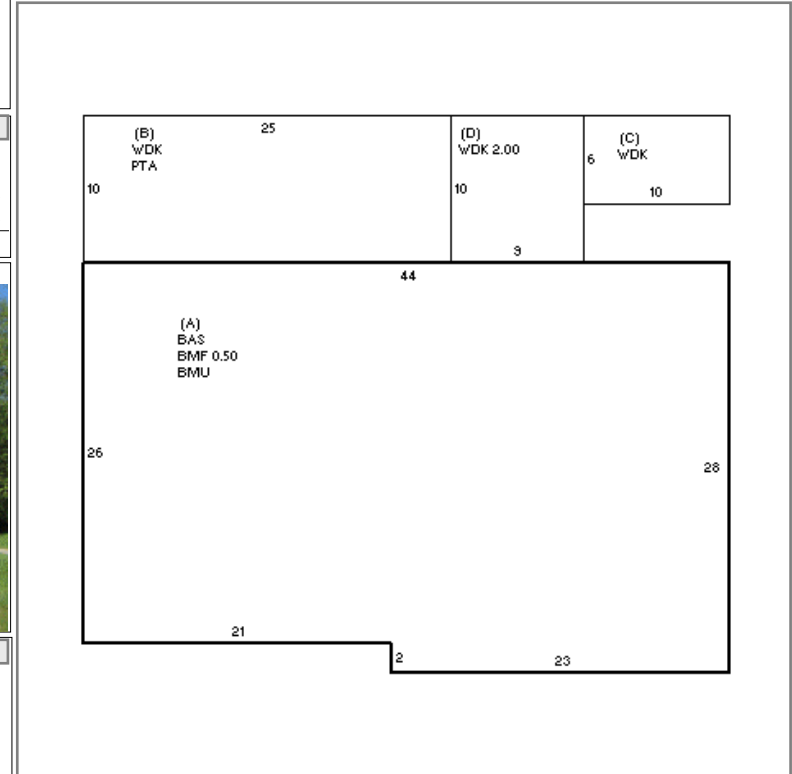

BUILDING

YEAR BLT	1981	SIZE ADJ	1.000
NET AREA	1,190	DETAIL ADJ	1.000
\$NLA(RCN)	\$356	OVERALL	0.960
CAPACITY		UNITS	ADJ
STORIES	1	1.00	
ROOMS	6	1.00	
BEDROOMS	3	1.00	
BATHROOMS	2	1.00	
FIXTURES	7	\$8,736	
GARAGE SPACES	2	1.00	
% BSMT FIN	50	1.00	
# 1/2 BATHS	0	1.00	
# OF UNITS	1	1.00	

ELEMENT	CD	DESCRIPTION	ADJ	S	BAT	T	DESCRIPTION	UNITS	YB	ADJ PRICE	RCN
FOUNDATION	4	FLR & WALL	1.00	A	BMU	N	BSMT UNFINISHED	1,190		54.20	64,503
EXT COVER	1	WD SHINGLE	1.00	A	BMF	N	BSMT FINISH	595		38.72	23,039
ROOF SHAPE	1	GABLE	1.00	A	BAS	L	BASE AREA	1,190	1981	243.74	290,050
ROOF COVER	1	ASPH/CMP SH	1.00	B	PTA	N	PATIO	250		13.74	3,435
FLOOR COVER	1	HARDWOOD	1.00	+	WDK	N	WOOD DECK	490		37.63	18,440
INT FINISH	2	DRYWALL	1.00	BMG	O	BSMT GARAGE		2		2,969.75	5,940
HEATING/COOL	14	ELECT BB+AC	1.01	F11	O	FPL 1S IOP		1		7,331.50	7,332
FUEL SOURCE	3	ELECTRIC	0.95	ODS	O	OUTDOOR SHOWER		1		2,318.40	2,318

TOTAL RCN	423,792
CONDITION ELEM	CD
EXTERIOR	G
INTERIOR	A
KITCHEN	A
BATHS	V
HEAT/ELEC	A
EFF.YR/AGE	1993 / 30
COND	20 20 %
FUNC	0
ECON	0
DEPR	20 % GD 80
RCNLD	\$339,000