

Key: 6630

Town of BREWSTER - Fiscal Year 2025

9/17/2024 2:15 pm SEQ #: 6.855

LEGALS

LAND

DETACHED

BUILDING

CURRENT OWNER		PARCEL ID		LOCATION	
LAPALME PAUL MICHAEL & CHRISTINE L TRUSTEES		10-32-0		89 PINE VIEW DRIVE	
89 PINE VIEW DRIVE BREWSTER, MA 02631		TRANSFER HISTORY		DOS	T
CD	T	AC/SF/UN	Nbhd	St Ind	Infl
100	S	16,205	12 1.00	12Q 1.00	A 1.00
ADJ BASE		SAF	Topo	Lpi	VC
230,160		2.64	A	1.00	R04 1.05
CREDIT AMT		ADJ VALUE			
		225,750			

CLASS	CLASS%	DESCRIPTION		BN ID	BN	CARD	
1010	100	SINGLE FAMILY			1	1 of 1	
PMT NO	PMT DT	TY	DESC	AMOUNT	INSP	BY	1st %
821	09/19/2019	7	ALTERATIONS	89,000	07/10/2020	MR	100 100
764	09/22/2014	7	ALTERATIONS	5,000	06/15/2015	MW	100 100
NP		12	CYCLICAL NON		03/20/2008	JH	100 100
472	09/03/1998	8	YARD ITEMS	400	07/28/1999	JB	100 100
541	09/22/1997	2	ADD	8,000	07/28/1999	JB	100 100

TOTAL	16,205 SF	ZONING	RR	FRNT	0	ASSESSED	CURRENT	PREVIOUS
Nbhd	NBHD 12	NOTE	LAND	225,800	213,000			
St Ind	SLOUGH		BUILDING	551,100	520,400			
Infl	AVERAGE		DETACHED	1,200	1,200			
			OTHER	0	0			
TOTAL				778,100	734,600			

TY	QUAL	COND	DIM/NOTE	YB	UNITS	ADJ PRICE	RCNLD
SHF	A	1.00 30 0.70	10 X 8		80	22.01	1,200

PHOTO 07/10/2020



BLDG COMMENTS

INTERIOR EST PER PLANS (7/29/20)

BUILDING	CD	ADJ	DESC	MEASURE	12/7/2017	NF
MODEL	1		RESIDENTIAL	LIST	3/20/2008	JH
STYLE	4	1.02	CAPE [100%]	REVIEW	7/29/2020	MR
QUALITY	A+	1.20	AVG + [100%]			
FRAME	1	1.00	WD FRAME [100%]			

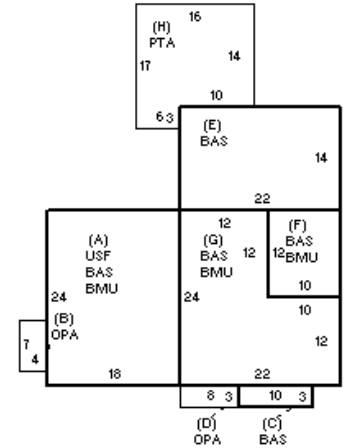

YEAR BLT	1973	SIZE ADJ	1.000
NET AREA	1,730	DETAIL ADJ	1.000
\$NLA(RCN)	\$362	OVERALL	1.070
CAPACITY		UNITS	ADJ
STORIES		1.75	1.00
ROOMS		7	1.00
BEDROOMS		3	1.00
BATHROOMS		2	1.00
FIXTURES		6	\$10,015
GARAGE SPACES		1	1.00
% BSMT FIN		0	1.00
# 1/2 BATHS		0	1.00
# OF UNITS		1	1.00

ELEMENT	CD	DESCRIPTION	ADJ	S	BAT	T	DESCRIPTION	UNITS	YB	ADJ PRICE	RCN
FOUNDATION	4	FLR & WALL	1.00	+	BMU	N	BSMT UNFINISHED	960		75.76	72,726
EXT COVER	1	WD SHINGLE	1.00	+	BAS	L	BASE AREA	552	1973	316.51	174,711
ROOF SHAPE	1	GABLE	1.00	A	USF	L	UPPER STORY FIN	432	2019	238.47	103,019
ROOF COVER	1	ASPH/CMP SH	1.00	+	OPA	N	OPEN PORCH	52		64.20	3,338
FLOOR COVER	1	HARDWOOD	1.00	C	BAS	L	BASE AREA	30	1998	316.51	9,495
INT FINISH	2	DRYWALL	1.00	+	BAS	L	BASE AREA	716	1973	316.51	226,618
HEATING/COOL	11	HTWT/CL AIR	1.05	H	PTA	N	PATIO	242		18.37	4,447
FUEL SOURCE	2	GAS	1.00		BMG	O	BSMT GARAGE	1		5,709.90	5,710
					F21	O	FPL 2S 1OP	1		13,033.90	13,034
					ODS	O	OUTDOOR SHOWER	1		3,100.90	3,101

TOTAL RCN	626,215
CONDITION ELEM	CD
EXTERIOR	A
INTERIOR	V
KITCHEN	V
BATHS	V
HEAT/ELEC	A
EFF.YR/AGE	2009 / 14
COND	12 12 %
FUNC	0
ECON	0
DEPR	12 % GD 88
RCNLD	\$551,100