

Key: 721

Town of BREWSTER - Fiscal Year 2025

9/17/2024 2:15 pm SEQ #: 742

LEGAL

CURRENT OWNER		PARCEL ID		LOCATION		
MAURER STEPHEN C & PAMELA ERICKSON 80 WOODLAND DRIVE FLORENCE, MA 01062		78-77-721		10 FRIENDSHIP LANE		
TRANSFER HISTORY		DOS	T	SALE PRICE	BK-PG (Cert)	
MAURER STEPHEN C & PAMELA		06/29/2020	QS	530,000	33026-43	
LOESER DAVID L & JODY M		09/12/2002	QS	329,000	15583-313	
SAGARIN MARY		09/16/1977	XX	49,650	2582-279	

CLASS	CLASS%	DESCRIPTION			BN ID	BN	CARD	
1020	100	CONDOMINIUM				1	1 of 1	
PMT NO	PMT DT	TY	DESC	AMOUNT	INSP	BY	1st	%
817	11/12/2020	7	ALTERATIONS	60,000	02/23/2021	NF	100	100
	06/29/2020	15	SALE REVIEW	530,000	02/04/2021	JMG	100	100
7	01/06/2015	7	ALTERATIONS	19,500	05/19/2016	WFF	100	100
79	02/03/2014	7	ALTERATIONS	14,000	06/12/2015	MW	100	100
447	05/29/2013	7	ALTERATIONS	4,400	08/06/2014	RJM	100	100

LAND

CD	T	AC/SF/UN	Nbhd	St Ind	Infl	ADJ BASE	SAF	Topo	Lpi	VC	CREDIT AMT	ADJ VALUE

TOTAL	SF	ZONING	RM	FRNT	0	ASSESSED	CURRENT	PREVIOUS
						LAND	0	0
						BUILDING	760,300	717,900
						DETACHED	0	0
						OTHER	0	0
						<b>TOTAL</b>	<b>760,300</b>	<b>717,900</b>

DETACHED

TY	QUAL	COND	DIM/NOTE	YB	UNITS	ADJ PRICE	RCNLD

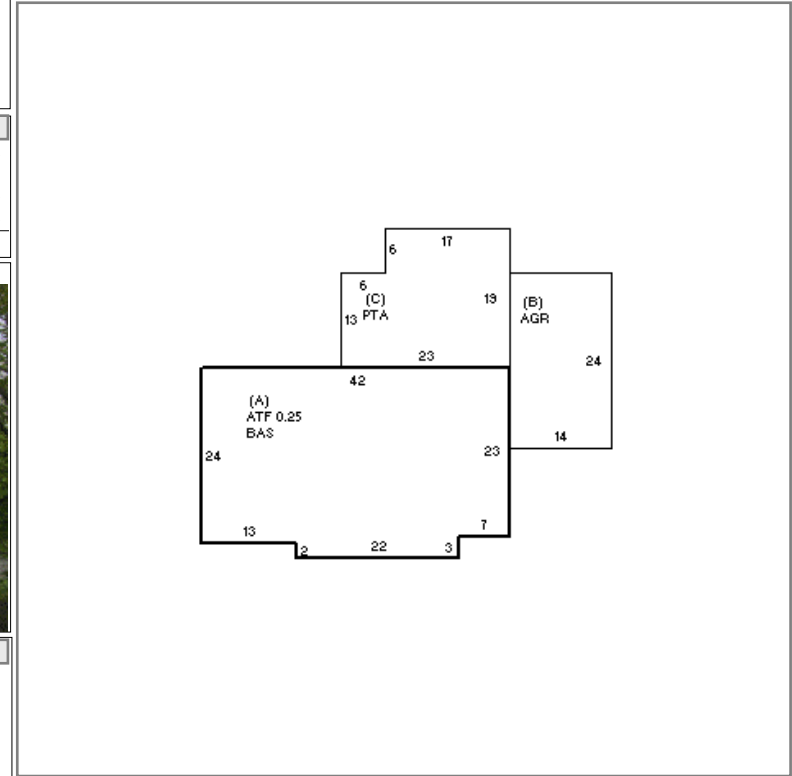

BUILDING

BUILDING	CD	ADJ	DESC	MEASURE	12/10/2008	SAM
MODEL	10		CONDO RES	LIST	12/10/2008	EST
STYLE	2	1.00	STAND ALONE [100%]	REVIEW	2/4/2021	JMG
QUALITY	A	1.00	AVG [100%]			
FRAME	1	1.00	N/A [100%]			

BLDG COMMENTS

G

YEAR BLT	1977	SIZE ADJ	1.000	ELEMENT	CD	DESCRIPTION	ADJ	S	BAT	T	DESCRIPTION	UNITS	YB	ADJ PRICE	RCN	TOTAL RCN	808,836															
NET AREA	1,306	DETAIL ADJ	2.530	COMPLEX	5	SEAPINES	2.20	A	BAS	L	BASE AREA	1,045	1977	634.63	663,193																	
\$NLA(RCN)	\$619	OVERALL	1.000	STYLE	43	05-FRIENDSHIP	1.15	A	ATF	L	ATTIC FIN	261	1977	445.85	116,367																	
				VIEW/LOC	1	NONE	1.00	B	AGR	N	ATT GARAGE	336		38.70	13,003																	
				HVAC	5	ELECTRIC BB	1.00	C	PTA	N	PATIO	401		12.90	5,173																	
				END/MIDDLE	1	END	1.00																									
				<table border="1"> <thead> <tr> <th>CONDITION ELEM</th> <th>CD</th> </tr> </thead> <tbody> <tr> <td>INTERIOR</td> <td>G</td> </tr> <tr> <td>KITCHEN</td> <td>V</td> </tr> <tr> <td>BATHS</td> <td>G</td> </tr> <tr> <td>EXTERIOR</td> <td>A</td> </tr> </tbody> </table>														CONDITION ELEM	CD	INTERIOR	G	KITCHEN	V	BATHS	G	EXTERIOR	A					
CONDITION ELEM	CD																															
INTERIOR	G																															
KITCHEN	V																															
BATHS	G																															
EXTERIOR	A																															
				<table border="1"> <thead> <tr> <th>EFF.YR/AGE</th> <td colspan="2">2003 / 20</td> </tr> </thead> <tbody> <tr> <td>COND</td> <td>6</td> <td>6 %</td> </tr> <tr> <td>FUNC</td> <td>0</td> <td></td> </tr> <tr> <td>ECON</td> <td>0</td> <td></td> </tr> <tr> <td>DEPR</td> <td>6</td> <td>% GD 94</td> </tr> </tbody> </table>														EFF.YR/AGE	2003 / 20		COND	6	6 %	FUNC	0		ECON	0		DEPR	6	% GD 94
EFF.YR/AGE	2003 / 20																															
COND	6	6 %																														
FUNC	0																															
ECON	0																															
DEPR	6	% GD 94																														
				<table border="1"> <thead> <tr> <th>RCNLD</th> <td>\$760,300</td> </tr> </thead> </table>														RCNLD	\$760,300													
RCNLD	\$760,300																															