

Key: 723

Town of BREWSTER - Fiscal Year 2025

9/17/2024 2:15 pm SEQ #: 744

LEGALS

CURRENT OWNER				PARCEL ID				LOCATION			
LAROSE STEPHEN M & MARY ELLEN 1145 HIGH STREET WESTWOOD, MA 02090				78-77-723				14 FRIENDSHIP LANE			
TRANSFER HISTORY				DOS	T	SALE PRICE	BK-PG (Cert)				
LAROSE STEPHEN M & MARY E				06/29/2016	QS	345,000	29763-270				
MALEC GREGORY & CINDA				07/23/2013	F	1 27564-186					
MALEC GREGORY				07/23/2013	DC	26175-186					

CLASS	CLASS%	DESCRIPTION			BN ID	BN	CARD	
1020	100	CONDOMINIUM				1	1 of 1	
PMT NO	PMT DT	TY	DESC	AMOUNT	INSP	BY	1st	%
384	05/03/2018	7	ALTERATIONS	10,000	07/02/2019	NF	100	100
8	01/06/2015	7	ALTERATIONS	13,400	05/19/2016	WFF	100	100
197	03/05/2013	7	ALTERATIONS	500	08/04/2014	RJM	100	100
87	03/07/2011	7	ALTERATIONS	5,000	03/01/2012	MR	100	100

LAND

CD	T	AC/SF/UN	Nbhd	St Ind	Infl	ADJ BASE	SAF	Topo	Lpi	VC	CREDIT AMT	ADJ VALUE

TOTAL	SF	ZONING	RM	FRNT	0	ASSESSED	CURRENT	PREVIOUS
						LAND	0	0
						BUILDING	607,000	573,200
						DETACHED	0	0
						OTHER	0	0
						TOTAL	607,000	573,200

DETACHED

TY	QUAL	COND	DIM/NOTE	YB	UNITS	ADJ PRICE	RCNLD

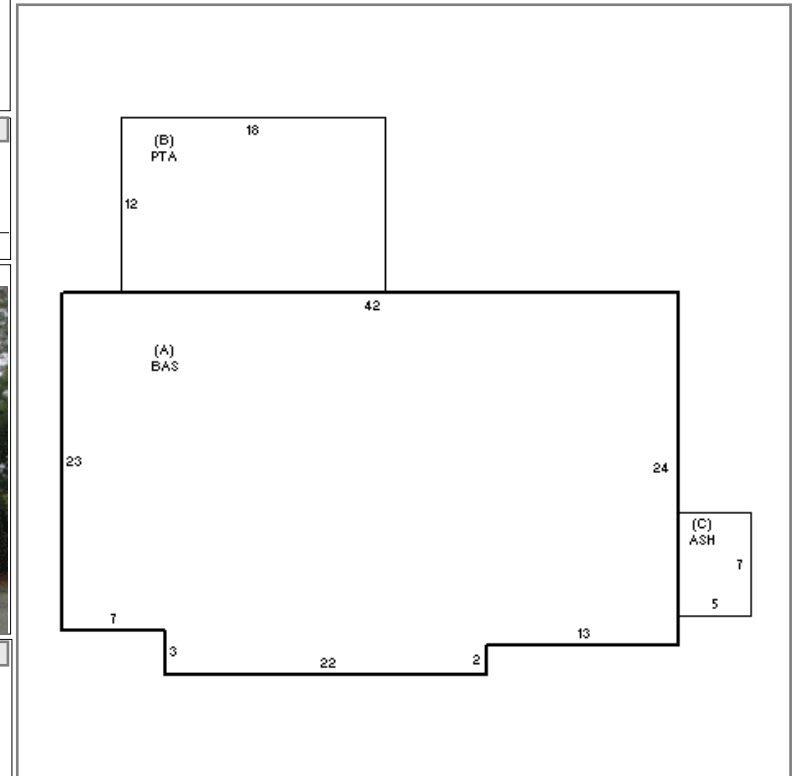

BUILDING

BUILDING	CD	ADJ	DESC	MEASURE	12/10/2008	SAM
MODEL	10		CONDO RES	LIST	12/10/2008	SAM
STYLE	2	1.00	STAND ALONE [100%]	REVIEW	7/10/2019	EMZ
QUALITY	A	1.00	AVG [100%]			
FRAME	1	1.00	N/A [100%]			

BLDG COMMENTS

BUILDING

YEAR BLT	1977	SIZE ADJ	1.000	ELEMENT	CD	DESCRIPTION	ADJ	S	BAT	T	DESCRIPTION	UNITS	YB	ADJ PRICE	RCN	TOTAL RCN	705.775													
NET AREA	1,045	DETAIL ADJ	2.568	COMPLEX	5	SEAPINES	2.20	A	BAS	L	BASE AREA	1,045	1977	661.44	691,203															
\$NLA(RCN)	\$675	OVERALL	1.000	STYLE	43	05-FRIENDSHIP	1.15	B	PTA	N	PATIO	216		12.90	2,786															
				VIEW/LOC	1	NONE	1.00	C	ASH	N	ATT SHED	35		19.60	686															
				HVAC	16	EL BB+WALL+AC	1.02																							
				END/MIDDLE	1	END	1.00																							
<table border="1"> <thead> <tr> <th>CONDITION ELEM</th> <th>CD</th> </tr> </thead> <tbody> <tr> <td>INTERIOR</td> <td>A</td> </tr> <tr> <td>KITCHEN</td> <td>A</td> </tr> <tr> <td>BATHS</td> <td>A</td> </tr> <tr> <td>EXTERIOR</td> <td>A</td> </tr> </tbody> </table>																CONDITION ELEM	CD	INTERIOR	A	KITCHEN	A	BATHS	A	EXTERIOR	A					
CONDITION ELEM	CD																													
INTERIOR	A																													
KITCHEN	A																													
BATHS	A																													
EXTERIOR	A																													
<table border="1"> <thead> <tr> <th>EFF.YR/AGE</th> <td colspan="2">1978 / 45</td> </tr> </thead> <tbody> <tr> <td>COND</td> <td>14</td> <td>14 %</td> </tr> <tr> <td>FUNC</td> <td>0</td> <td></td> </tr> <tr> <td>ECON</td> <td>0</td> <td></td> </tr> <tr> <td>DEPR</td> <td>14</td> <td>% GD 86</td> </tr> </tbody> </table>																EFF.YR/AGE	1978 / 45		COND	14	14 %	FUNC	0		ECON	0		DEPR	14	% GD 86
EFF.YR/AGE	1978 / 45																													
COND	14	14 %																												
FUNC	0																													
ECON	0																													
DEPR	14	% GD 86																												
<table border="1"> <thead> <tr> <th>RCNLD</th> <td>\$607,000</td> </tr> </thead> </table>																RCNLD	\$607,000													
RCNLD	\$607,000																													