

Key: 726

Town of BREWSTER - Fiscal Year 2025

9/17/2024 2:15 pm SEQ #: 747

LEGAL

CURRENT OWNER				PARCEL ID				LOCATION					
KATZ JEFFREY N & ZEIGER SUSAN L 20 PLOWGATE ROAD SO BROOKLINE, MA 02467				78-77-726				22 FRIENDSHIP LANE					
				TRANSFER HISTORY				DOS	T	SALE PRICE		BK-PG (Cert)	
				KATZ JEFFREY N & ZEIGER HERBERT J & HANNA				12/03/2008	A	150,000		23294-183	
				08/18/1986				XX		166,000		5253-25	

CLASS	CLASS%	DESCRIPTION			BN ID	BN	CARD	
1020	100	CONDOMINIUM				1	1 of 1	
PMT NO	PMT DT	TY	DESC	AMOUNT	INSP	BY	1st	%
873	10/28/2015	7	ALTERATIONS	900	05/19/2016	WFF	100	100
142	03/16/2015	7	ALTERATIONS	13,408	05/19/2016	WFF	100	100
498	08/15/2003	5	OTHER	200	12/10/2008	SAM	100	100

LAND

CD	T	AC/SF/UN	Nbhd	St Ind	Infl	ADJ BASE	SAF	Topo	Lpi	VC	CREDIT AMT	ADJ VALUE

TOTAL	SF	ZONING	RM	FRNT	0	ASSESSED	CURRENT	PREVIOUS
Nbhd		NOTE				LAND	0	0
St Ind			BUILDING	767,900	725,000			
Infl			DETACHED	0	0			
			OTHER	0	0			
						TOTAL	767,900	725,000

DETACHED

TY	QUAL	COND	DIM/NOTE	YB	UNITS	ADJ PRICE	RCNLD

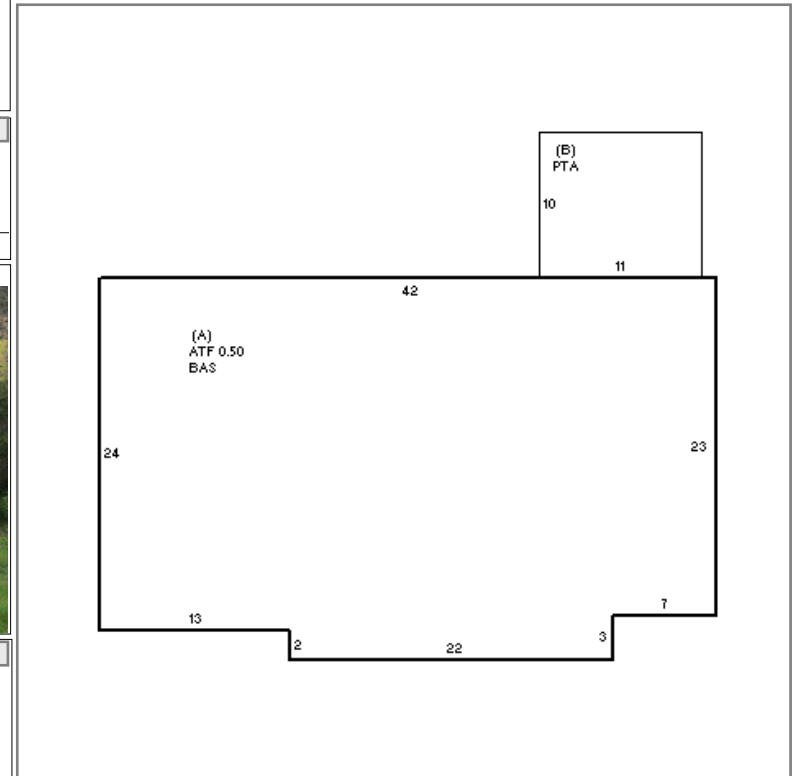

BUILDING

BUILDING	CD	ADJ	DESC	MEASURE	12/10/2008	SAM
MODEL	10		CONDO RES	LIST	12/10/2008	EST
STYLE	2	1.00	STAND ALONE [100%]	REVIEW	1/2/2009	TD
QUALITY	A	1.00	AVG [100%]			
FRAME	1	1.00	N/A [100%]			

BLDG COMMENTS

G

YEAR BLT	1977	SIZE ADJ	1.000	ELEMENT	CD	DESCRIPTION	ADJ	S	BAT	T	DESCRIPTION	UNITS	YB	ADJ PRICE	RCN	TOTAL RCN	892,869															
NET AREA	1,568	DETAIL ADJ	2.530	COMPLEX	5	SEAPINES	2.20	A	BAS	L	BASE AREA	1,045	1977	623.29	651,339																	
\$NLA(RCN)	\$569	OVERALL	1.000	STYLE	43	05-FRIENDSHIP	1.15	A	ATF	L	ATTIC FIN	523	1977	437.88	229,011																	
				VIEW/LOC	1	NONE	1.00	B	PTA	N	PATIO	110		12.90	1,419																	
				HVAC	5	ELECTRIC BB	1.00																									
				END/MIDDLE	1	END	1.00																									
				<table border="1"> <thead> <tr> <th>CONDITION ELEM</th> <th>CD</th> </tr> </thead> <tbody> <tr> <td>INTERIOR</td> <td>A</td> </tr> <tr> <td>KITCHEN</td> <td>A</td> </tr> <tr> <td>BATHS</td> <td>A</td> </tr> <tr> <td>EXTERIOR</td> <td>A</td> </tr> </tbody> </table>														CONDITION ELEM	CD	INTERIOR	A	KITCHEN	A	BATHS	A	EXTERIOR	A					
CONDITION ELEM	CD																															
INTERIOR	A																															
KITCHEN	A																															
BATHS	A																															
EXTERIOR	A																															
				<table border="1"> <thead> <tr> <th>EFF.YR/AGE</th> <td colspan="2">1978 / 45</td> </tr> </thead> <tbody> <tr> <td>COND</td> <td>14</td> <td>14 %</td> </tr> <tr> <td>FUNC</td> <td>0</td> <td></td> </tr> <tr> <td>ECON</td> <td>0</td> <td></td> </tr> <tr> <td>DEPR</td> <td>14</td> <td>% GD 86</td> </tr> </tbody> </table>														EFF.YR/AGE	1978 / 45		COND	14	14 %	FUNC	0		ECON	0		DEPR	14	% GD 86
EFF.YR/AGE	1978 / 45																															
COND	14	14 %																														
FUNC	0																															
ECON	0																															
DEPR	14	% GD 86																														
				<table border="1"> <thead> <tr> <th>RCNLD</th> <td>\$76,900</td> </tr> </thead> </table>														RCNLD	\$76,900													
RCNLD	\$76,900																															