

Key: 7267

Town of BREWSTER - Fiscal Year 2025

9/17/2024 2:15 pm SEQ #: 7.496

LEGALS

Table with columns: CURRENT OWNER, PARCEL ID, LOCATION, TRANSFER HISTORY, DOS, T, SALE PRICE, BK-PG (Cert). Includes owner info for Leathers John Royce & Farrell Chrissy Trustees.

LAND

Table with columns: CD, T, AC/SF/UN, Nbhd, St Ind, Infl, ADJ BASE, SAF, Topo, Lpi, VC, CREDIT AMT, ADJ VALUE. Includes zoning and assessed value information.

Table with columns: TY, QUAL, COND, DIM/NOTE, YB, UNITS, ADJ PRICE, RCNLD. Includes a photo of the property and building comments.

DETACHED

Table with columns: BUILDING, CD, ADJ, DESC, MEASURE, 3/11/2021, NF, LIST, 11/17/2011, MR, REVIEW, 11/9/2021, EMZ. Includes building details and quality metrics.

BUILDING

Table with columns: YEAR BLT, SIZE ADJ, 0.990, ELEMENT, CD, DESCRIPTION, ADJ, S, BAT, T, DESCRIPTION, UNITS, YB, ADJ PRICE, RCN. Includes capacity and element details.

Table with columns: CLASS, CLASS%, DESCRIPTION, BN ID, BN, CARD. Includes class 1010 and 100, and description SINGLE FAMILY.

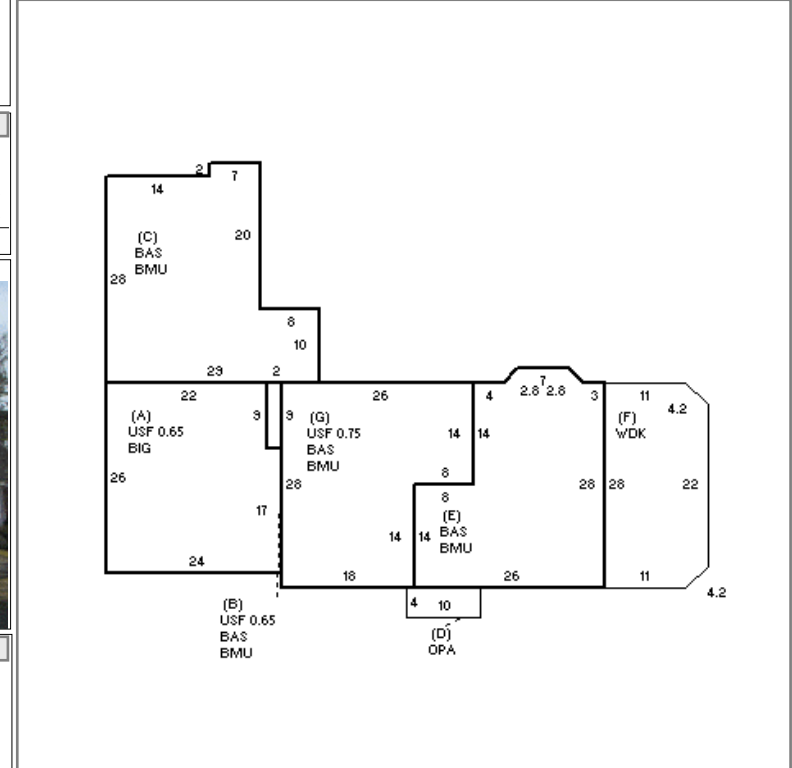

Table with columns: TOTAL RCN, 1,028,100, CONDITION ELEM, CD, EFF. YR/AGE, 2005 / 18, COND, 14 14 %, FUNC, 0, ECON, 0, DEPR, 14 % GD, 86, RCNLD, \$884,200.