

Key: 749

Town of BREWSTER - Fiscal Year 2025

9/17/2024 2:15 pm SEQ #: 770

LEGAL

CURRENT OWNER		PARCEL ID		LOCATION	
EASTWOOD TRUST JENNISON GARY A TRUSTEE c/o CORCORAN JENNISON CO 150 MT VERNON ST STE 500 BOSTON. MA 02125		78-77-749		28 HOLLOW LANE	
TRANSFER HISTORY		DOS	T	SALE PRICE	BK-PG (Cert)
EASTWOOD TRUST		10/04/1989	A	1 6907-145	
CAROLE A JENNISON		10/04/1989	A	1 6907-138	

CLASS	CLASS%	DESCRIPTION		BN ID	BN	CARD	
1020	100	CONDOMINIUM			1	1 of 1	
PMT NO	PMT DT	TY	DESC	AMOUNT	INSP	BY	1st %
994	12/03/2014	7	ALTERATIONS	25,500	06/12/2015	MW	100 100
297	05/28/2003	7	ALTERATIONS	20,000	12/12/2008	SAM	100 100
225	04/24/2000	7	ALTERATIONS	2,000	12/12/2008	SAM	100 100

LAND

CD	T	AC/SF/UN	Nbhd	St Ind	Infl	ADJ BASE	SAF	Topo	Lpi	VC	CREDIT AMT	ADJ VALUE

TOTAL	SF	ZONING	RM	FRNT	0	ASSESSED	CURRENT	PREVIOUS
						LAND	0	0
						BUILDING	922,400	870,400
						DETACHED	0	0
						OTHER	0	0
						TOTAL	922,400	870,400

DETACHED

TY	QUAL	COND	DIM/NOTE	YB	UNITS	ADJ PRICE	RCNLD

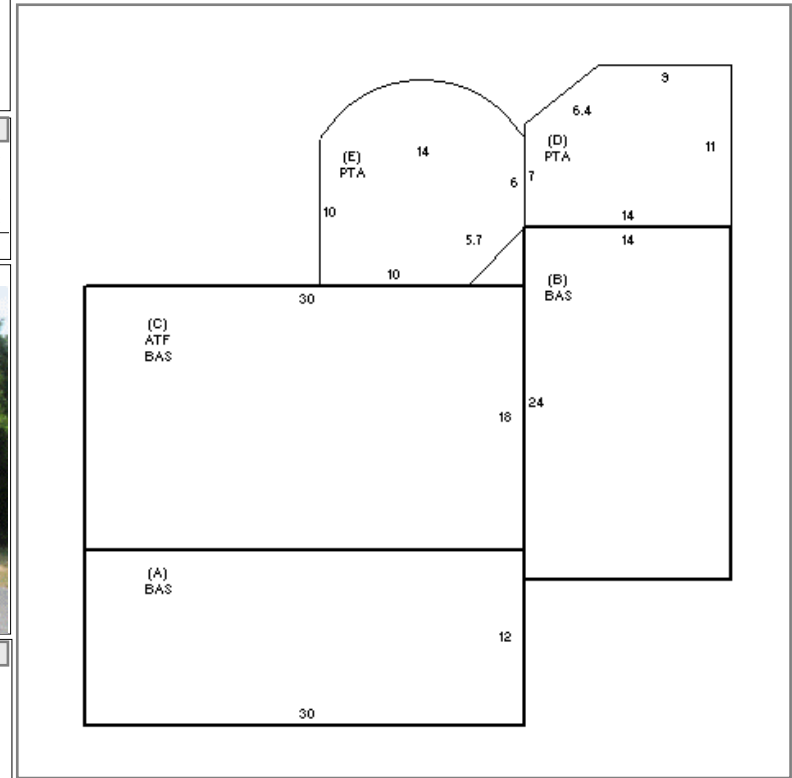

BUILDING

BUILDING	CD	ADJ	DESC	MEASURE	12/12/2008	SAM
MODEL	10		CONDO RES	LIST	12/12/2008	EST
STYLE	2	1.00	STAND ALONE [100%]	REVIEW	7/8/2002	SJM
QUALITY	A	1.00	AVG [100%]			
FRAME	1	1.00	N/A [100%]			

BLDG COMMENTS
FULL REAR DORMER/AGR CONVERTED TO BAS

G

YEAR BLT	1977	SIZE ADJ	1.000	ELEMENT	CD	DESCRIPTION	ADJ	S	BAT	T	DESCRIPTION	UNITS	YB	ADJ PRICE	RCN	TOTAL RCN	1,013,617
NET AREA	1,776	DETAIL ADJ	2.555	COMPLEX	5	SEAPINES	2.20	+	BAS	L	BASE AREA	900	1977	623.09	560,777	CONDITION ELEM	CD
\$NLA(RCN)	\$571	OVERALL	1.000	STYLE	44	05-HOLLOW	1.15	B	BAS	L	BASE AREA	336	2003	623.09	209,357	INTERIOR	A
				VIEW/LOC	1	NONE	1.00	C	ATF	L	ATTIC FIN	540	1977	437.74	236,377	KITCHEN	G
				HVAC	14	ELEC BB+AC	1.01	+	PTA	N	PATIO	295		12.90	3,806	BATHS	G
				END/MIDDLE	1	END	1.00									EXTERIOR	A
CAPACITY		UNITS	ADJ														
ROOMS		7	1.00														
BEDROOMS		2	1.00														
BATHS		2	1.00														
HALF BATHS		0	1.00														
FIREPLACES		1	\$3,300														
% COMMON OWNER		4.9	1.00														
FIXTURES		0	.00														
																EFF.YR/AGE	1994 / 29
																COND	99%
																FUNC	0
																ECON	0
																DEPR	9% GD 91
																RCNLD	\$922,400