

Key: 7806

Town of BREWSTER - Fiscal Year 2025

9/17/2024 2:15 pm SEQ #: 8.033

LEGALS

CURRENT OWNER							PARCEL ID					LOCATION				
SCOTT STEPHEN K & KATHARINE Z 228 JONATHANS WAY BREWSTER, MA 02631							95-200-0					228 JONATHANS WAY				
TRANSFER HISTORY							DOS	T	SALE PRICE		BK-PG (Cert)					
SCOTT STEPHEN K & KATHARINE							01/29/2018	F	100		31049-343					
SCOTT STEPHEN K							10/30/2013	QS	229,000		27791-309					
SHEETS DAVID							07/03/2012	DC	26472-245							

CLASS	CLASS%	DESCRIPTION			BN ID	BN	CARD	
1010	100	SINGLE FAMILY				1	1 of 1	
PMT NO	PMT DT	TY	DESC	AMOUNT	INSP	BY	1st	%
698		14	CYCLICAL GRO		11/02/2020	TCK	100	100
501	08/13/2018	77	SOLAR PANELS	5,000	07/11/2019	TCK	100	100
	07/06/2015	77	SOLAR PANELS	10,000	04/20/2015	WFF	100	100
		12	CYCLICAL NON		02/20/2013	SF	100	100

LAND

CD	T	AC/SF/UN	Nbhd	St Ind	Infl	ADJ BASE	SAF	Topo	Lpi	VC	CREDIT AMT	ADJ VALUE
100	S	17,050	13 1.00	A 1.00	A 1.00	219,200	2.53	A 1.00	R02	1.00		216,880

TOTAL	17,050 SF	ZONING	RM	FRNT	0	ASSESSED	CURRENT	PREVIOUS
Nbhd	NBHD 13	NOTE	LAND	216,900	204,600			
St Ind	AVERAGE		BUILDING	201,300	190,000			
Infl	AVERAGE		DETACHED	0	0			
			OTHER	0	0			
<b>TOTAL</b>				<b>418,200</b>	<b>394,600</b>			

DETACHED

TY	QUAL	COND	DIM/NOTE	YB	UNITS	ADJ PRICE	RCNLD

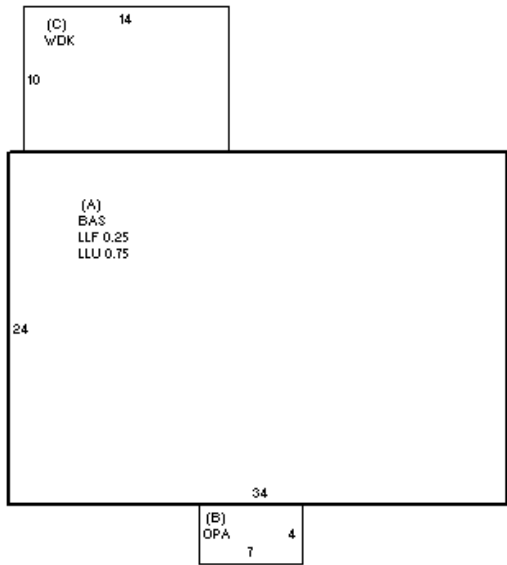

BUILDING

BUILDING	CD	ADJ	DESC	MEASURE	11/2/2020	TCK
MODEL	1		RESIDENTIAL	LIST	2/20/2013	EST
STYLE	2	0.90	RAISED RNCH [100%]	REVIEW	12/15/2020	MR
QUALITY	A	1.00	AVG [100%]			
FRAME	1	1.00	WD FRAME [100%]			

BLDG COMMENTS	26 SOLAR PANELS (EST)
---------------	-----------------------

G

YEAR BLT	1969	SIZE ADJ	1.000	ELEMENT	CD	DESCRIPTION	ADJ	S	BAT	T	DESCRIPTION	UNITS	YB	ADJ PRICE	RCN	TOTAL RCN	296.066											
NET AREA	1,020	DETAIL ADJ	1.000	FOUNDATION	4	FLR & WALL	1.00	A	LLU	N	LOWER LEVEL UNF	612		78.48	48,029	<table border="1"> <tr> <th>CONDITION ELEM</th> <th>CD</th> </tr> <tr> <td>EXTERIOR</td> <td>A</td> </tr> <tr> <td>INTERIOR</td> <td>A</td> </tr> <tr> <td>KITCHEN</td> <td>A</td> </tr> <tr> <td>BATHS</td> <td>A</td> </tr> <tr> <td>HEAT/ELEC</td> <td>A</td> </tr> </table>	CONDITION ELEM	CD	EXTERIOR	A	INTERIOR	A	KITCHEN	A	BATHS	A	HEAT/ELEC	A
CONDITION ELEM	CD																											
EXTERIOR	A																											
INTERIOR	A																											
KITCHEN	A																											
BATHS	A																											
HEAT/ELEC	A																											
\$NLA(RCN)	\$290	OVERALL	0.910	EXT COVER	1	WD SHINGLE	1.00	A	LLF	L	LOWER LEVEL FIN	204	1969	128.75	26,264													
<b>CAPACITY</b>				ROOF SHAPE	1	GABLE	1.00	A	BAS	L	BASE AREA	816	1969	251.23	205,006													
STORIES	1	ADJ	1.00	ROOF COVER	1	ASPH/CMP SH	1.00	B	OPA	N	OPEN PORCH	28		45.50	1,274													
ROOMS	4		1.00	FLOOR COVER	2	SOFTWOOD	1.00	C	WDK	N	WOOD DECK	140		35.67	4,994													
BEDROOMS	3		1.00	INT FINISH	2	DRYWALL	1.00		F11	O	FPL 1S 1OP	1		6,949.70	6,950													
BATHROOMS	1		1.00	HEATING/COOL	15	HTWT+DCTLS AC	1.01																					
FIXTURES	3		\$3,549	FUEL SOURCE	1	OIL	1.00																					
GARAGE SPACES	0		1.00																									
% BSMT FIN	0		1.00																									
# 1/2 BATHS	0		1.00																									
# OF UNITS	1		1.00																									

EFF.YR/AGE	1969 / 54
COND	32 32 %
FUNC	0
ECON	0
DEPR	32 % GD 68
RCNLD	\$201,300