

Key: 7835

Town of BREWSTER - Fiscal Year 2025

9/17/2024 2:15 pm SEQ #: 8.063

LEG
A
L
L
A
N
D

CURRENT OWNER				PARCEL ID				LOCATION			
MARANTO SAMUEL J & JOYCE R 67 EAST STREET ANNAPOLIS, MD 21401				96-28-0				27 BEACH ROSE LANE			
TRANSFER HISTORY				DOS	T	SALE PRICE	BK-PG (Cert)				
MARANTO SAMUEL J & JOYCE				10/30/2020	QS	610,000	33424-44				
VAN ORSDELL HOLLY				09/10/2018	QS	370,000	31519-127				
GOULD MARIE C TRUSTEE				11/20/2012	F		26872-98				

CLASS	CLASS%	DESCRIPTION			BN ID	BN	CARD	
1010	100	SINGLE FAMILY				1	1 of 1	
PMT NO	PMT DT	TY	DESC	AMOUNT	INSP	BY	1st	%
607	07/28/2022	7	ALTERATIONS	1,855	03/03/2023	TCK	100	100
1038	10/30/2020	16	MLS REVIEW	610,000	03/23/2021	JMG	100	100
	12/07/2018	7	ALTERATIONS	12,750	07/11/2019	TCK	100	100
	09/10/2018	15	SALE REVIEW	370,000	05/29/2019	JMG	100	100
	08/08/2018	5	OTHER		08/08/2018	JMG	100	100

CD	T	AC/SF/UN	Nbhd	St Ind	Infl	ADJ BASE	SAF	Topo	Lpi	VC	CREDIT AMT	ADJ VALUE
100	S	20,000	13	1.00	A	1.00	A	1.00				222,760

TOTAL	20,000 SF	ZONING	RM	FRNT	0	ASSESSED	CURRENT	PREVIOUS
Nbhd	NBHD 13	NOTE (Formerly 304 Beach Plum Lane)	LAND	222,800	210,200			
St Ind	AVERAGE		BUILDING	455,500	430,200			
Infl	AVERAGE		DETACHED	4,300	4,300			
			OTHER	0	0			
TOTAL				682,600	644,700			

TY	QUAL	COND	DIM/NOTE	YB	UNITS	ADJ PRICE	RCNLD
SHF	+	1.10	20 0.80 8X13		128	23.53	2,400
SHF	A	1.00	10 0.90 8X12		96	22.01	1,900



BUILDING	CD	ADJ	DESC	MEASURE	8/8/2018	JMG
MODEL	1		RESIDENTIAL	LIST	8/8/2018	JMG
STYLE	3	0.95	SPLIT LEVEL [100%]	REVIEW	3/30/2023	EMZ
QUALITY	A	1.00	AVG [100%]			
FRAME	1	1.00	WD FRAME [100%]			

BLDG COMMENTS
IN-LAW APT

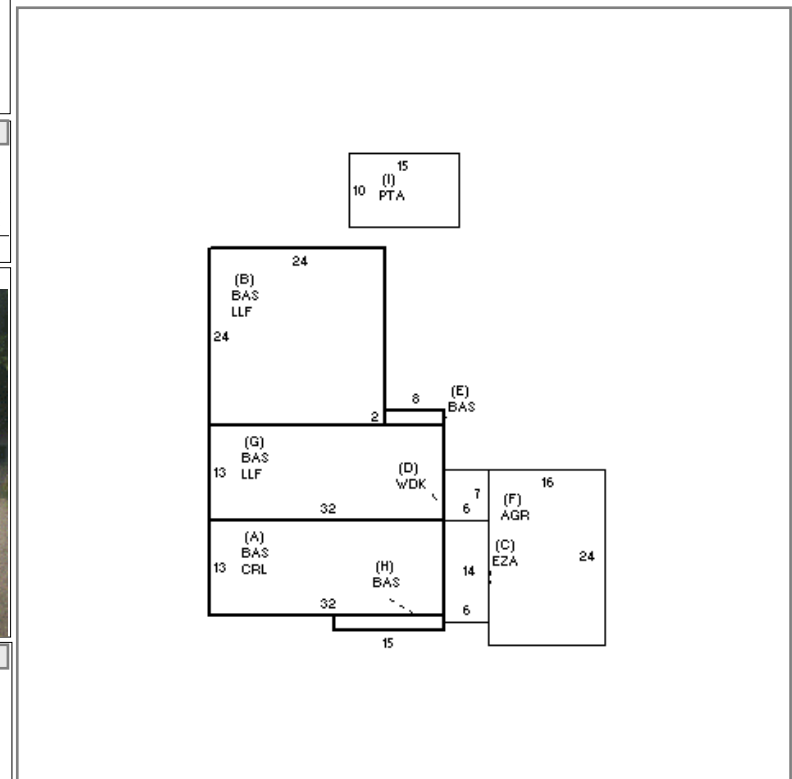

D
E
T
A
C
H
E
D

B
U
I
L
D
I
N
G

YEAR BLT	1969	SIZE ADJ	1.000	ELEMENT	CD	DESCRIPTION	ADJ	S	BAT	T	DESCRIPTION	UNITS	YB	ADJ PRICE	RCN	TOTAL RCN	511,768
NET AREA	2,446	DETAIL ADJ	1.000	FOUNDATION	4	FLR & WALL	1.00	A	CRL	N	BSMT CRAWL	416		28.85	12,000	CONDITION ELEM	CD
\$NLA(RCN)	\$209	OVERALL	0.950	EXT COVER	1	WD SHINGLE	1.00	B	LLF	L	LOWER LEVEL FIN	576	1999	120.97	69,676	EXTERIOR	G
				ROOF SHAPE	1	GABLE	1.00	B	BAS	L	BASE AREA	576	1999	229.49	132,187	INTERIOR	V
				ROOF COVER	1	ASPH/CMP SH	1.00	C	EZA	N	ENCL BREEZEWAY	84		80.18	6,736	KITCHEN	V
				FLOOR COVER	1	HARDWOOD	1.00	D	WDK	N	WOOD DECK	42		37.23	1,564	BATHS	V
				INT FINISH	2	DRYWALL	1.00	+	BAS	L	BASE AREA	878	1969	229.49	201,493	HEAT/ELEC	A
				HEATING/COOL	2	HOT WATER	1.00	F	AGR	N	ATT GARAGE	384		39.31	15,094		
				FUEL SOURCE	1	OIL	1.00	G	LLF	L	LOWER LEVEL FIN	416	1969	120.97	50,322		
								I	PTA	N	PATIO	150		15.11	2,266		
								F11	O	FPL 1S 1OP	1		7,255.20	7,255			
								KIT	O	XTRA KITCHEN	1		2,061.50	2,062			

EFF.YR/AGE	2011 / 12
COND	11 11 %
FUNC	0
ECON	0
DEPR	11 % GD 89
RCNLD	\$455,500