

Key: 8189

Town of BREWSTER - Fiscal Year 2025

9/17/2024 2:15 pm SEQ #: 8.424

LEGALS AND

Table with columns: CURRENT OWNER, PARCEL ID, LOCATION, TRANSFER HISTORY, DOS, T, SALE PRICE, BK-PG (Cert). Includes owner info for LONG PETER L & MARCEY L TRUSTEES and transfer history for CONNELLY JAMIE TRUSTEE.

Table with columns: CLASS, CLASS%, DESCRIPTION, BN ID, BN, CARD. Includes payment history for alterations and out building.

Table with columns: CD, T, AC/SF/UN, Nbhd, St Ind, Infl, ADJ BASE, SAF, Topo, Lpi, VC, CREDIT AMT, ADJ VALUE. Includes totals for assessed, current, and previous values.

Table with columns: TY, QUAL, COND, DIM/NOTE, YB, UNITS, ADJ PRICE, RCNLD. Includes property details for SHF and PTD types.

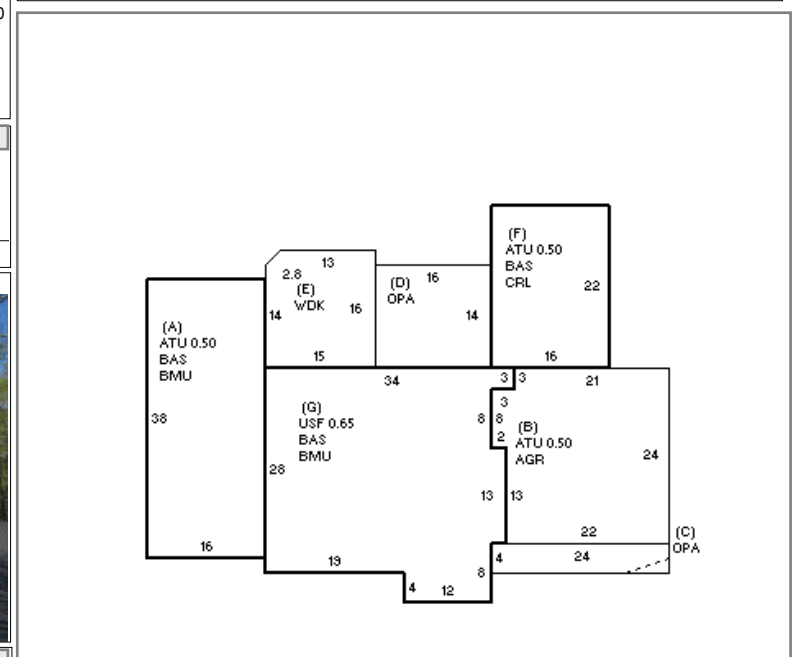

Table with columns: BUILDING, CD, ADJ, DESC, MEASURE, 10/22/2020, TCK. Includes building model, style, quality, and frame details.

BLDG COMMENTS: INFO @ DOOR 10/22/20

DETACHED

BUILDING

Large table with columns: YEAR BLT, SIZE ADJ, ELEMENT, CD, DESCRIPTION, ADJ, S, BAT, T, DESCRIPTION, UNITS, YB, ADJ PRICE, RCN, TOTAL RCN, CONDITION ELEM, CD. Includes capacity table and detailed building element breakdown.