

Key: 8250

Town of BREWSTER - Fiscal Year 2025

9/17/2024 2:15 pm SEQ #: 8.487

LEGAL

LAND

DETACHED

BUILDING

CURRENT OWNER		PARCEL ID	LOCATION			
BEAULIEU KENNETH L 57 KATHERINES LANE BREWSTER, MA 02631		93-47-0	57-55 KATHERINES LANE			
TRANSFER HISTORY		DOS	T	SALE PRICE	BK-PG (Cert)	

CLASS	CLASS%	DESCRIPTION			BN ID	BN	CARD	
1090	100	MULTIPLE HSES			55	2	2 of 2	
PMT NO	PMT DT	TY	DESC	AMOUNT	INSP	BY	1st	%

CD	T	AC/SF/UN	Nbhd	St Ind	Infl	ADJ BASE	SAF	Topo	Lpi	VC	CREDIT AMT	ADJ VALUE

TOTAL	ZONING	FRNT	ASSESSED	CURRENT	PREVIOUS
Nbhd	NOTE		LAND	120,500	
St Ind		BUILDING			
Infl		DETACHED			
		OTHER			
			TOTAL		

TY	QUAL	COND	DIM/NOTE	YB	UNITS	ADJ PRICE	RCNLD



BLDG COMMENTS
 GARAGE/W APT ABOVE -- House # is 55 per Jen at FD 8/17/04. New dwelling should be #57 INFO @ DOOR (2/12/21)

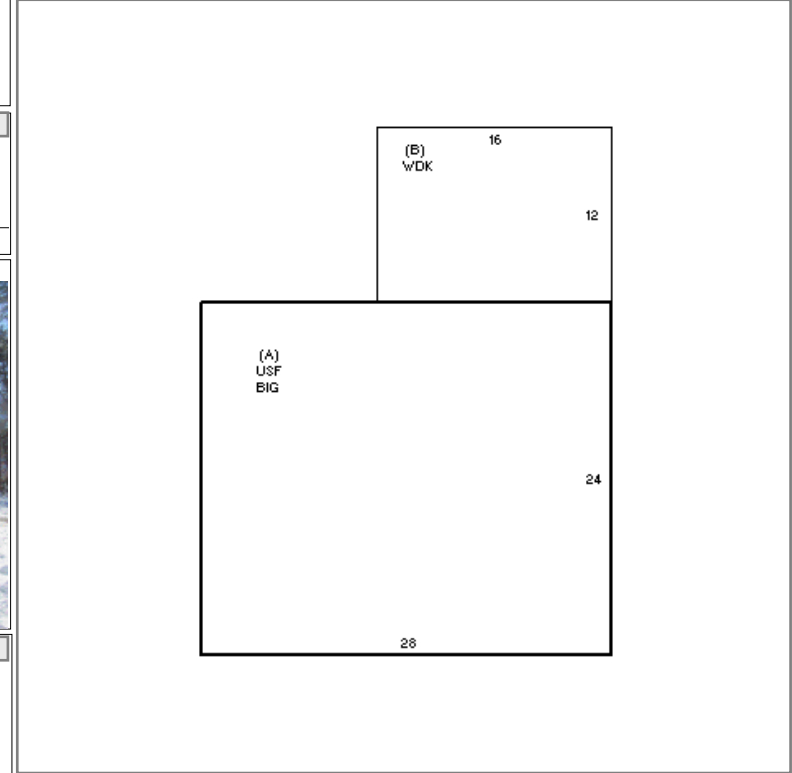

BUILDING	CD	ADJ	DESC	MEASURE	2/12/2021	TCK
MODEL	1		RESIDENTIAL	LIST	2/12/2021	EST
STYLE	17	0.90	GAR/QTRS [100%]	REVIEW	3/18/2021	MR
QUALITY	A	1.00	AVG [100%]			
FRAME	1	1.00	WD FRAME [100%]			

YEAR BLT	1998	SIZE ADJ	1.000	ELEMENT	CD	DESCRIPTION	ADJ	S	BAT	T	DESCRIPTION	UNITS	YB	ADJ PRICE	RCN
NET AREA	672	DETAIL ADJ	1.000	FOUNDATION	2	SLAB	0.95	A	BIG	N	BUILT-IN GARAGE	672		41.85	28,124
\$NLA(RCN)	\$219	OVERALL	0.880	EXT COVER	2	CLAPBOARD	1.00	A	USF	L	UPPER STORY FIN	672	1998	161.79	108,721
CAPACITY		UNITS	ADJ	ROOF SHAPE	1	GABLE	1.00	B	WDK	N	WOOD DECK	192		34.49	6,623
STORIES	1	1.00		ROOF COVER	1	ASPH/CMP SH	1.00								
ROOMS	3	1.00		FLOOR COVER	3	W/W CARPET	1.00								
BEDROOMS	1	1.00		INT FINISH	2	DRYWALL	1.00								
BATHROOMS	1	1.00		HEATING/COOL	9	WARM/CL AIR	1.03								
FIXTURES	3	\$3,432		FUEL SOURCE	1	OIL	1.00								
GARAGE SPACES	2	1.00													
% BSMT FIN	0	1.00													
# 1/2 BATHS	0	1.00													
# OF UNITS	1	1.00													

TOTAL RCN	146,899	
CONDITION ELEM	CD	
EXTERIOR	A	
INTERIOR	A	
KITCHEN	A	
BATHS	A	
HEAT/ELEC	A	
EFF.YR/AGE	1998 / 25	
COND	18	18 %
FUNC	0	
ECON	0	
DEPR	18	% GD 82
RCNLD	\$120,500	